



Blenheim Road, Harrow

£299,950 Share of Freehold

This one-bedroom ground floor flat offers spacious living. The property features its own rear garden and off-street parking for two cars at the front. It comes with a share of the freehold and a long lease of 999 years. This home is in good condition and is available with no upper chain, ensuring a straightforward purchase. Additionally, it is just a few minutes' walk to the Metropolitan Line train station at West Harrow, making it ideal for commuters. Perfect for first-time buyers, downsizers, or investors.

**EPC Rating: D
Council Tax Band: C**

- Ground Floor Flat • One Bedroom • Modern Fitted Kitchen • Gas Central Heating System • Double Glazed Windows • Own Rear Garden • Off Street Parking • Share Of Freehold • Close To Met Line • No Upper Chain



Blenheim Road, Harrow

£299,950 Share of Freehold

FURTHER DETAILS

A private front door leads into an entrance hall. From here access is provided to the reception room, bedroom and kitchen, from where there is access to the bathroom. To the outside there is off street parking for two cars to the front and a garden to the rear.

LOCATION

Blenheim Road is a short walk to the Metropolitan Line train station at West Harrow and also within a short walk of Vaughan Primary school. Excellent shopping facilities are easily accessible at Harrow's town centre or North Harrow and West Harrow Recreation Ground is also close by.

LEASE DETAILS

The flat is to be sold with a new lease of 999 years and a share of the freehold.

FREE MARKET APPRAISAL

Please contact our Harrow Office if we can be of assistance with the sale or rental of your current property.

CONTACT RAWLINSON GOLD

If you would like to arrange a viewing or discuss any aspect of this property, please contact our Harrow Office on 020 8861 2020 or by email at harrow@rawlinsongold.co.uk



rawlinson gold **rg**
ESTATE AGENTS
Est. 1994



rawlinson gold **rg**
ESTATE AGENTS
Est. 1994



rawlinson gold **rg**
ESTATE AGENTS
Est. 1994



rawlinson gold **rg**
ESTATE AGENTS
Est. 1994



rawlinson gold **rg**
ESTATE AGENTS
Est. 1994

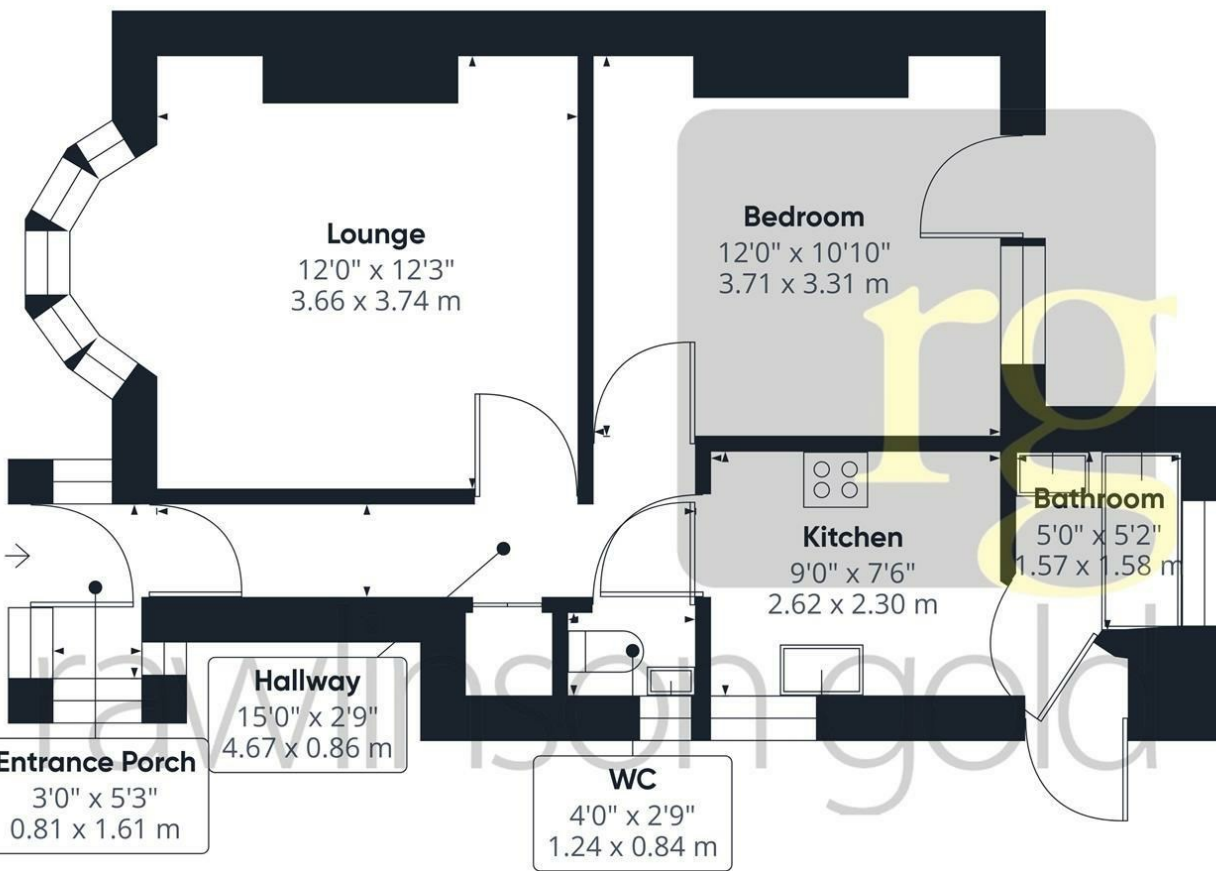

Approximate total area⁽¹⁾
 471.35 ft²
 43.79 m²

(1) Excluding balconies and terraces

While every attempt has been made to ensure accuracy, all measurements are approximate, not to scale. This floor plan is for illustrative purposes only.

GIRAFFE360