



**Claremont Road, Wealdstone**

**£550,000 Freehold**

Requiring updating, this semi detached home is perfectly located within half of a mile of Harrow & Wealdstone train station, Whitefriars Primary, Middle and High Schools, Salvatorian College and The Sacred Heart Language College. The accommodation comprises of an entrance porch, hallway, through lounge, kitchen, conservatory and W/C on the ground floor, whilst to the first floor there is a landing, three double bedrooms and a family bathroom. To the front there is a small garden whilst to the rear there is a well-maintained mature garden.

**EPC Rating: F**  
**Council Tax Band: D**

• Semi-Detached Home • Three Double Bedrooms • Through Lounge • Kitchen • Conservatory • Family Bathroom • Additional W/C • In Need of Updating • Transport Links Nearby • Outstanding Schools Nearby



**Claremont Road, Wealdstone**

**£550,000 Freehold**

### **FURTHER DETAILS**

The accommodation comprises of an entrance porch, hallway, through lounge, kitchen, conservatory and w/c on the ground floor, whilst to the first floor there is a landing, three double bedrooms and a family bathroom.

To the front there is a small garden whilst to the rear there is a well-maintained mature garden.

### **LOCATION**

The property is located within a short walk of the comprehensive shopping and transport facilities in Wealdstone including Harrow & Wealdstone train station which has Bakerloo and London Overground trains into London and further afield. Whitefriars Primary, Middle and High Schools, rated Outstanding by OFSTED, are within a short walk as are Salvatorian Roman Catholic College and The Sacred Heart Language College.

### **FREE MARKET APPRAISAL**

Please contact our Harrow Office if we can be of assistance with the sale or rental of your current property.

### **CONTACT RAWLINSON GOLD**

If you would like to arrange a viewing or discuss any aspect of this property, please contact our Harrow Office by telephone on 020 8861 2020 or by email at [harrow@rawlinsongold.co.uk](mailto:harrow@rawlinsongold.co.uk).





Ground Floor

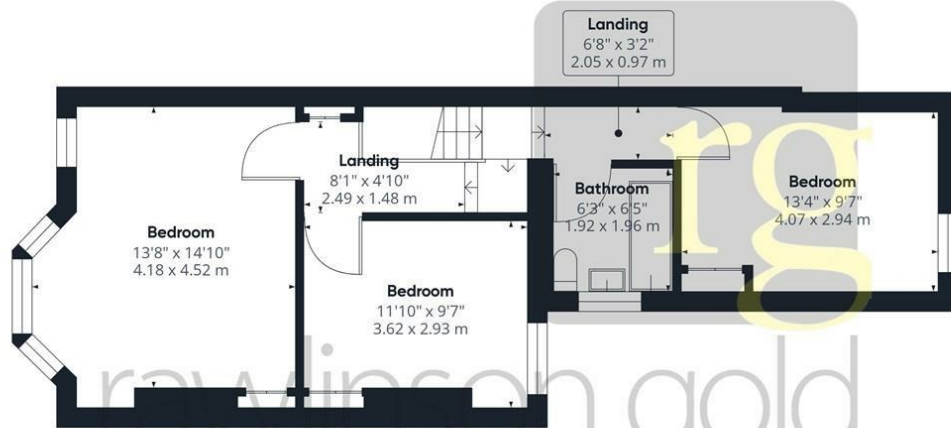

Floor 1

**Approximate total area<sup>(1)</sup>**  
 1198.1 ft<sup>2</sup>  
 111.31 m<sup>2</sup>

(1) Excluding balconies and terraces

While every attempt has been made to ensure accuracy, all measurements are approximate, not to scale. This floor plan is for illustrative purposes only.

GIRAFFE360