



Hide Road, Harrow

£550,000 Freehold

A lovely two bedroom, two bathroom family home, located in a popular and sought after residential location that is convenient for both shopping and transport links into London. To be sold with no upper chain, the property benefits from a gas central heating system and double glazed windows, as well as ample opportunity to be improved and extended, subject to the usual consents. Outside of the property there is off street parking to the front and a large garden to the rear.

**EPC Rating: D
Council Tax Band: D**

- Chain Free • Semi-Detached Family Home • Two Well Proportioned Bedrooms • Two Contemporary Style Bathrooms • Through Lounge • Modern Kitchen • Double Glazed Windows • Gas Central Heating System • Off-Street Parking • Large Rear Garden



Hide Road, Harrow

£550,000 Freehold

FURTHER DETAILS

The accommodation comprises of an entrance hall, through-lounge, kitchen and bathroom on the ground floor, whilst to the first floor there are two well proportioned bedrooms and a shower-room. Outside there is off street parking to the front and a large garden to the rear.

LOCATION

Hide Road is located within one mile of Harrow's town centre and also within walking distance of both Headstone Manor Park and Harrow Recreation Park and three quarters of a mile from Wealdstone's High Street. This means that within walking distance are Metropolitan, Bakerloo, London Overground and National Rail train services, with London Euston reachable in under 30 minutes. Also within walking distance are several schools rated by Ofsted as outstanding, including Nower Hill High School and Marlborough Primary School.

FREE MARKET APPRAISAL

Please contact our Harrow Office if we can be of assistance with the sale or rental of your current property.

CONTACT RAWLINSON GOLD

If you would like to arrange a viewing or discuss any aspect of this property, please contact our Harrow Office by telephone on 020 8861 2020 or by email at harrow@rawlinsongold.co.uk.



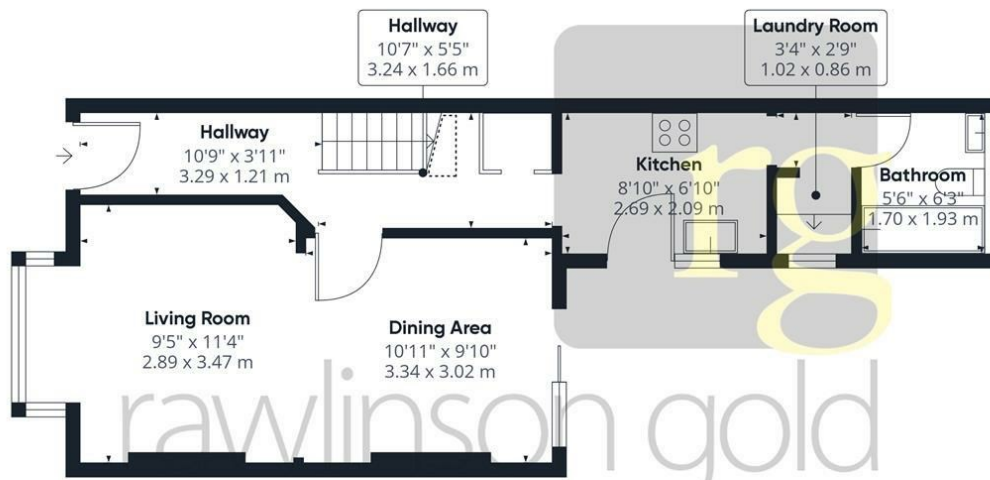

Ground Floor

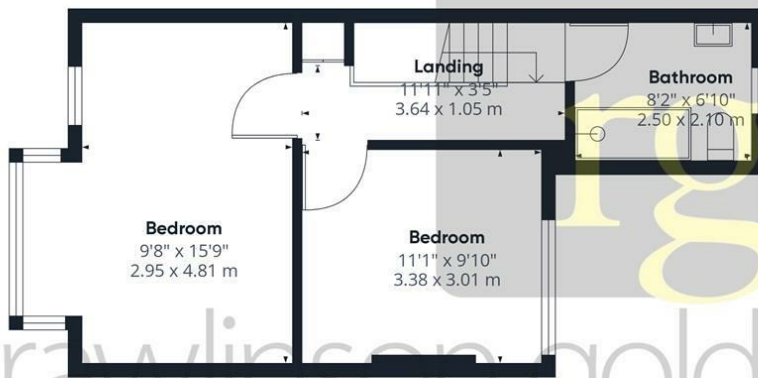

Floor 1

Approximate total area⁽¹⁾

850.27 ft²
78.99 m²

Reduced headroom

1.81 ft²
0.17 m²

(1) Excluding balconies and terraces

Reduced headroom
(below 1.5m/4.92ft)

While every attempt has been made to ensure accuracy, all measurements are approximate, not to scale. This floor plan is for illustrative purposes only.

GIRAFFE360