



Hereford Court, Danes Gate, Harrow £300,000 Leasehold

This two bedroom second floor purpose built flat is to be sold with the benefit of a newly extended lease upon completion. It is conveniently situated with easy access to Harrow & Wealdstone's Bakerloo and London Overground station, as well as Harrow's town centre, with its comprehensive selection of shopping, dining, leisure and transport facilities.

This flat would make an ideal purchase for a first time or investment buyer and an internal viewing is highly recommended.

**EPC Rating: D
Council Tax Band: B**

- To Be Sold With A Newly Extended Lease on Completion • Two Bedroom Purpose Built Flat • Second Floor • Reception Room • Kitchen • Bathroom • Gas Central Heating System • Double Glazed Windows • Communal Gardens • Local To Transport Facilities And Amenities**



Hereford Court, Danes Gate, Harrow

£300,000 Leasehold

FURTHER DETAILS

The accommodation resides on the second floor and all floors are accessed via stairs. Internally, the property comprises of an entrance hall, reception room, kitchen, two good-size bedrooms and a family bathroom. Externally there are communal gardens to the side and rear of the building.

LOCATION

Danes Gate is a no through road located off Headstone Drive. This location provides ease of access to many local amenities including bus routes, train stations, shopping facilities, local schools and green spaces. Harrow & Wealdstone Station is located 0.4 miles away which provides train routes on the Bakerloo Underground and London Overground Lines.

LEASE DETAILS

To be sold with a newly extended lease on completion. Quarterly service charge from 25/12/2023 to 24/03/2024 is £467.00

CONTACT RAWLINSON GOLD

If you would like to arrange a viewing or discuss any aspect of this property, please contact our Harrow Office on 020 8861 2020 or by email at harrow@rawlinsongold.co.uk



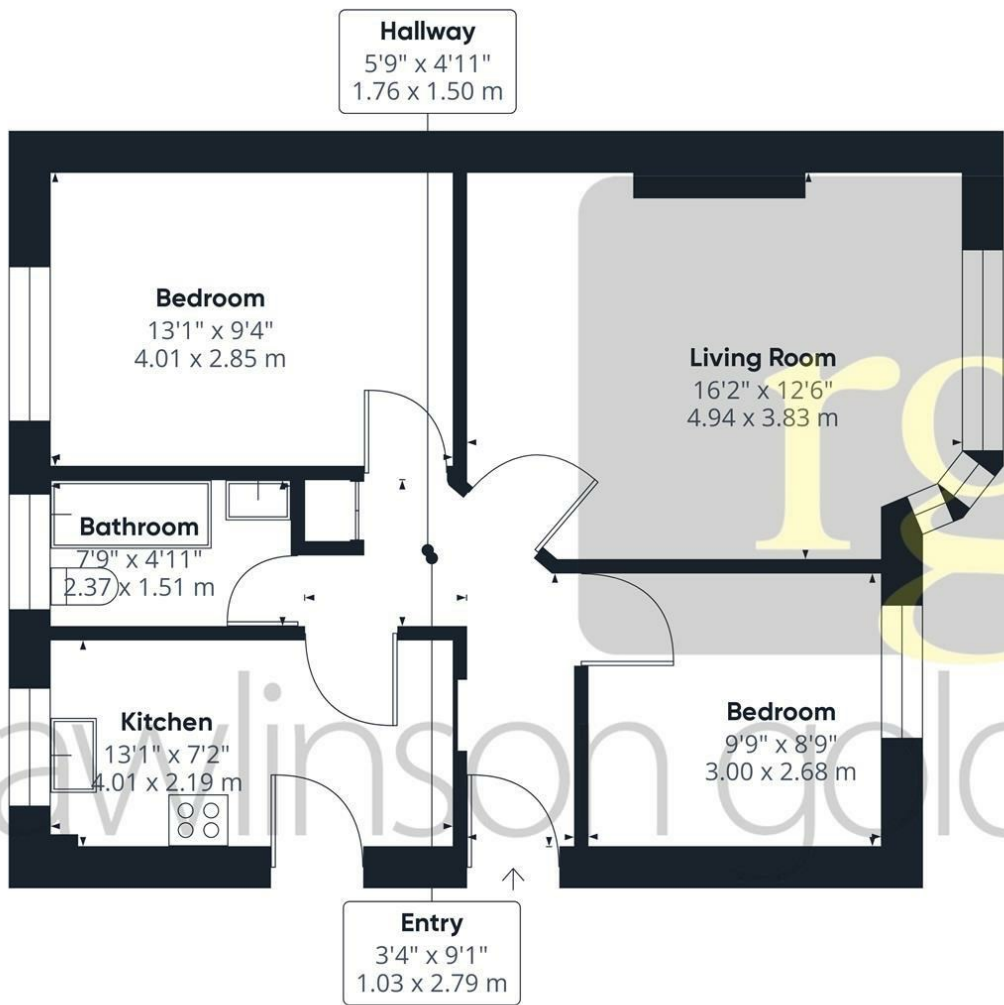

Approximate total area[®]
597.14 ft²
55.48 m²

Excluding balconies and terraces

While every attempt has been made to ensure accuracy, all measurements are approximate, not to scale. This floor plan is for illustrative purposes only.

GIRAFFE360