



Redleaf Close, Belvedere, Kent **Guide £415,000**







Redleaf Close, Belvedere, Kent

Guide £415,000

Property Description

Your Move are excited to present this lovely and spacious two bedroom Bungalow. The property have a large hall which is immediately noticeable upon entry. Both bedrooms are located towards the front of the property, are of a generous size easily able to host a double bed and plenty of storage. the lounge/ dining room is of a good size and has french doors at the back leading to the large garden. The whole house has a modern aesthetic this is most prominent in the kitchen and family bathroom.

Our View

This is detached bungalow is in an idyllic location, and is of a great size being well suited for pretty much anyone. With parking for 4 cars and fantastic transport links it really is worth a look.

Location

The Property Is located remarkably close to the ever popular Nuxley Village. Giving the property excellent transport links to a variety of destinations. Whether that be London, Bexleyheath, Bluewater and much much more! The property is also very close to some local shops and The Great Harry Public House.



EPC Grade D
For full EPC please contact the branch

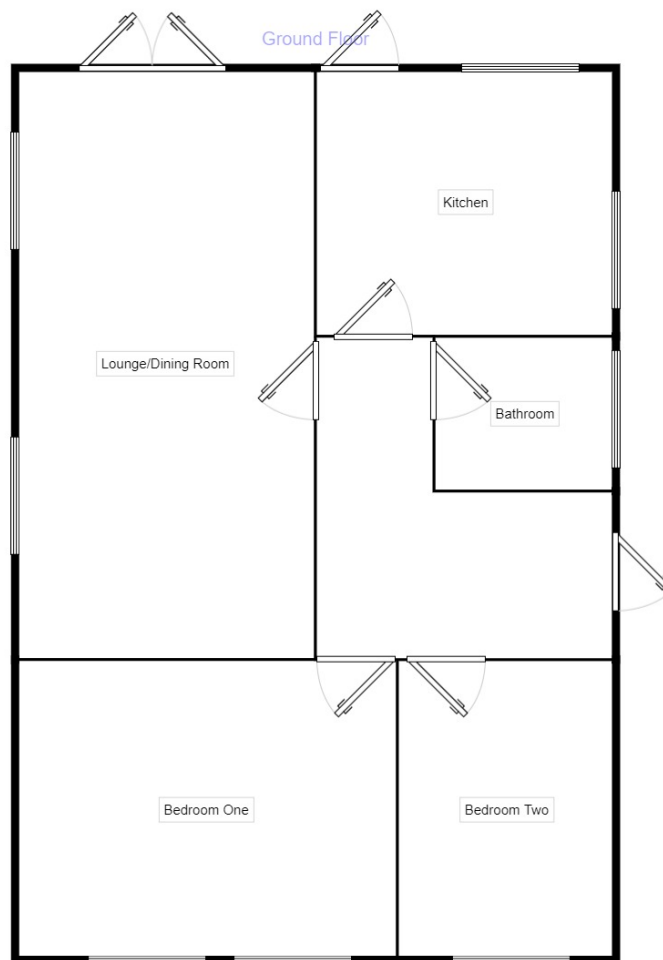

Measurements are approximate. Not to scale. For illustrative purposes only.

IMPORTANT NOTE TO PURCHASERS: We endeavour to make our sales particulars accurate and reliable, however, they do not constitute or form part of an offer or any contract and none is to be relied upon as statements of representation or fact. The services, systems and appliances listed in this specification have not been tested by us and no guarantee as to their operating ability or efficiency is given. All measurements have been taken as guide to prospective buyers only, and are not precise. Floor plans where included are not to scale and accuracy is not guaranteed. If you require clarification or further information on any points, please contact us, especially if you are travelling some distance to view. Fixtures and fittings other than those mentioned are to be agreed with the seller.

The Your Move branch is operated by National Home Move Limited which is independently owned and operated under a licence from your-move.co.uk Limited. National Home Move Limited is registered in England and Wales with company number 11805074, registered office: 5 Brooklands Place, Brookland Road, Sale, United Kingdom, M33 3SD. VAT Reg No: 315255523.

*Calls may be recorded and/or monitored for training and/or security purposes.

Your Move, 327 Bexley Road, Northumberland
Heath, Erith, Kent, DA8 3EX
01322 336 633 * Northumberlandheath@your-
move.co.uk

