



Daisy Court, Belmont Road, Erith, Kent **Offers Over £235,000**







Daisy Court, Belmont
Road, Erith, Kent

Offers Over £235,000

Property Description

Your Move are excited to present this spacious two bedroom property. This property is double glazed and has a modern aesthetic. The flat consists of a open plan lounge/kitchen with plenty of fitted units and space for furniture. A good sized modern bathroom, and two large double bedrooms which are more than capable of holding a large wardrobe each.

Our View

This property is set in a ideal location, with excellent transport links and close to local amenities. The property is suited for practically anyone whether that be a first time buyer, buy to let investor or anyone in between.

Location

This property is situated only a short walk away from Northumberland Heaths main high street making it idea if you ever need to go to the shops. The property has access to plenty of local transport links with the nearest station being 0.6 miles away!



EPC Grade B
For full EPC please contact the branch

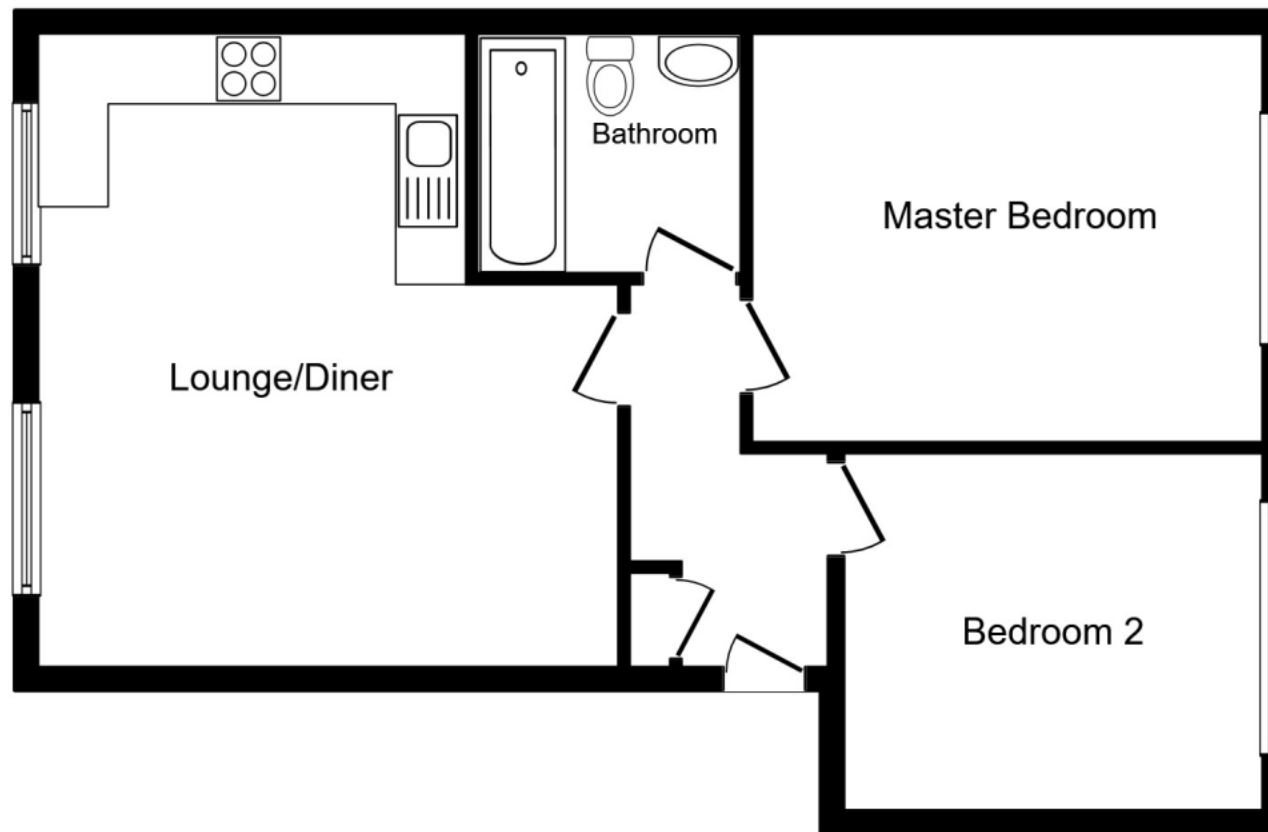

Floor Plan

Total floor area 61.0 sq. m. (657 sq. ft.) approx

This floor plan is for illustrative purposes only. It is not drawn to scale. Any measurements, floor areas (including any total floor area), openings and orientation are approximate. No details are guaranteed, they cannot be relied upon for any purpose and they do not form part of any agreement. No liability is taken for any error, omission or misstatement. A party must rely upon its own inspection(s).

Plan produced for Your Move. Powered by www.focalagent.com

IMPORTANT NOTE TO PURCHASERS: We endeavour to make our sales particulars accurate and reliable, however, they do not constitute or form part of an offer or any contract and none is to be relied upon as statements of representation or fact. The services, systems and appliances listed in this specification have not been tested by us and no guarantee as to their operating ability or efficiency is given. All measurements have been taken as guide to prospective buyers only, and are not precise. Floor plans where included are not to scale and accuracy is not guaranteed. If you require clarification or further information on any points, please contact us, especially if you are travelling some distance to view. Fixtures and fittings other than those mentioned are to be agreed with the seller.

The Your Move branch is operated by National Home Move Limited which is independently owned and operated under a licence from your-move.co.uk Limited. National Home Move Limited is registered in England and Wales with company number 11805074, registered office: 5 Brooklands Place, Brookland Road, Sale, United Kingdom, M33 3SD. VAT Reg No: 315255523.

*Calls may be recorded and/or monitored for training and/or security purposes.

Your Move, 327 Bexley Road, Northumberland
Heath, Erith, Kent, DA8 3EX

01322 336 633 * Northumberlandheath@your-move.co.uk



YOUR MOVE