



West Street, Woodford, Kettering, Northamptonshire
£210,000

 **YOUR MOVE**
Hobin Roberts



IMPORTANT NOTE TO PURCHASERS: We endeavour to make our sales particulars accurate and reliable, however, they do not constitute or form part of an offer or any contract and none is to be relied upon as statements of representation or fact. The services, systems and appliances listed in this specification have not been tested by us and no guarantee as to their operating ability or efficiency is given. All measurements have been taken as guide to prospective buyers only, and are not precise. Floor plans where included are not to scale and accuracy is not guaranteed. If you require clarification or further information on any points, please contact us, especially if you are travelling some distance to view. Fixtures and fittings other than those mentioned are to be agreed with the seller.



Description

**** 360 VIRTUAL TOUR AVAILABLE TO VIEW ** ATTENTION BUY-TO-LET LANDLORDS!!** Situated in the sought after village of Woodford is this three bedroom mid terrace property which has been refurbished to an excellent standard by the current owner and is available to purchase with tenants in-situ. Entered at the front via a hardwood glazed door into the entrance hall, you will find stairs rising to the first floor and access to the spacious, naturally light lounge/dining room which benefits from two double glazed windows to the front aspect. Off the lounge, is the kitchen/dining room which has been refitted with a range of modern units and integrated cooking facilities and provides access to a useful cupboard and to the rear garden. Upstairs, there are three bedrooms, two of which are doubles and there is a family bathroom which is fitted with a modern white suite. Outside, there are good sized lawned gardens to the front and rear which can also be accessed via a passageway at the side.

Council Tax

Band B

EPC

360 VIRTUAL TOUR AVAILABLE
For full EPC please contact the branch.

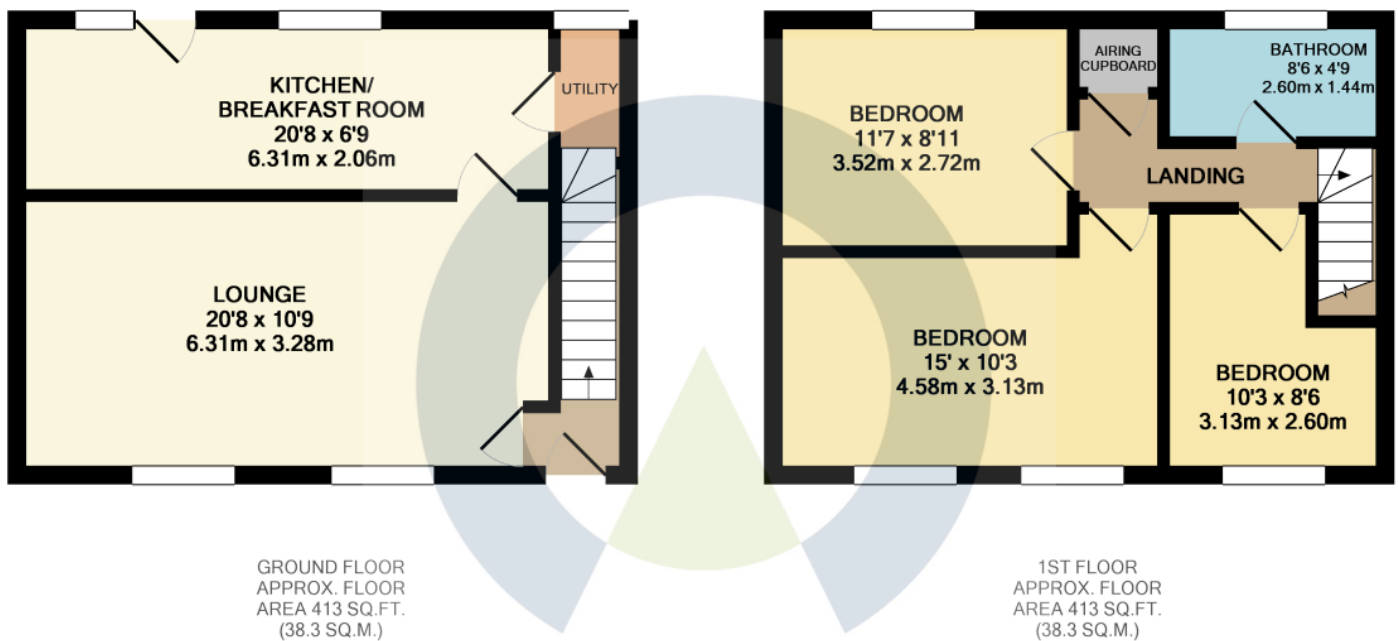

Whilst every attempt has been made to ensure the accuracy of the floor plan contained here, measurements of doors, windows, rooms and any other items are approximate and no responsibility is taken for any error, omission, or mis-statement. This plan is for illustrative purposes only and should be used as such by any prospective purchaser. The services, systems and appliances shown have not been tested and no guarantee as to their operability or efficiency can be given
Made with Metropix ©2018

10 Silver Street, Kettering, Northamptonshire, NN16 0BN
01536 411333 * Kettering@your-move.co.uk

 **YOUR MOVE**
Hobin Roberts
your-move.co.uk