



Glendale Drive, Stechford, Birmingham
Offers Invited - Based On £200,000



YOUR MOVE

Murray Rogers

Description

This well presented three bedroom mid terraced is situated within a popular residential area of Stechford. It has access to local facilities including Stechford train station, shops and bus routes. The accommodation comprises: Entrance porch, Entrance hall, Modern kitchen, Through lounge dining room, three bedrooms and an upstairs bathroom. Outside the property is approached via a paved path and lawned fore garden and to the rear there is an enclosed well manicured garden. This is a must view home. EPC rating

Council Tax

EPC

Mid Town House

For full EPC please contact the branch.

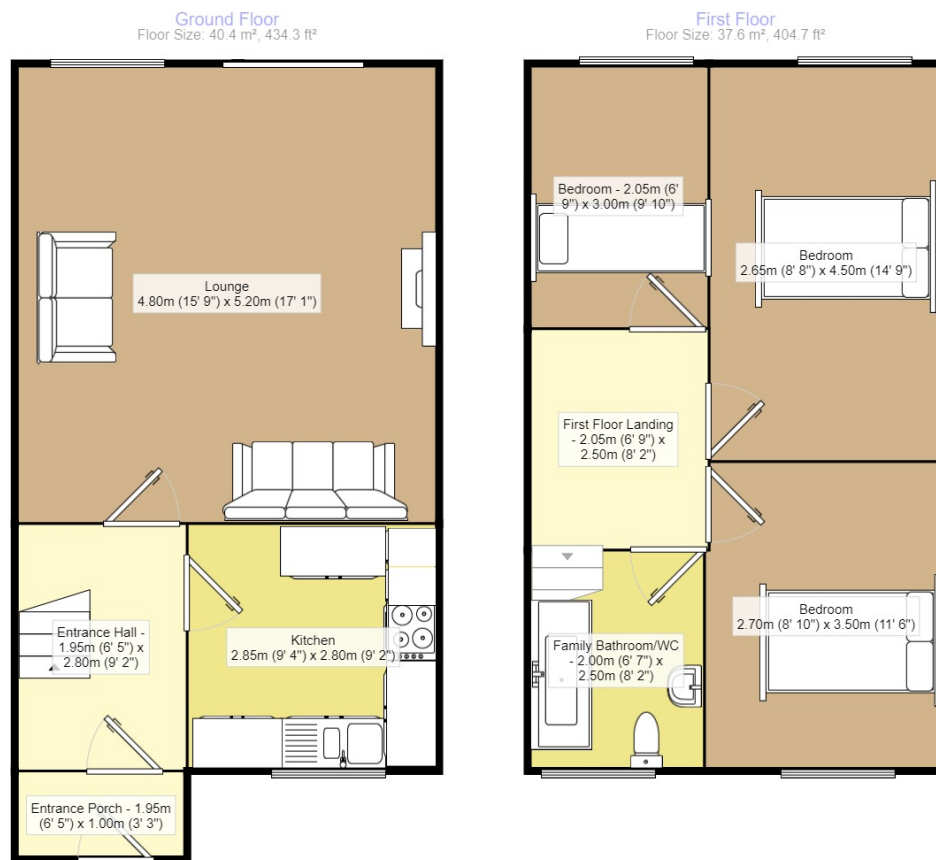

Measurements are approximate. Not to scale. For illustrative purposes only.

165 Station Road, Stechford, Birmingham, B33 8BA

0121 784 8444 * Stechford@your-move.co.uk



YOUR MOVE

Murray Rogers

your-move.co.uk

IMPORTANT NOTE TO PURCHASERS: We endeavour to make our sales particulars accurate and reliable, however, they do not constitute or form part of an offer or any contract and none is to be relied upon as statements of representation or fact. The services, systems and appliances listed in this specification have not been tested by us and no guarantee as to their operating ability or efficiency is given. All measurements have been taken as guide to prospective buyers only, and are not precise. Floor plans where included are not to scale and accuracy is not guaranteed. If you require clarification or further information on any points, please contact us, especially if you are travelling