



Gimson Road, Leicester **Auction - Starting Price £270,000**







Gimson Road, Leicester

**Auction - Starting Price
£270,000**



EPC Rating D
For full EPC please contact the branch

Property Description

Your Move are delighted to offer for sale this spacious, three bedroom, semi detached, family house,. The property is sold by modern online auction and is a freehold property with NO CHAIN. The property offers double glazing and gas central heating via a combination boiler. The accommodation briefly comprises of a storm porch, an entrance hall with stairs to the first floor, a ground floor cloakroom with a WC and hand basin. The lounge is large with a bay window overlooking the front of the property and a gas fire with surround. The dining room is large with patio doors leading onto the conservatory, which offers light and power with a ceiling fan. The Kitchen has a range of wall and base units with an integral gas hob and combi gas boiler, with the utility room adjacent. The first floor landing offers a loft hatch with access to a partially boarded roof space with a light. The three bedrooms are large, with the main bedroom having

Our View

This is a good family house or buy to let investment, with good size rooms, on a good size plot. The house offers plenty of parking on the drive as well as a garage. The rear garden is enclosed if you have a young family. With a lounge, dining room, conservatory, kitchen and utility with a cloakroom/WC, and three large bedrooms and a family bathroom this is a great house that wont be on the market long, so we highly recommend that you book a viewing TODAY !!!

Location

Dane Hills is a popular area of Leicester with plenty of local amenities and facilities close by such as, West Gate School, New College, Fosse Medical Centre, Braunstone Park, various places of worship, local shops including

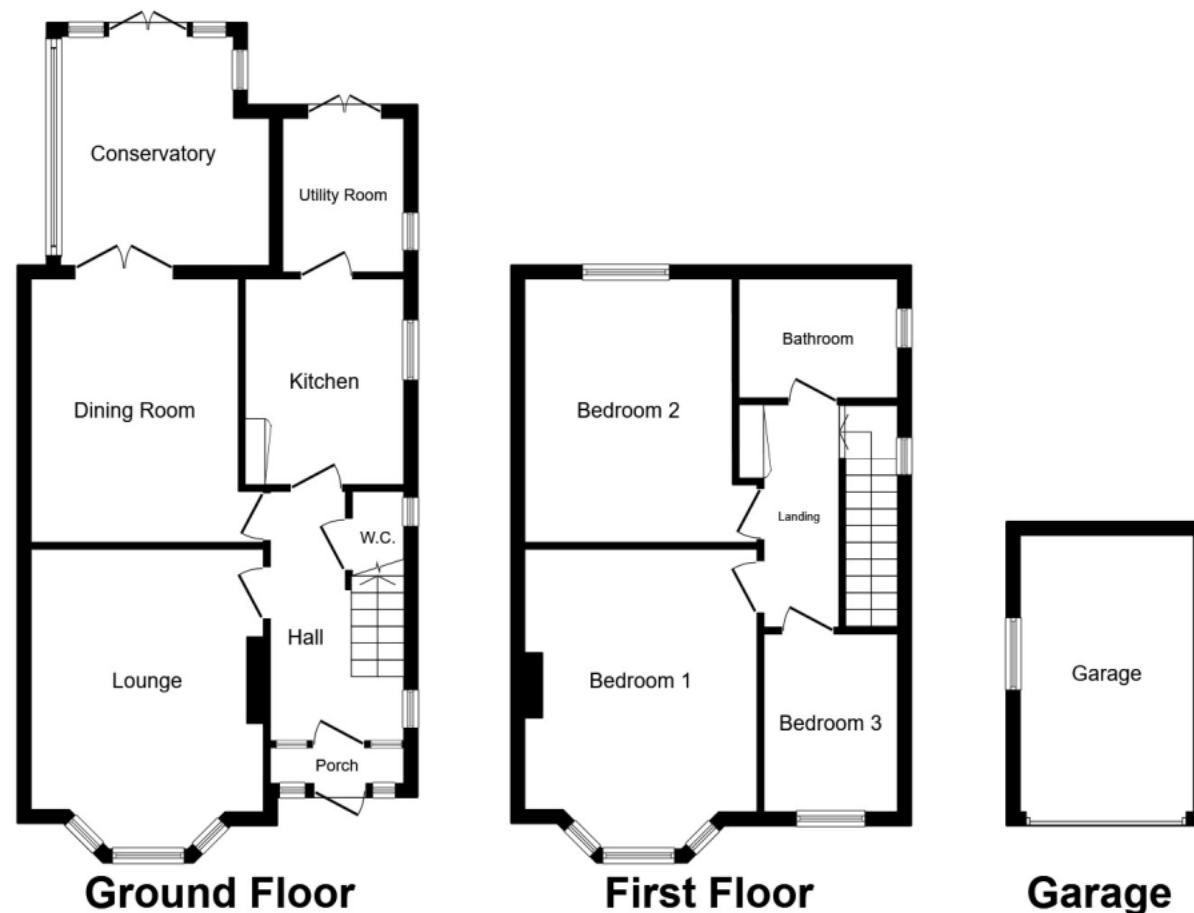

This floor plan is for illustrative purposes only. It is not drawn to scale. Any measurements, floor areas (including any total floor area), openings and orientation are approximate. No details are guaranteed, they cannot be relied upon for any purpose and they do not form part of any agreement. No liability is taken for any error, omission or misstatement. A party must rely upon its own inspection(s).
Plan produced for Your Move. Powered by www.focalagent.com

IMPORTANT NOTE TO PURCHASERS: We endeavour to make our sales particulars accurate and reliable, however, they do not constitute or form part of an offer or any contract and none is to be relied upon as statements of representation or fact. The services, systems and appliances listed in this specification have not been tested by us and no guarantee as to their operating ability or efficiency is given. All measurements have been taken as guide to prospective buyers only, and are not precise. Floor plans where included are not to scale and accuracy is not guaranteed. If you require clarification or further information on any points, please contact us, especially if you are travelling some distance to view. Fixtures and fittings other than those mentioned are to be agreed with the seller.

The Your Move branch is operated by National Home Move Limited which is independently owned and operated under a licence from your-move.co.uk Limited. National Home Move Limited is registered in England and Wales with company number 11805074, registered office: 5 Brooklands Place, Brookland Road, Sale, United Kingdom, M33 3SD. VAT Reg No: 315255523.

*Calls may be recorded and/or monitored for training and/or security purposes.

Halford Street, Leicester, LE1 1JB

0116 2538855 * Leicester@your-move.co.uk

