



Murdoch Rise, Loughborough, Leicestershire    **£240,000**









Murdoch Rise,  
Loughborough,  
Leicestershire

**£240,000**



**Semi Detached Property**  
**For full EPC please contact the branch**

## Property Description

A delightful semi detached property that has been well maintained by the current owners. The property is located in a cul-de-sac with gardens extending to the side, front and rear of the property. The hallway leads into the accommodation with a light lounge/diner spanning from the front to the rear. The well fitted kitchen has a range of wall and base units with integral hob and oven, space for appliances to include washing machine and dishwasher. There is a double glazed windows over looking the garden and door to the side. There are three bedrooms to the first floor. The shower room has a refitted to included a double shower cubicle with fitted sink basin and low level wc. There are tiled walls and window to the rear. A double blocked paved driveway to the front leading to the garage. The garage has up and over door, power and light and personnel door. There is a low maintenance garden to the front and side, gated access to the rear with storage.

## Our View

## Location



**Ground Floor**

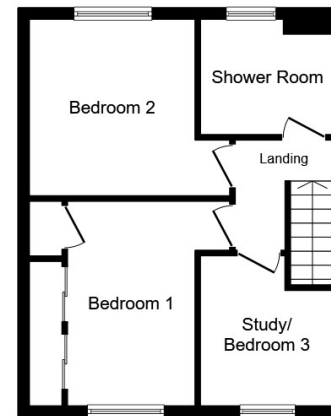

**First Floor**

This floor plan is for illustrative purposes only. It is not drawn to scale. Any measurements, floor areas (including any total floor area), openings and orientation are approximate. No details are guaranteed, they cannot be relied upon for any purpose and they do not form part of any agreement. No liability is taken for any error, omission or misstatement. A party must rely upon its own inspection(s). Plan produced for Your Move. Powered by [www.focalagent.com](http://www.focalagent.com)

**IMPORTANT NOTE TO PURCHASERS:** We endeavour to make our sales particulars accurate and reliable, however, they do not constitute or form part of an offer or any contract and none is to be relied upon as statements of representation or fact. The services, systems and appliances listed in this specification have not been tested by us and no guarantee as to their operating ability or efficiency is given. All measurements have been taken as guide to prospective buyers only, and are not precise. Floor plans where included are not to scale and accuracy is not guaranteed. If you require clarification or further information on any points, please contact us, especially if you are travelling some distance to view. Fixtures and fittings other than those mentioned are to be agreed with the seller.

Our team of highly qualified Mortgage & Financial Consultants can provide you with up to the minute information on many of the rates available. To arrange an appointment, telephone this office. **YOUR HOME MAY BE REPOSSESSED IF YOU DO NOT KEEP UP REPAYMENTS**

The Your Move branch is operated by National Home Move Limited which is independently owned and operated under a licence from [your-move.co.uk](http://your-move.co.uk) Limited. National Home Move Limited is registered in England and Wales with company number 11805074, registered office: 5 Brooklands Place, Brookland Road, Sale, United Kingdom, M33 3SD. VAT Reg No: 315255523.

\*Calls may be recorded and/or monitored for training and/or security purposes.

65/66, Baxter Gate, Loughborough, Leicestershire,  
LE11 1TH

01509 231731 \* [loughborough@your-move.co.uk](mailto:loughborough@your-move.co.uk)

