

Ground Floor

Approx. 35.4 sq. metres (380.8 sq. feet)

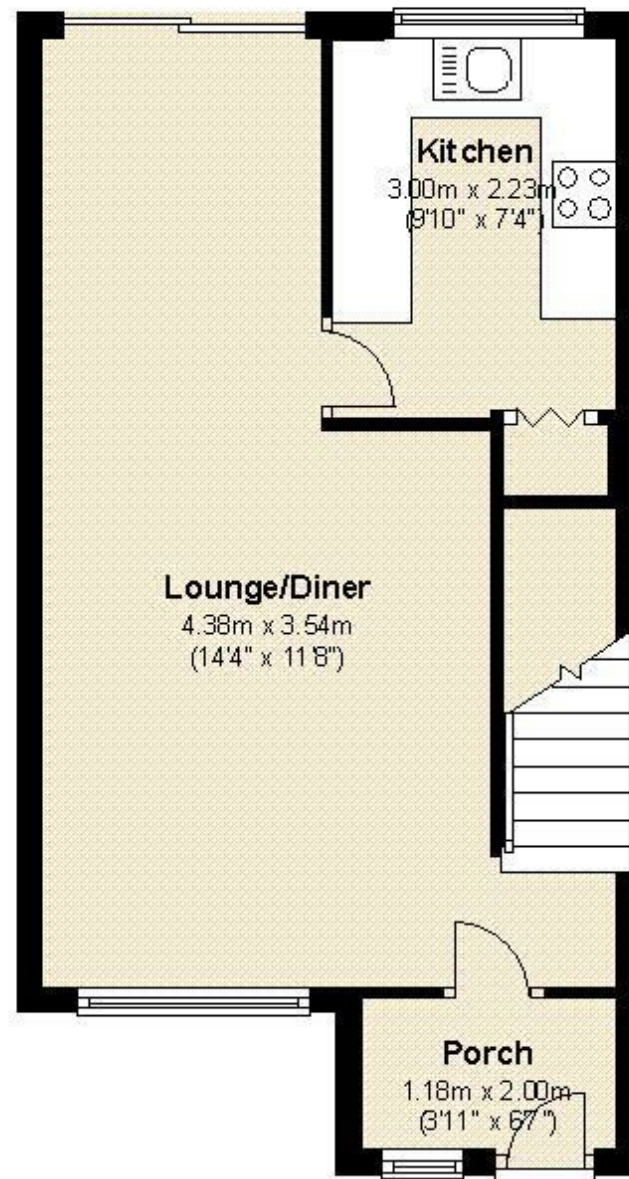

Total area: approx. 67.8 sq. metres (729.4 sq. feet)



Contact

25 Stubbington Green
Fareham
Hampshire
PO14 2JY

E: hello@chambersagency.co.uk

T: 01329665700

<https://www.chambersestateagency.com/>



20
Hawk Close
Stubbington
Fareham
Hampshire
PO14 3SW



01329665700

Stubbington

20 Hawk Close Stubbington Fareham PO14 3SW

£299,950
Freehold

 3
  1
  1
  C

This well presented three bedroom house is situated in a Cul-De-Sac location convenient to the beach, local shops and schools. The accommodation comprises of a lounge/dining room, fitted kitchen, bathroom, rear garden and a garage in a block. The property also benefits from having gas central heating and double glazing. The property is offered with no forward chain! Ideal for first time buyers. Call Chambers today for an internal viewing 01329 665770.

- Porch**
 Front Door into porch with further internal door open to:
- Lounge/Dining Room**
 14' 4 x 11' 8 (4.37m x 3.56m)
 Skimmed ceiling with inset down lights, PVCu double glazed window to front elevation, radiator, carpet as fitted, wall lights, PVCu double glazed patio doors to rear garden.
- Kitchen**
 Skimmed ceiling with inset down lights, PVCu double glazed window to rear aspect, fitted range of wall and base units with chrome door ware including glass display units with lighting. Rolled edge granite effect work surfaces with complimentary tiling above. One and a half bowl stainless steel sink unit with mixer tap, built in Neff oven, inset Neff 4 ring gas hob, extractor fan above, large understair storage cupboard, wall mounted boiler. Laminate flooring.
- First Floor Landing**
 Skimmed ceiling, access to loft void, doors to:
- Bedroom 1**
 14' 4 x 8' 4 (4.37m x 2.54m)
 Skimmed plastered ceiling with inset down lights, PVCu double glazed lead light effect window to front aspect, radiator, carpet as fitted, wall lights, built in three door mirrored wardrobe.
- Bedroom 2**
 9' 9 x 8' 4 (2.97m x 2.54m)
 Skimmed ceiling with inset downlights, UPVC double glazed window to rear aspect, radiator, carpet as fitted.
- Bedroom 3**
 9' 1 x 6' 2 (2.77m x 1.88m)
 Skimmed ceiling with inset downlights, UPVC double glazed window to front aspect, radiator, carpet as fitted, built in cupboard with shelving.
- Bathroom**
 Skimmed ceiling with inset downlights, suite comprising PVC uobscure glazed window to rear aspect, radiator, ceramic tiled flooring, low level WC, panelled bath with mains shower over, pedestal hand wash basin, tiled to principle areas.
- Outside**
 - Front Garden**
 Mainly laid to lawn with shrub borders, pathway to UPVC double glazed front door.
 - Rear Garden**
 A fully enclosed rear garden mainly laid to lawn, path leading to rear gated entrance, patio area.
 - Garage**
 A garage with up and over door located in a near by block in the road.
 - Disclaimer**
 Please note our Photographs show the property pre-tenancy.
 - Hawk Close**
 Standard construction, heating source - Gas central heating. Sewerage - Mains, water supplier - Portsmouth & Southern Water. Council Tax band : C
 Broadband & Mobile coverage unknown you should though satisfy yourself on availability and speeds through <https://checker.ofcom.org.uk/>
 The vendor has experienced no flooding in the past 5 years
 The vendor is not aware of any planning permissions that would impact the property however we strongly advise that you visit the local government website and satisfy yourself <https://www.fareham.gov.uk/casetrackerplanning/applicationsearch.aspx>

