



17 Amy Gardens, Deanfield Close, Hamble,
Southampton, Hampshire, SO31 4JJ.



For more information

01489 570019

www.sbk4homes.com

17 Amy Gardens Deanfield Close,

Hamble, Southampton, SO31 4JJ.

£1,150 PCM

- Modern Ground Floor Apartment
- Two Double Bedrooms
- Spacious Lounge/Dining Room
- Modern Kitchen With Appliances
- En-Suite To Master Bedroom
- Separate Bathroom
- Double Glazing & GCH
- Allocated Parking
- Popular Hamble Location
- Available Immediately



17 Amy Gardens, Deanfield Close, Hamble, Southampton, Hampshire, SO31 4JJ. £1,150
PCM

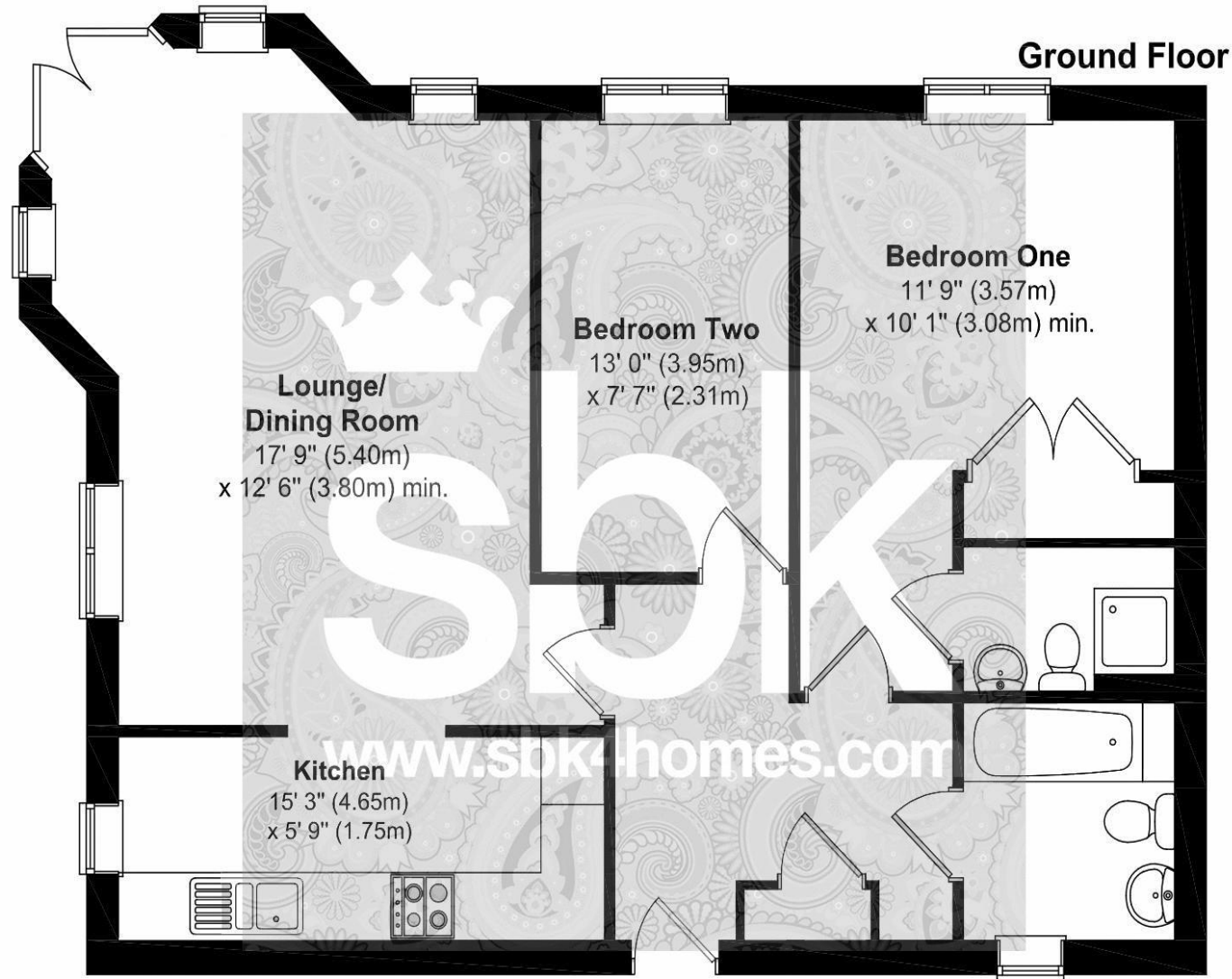

Approx. Gross Internal Floor Area 804 SQ FT 75 SQ Metres

Whilst every attempt has been made to ensure the accuracy of the floor plans, measurements of doors, windows and rooms are approximate and no responsibility is taken for any error, omission or mis-statement. These plans are for representation purposes only and should be used as such. The services, systems and appliances listed in this specification have not been tested by SBK Property Consultants and no guarantee as to their operating efficiency can be given.



ADDITIONAL INFORMATION

Council Tax Band
Band C which is payable to Eastleigh Borough Council.
The current charge for this is £2,046.70 2

Availability Date
The property is available immediately

Length of Let
Initially offered on either a six or twelve month tenancy
but the landlords intentions are for the property to be let
on a long term basis.

Pets
The landlord for this property has specified that pets are
not permitted.

Energy Performance Certificate
The rating for the property is C. To obtain a full report of
the EPC please contact SBK.

Parking
The property has one allocated parking space.



For more information

01489 570019
www.sbk4homes.com