



3 Edgehurst, Locks Heath, Southampton, Hampshire,
SO31 6BE.



For more information

01489 570019

www.sbk4homes.com

3 Edgehurst,

Locks Heath, Southampton, SO31 6BE.

£1,350 PCM

- Modern Detached Bungalow
- Two Good Size Bedrooms
- Quiet Private Location
- Enclosed Rear Garden
- Driveway Parking For One Car
- Unfurnished
- Close To Locks Heath Centre
- Modern Fitted Kitchen
- Available From Mid June
- Long Term Let



3 Edgehurst, Locks Heath, Southampton, Hampshire, SO31 6BE. £1,350 PCM

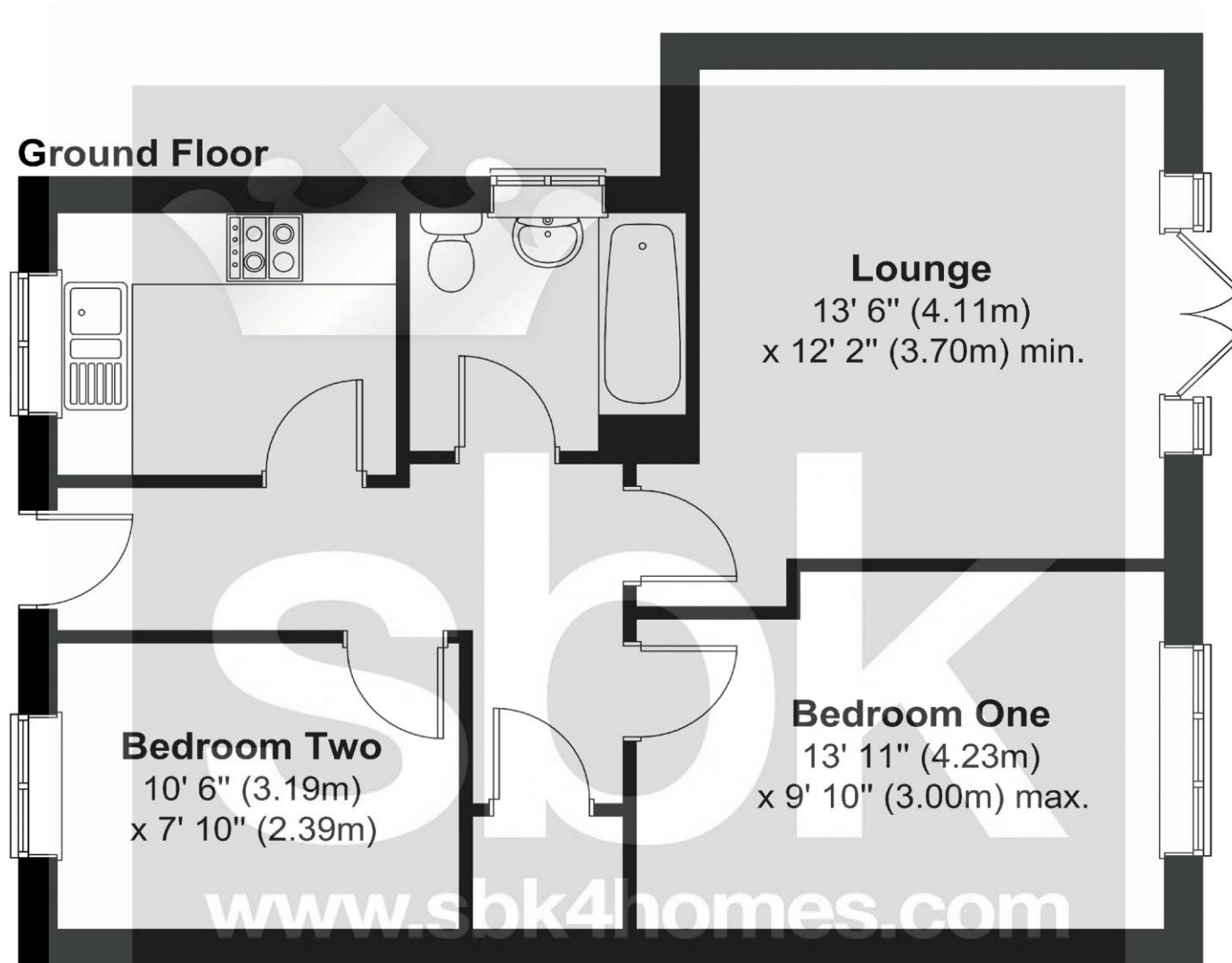

Approx. Gross Internal Floor Area 616 SQ FT 57 SQ Metres

Whilst every attempt has been made to ensure the accuracy of the floor plans, measurements of doors, windows and rooms are approximate and no responsibility is taken for any error, omission or mis-statement. These plans are for representation purposes only and should be used as such. The services, systems and appliances listed in this specification have not been tested by SBK Property Consultants and no guarantee as to their operating efficiency can be given.



ADDITIONAL INFORMATION

Council Tax Band

Band D which is payable to Fareham Borough Council.
The current charge for this is £2,164.55.

Availability Date

The property is available from the middle of June.

Length of Let

Initially offered on either a six or twelve month tenancy but the landlords intentions are for the property to be let on a long term basis.

Pets

The landlord for this property has specified that pets are not permitted.

Energy Performance Certificate

The rating for the property is C. To obtain a full report of the EPC please contact SBK.

Parking

The property has driveway parking for one car.



For more information

01489 570019
www.sbk4homes.com