



SCAN ME



19 Pound Road, Bursledon, Southampton, Hampshire,
SO31 8FF.

For more information

01489 570019
www.sbk4homes.com

3 Bedrooms, 1 Bathrooms

- Semi-Detached House
- Three Bedrooms
- Well Presented Throughout
- Modern Fitted Kitchen
- Modern Fitted Bathroom
- Long South Facing Rear Garden
- Large Detached Garage
- Driveway Parking
- Gas Central Heating
- Available Mid July



£1,350 PCM



For more information

01489 570019

www.sbk4homes.com

3 Bedrooms, 1 Bathrooms

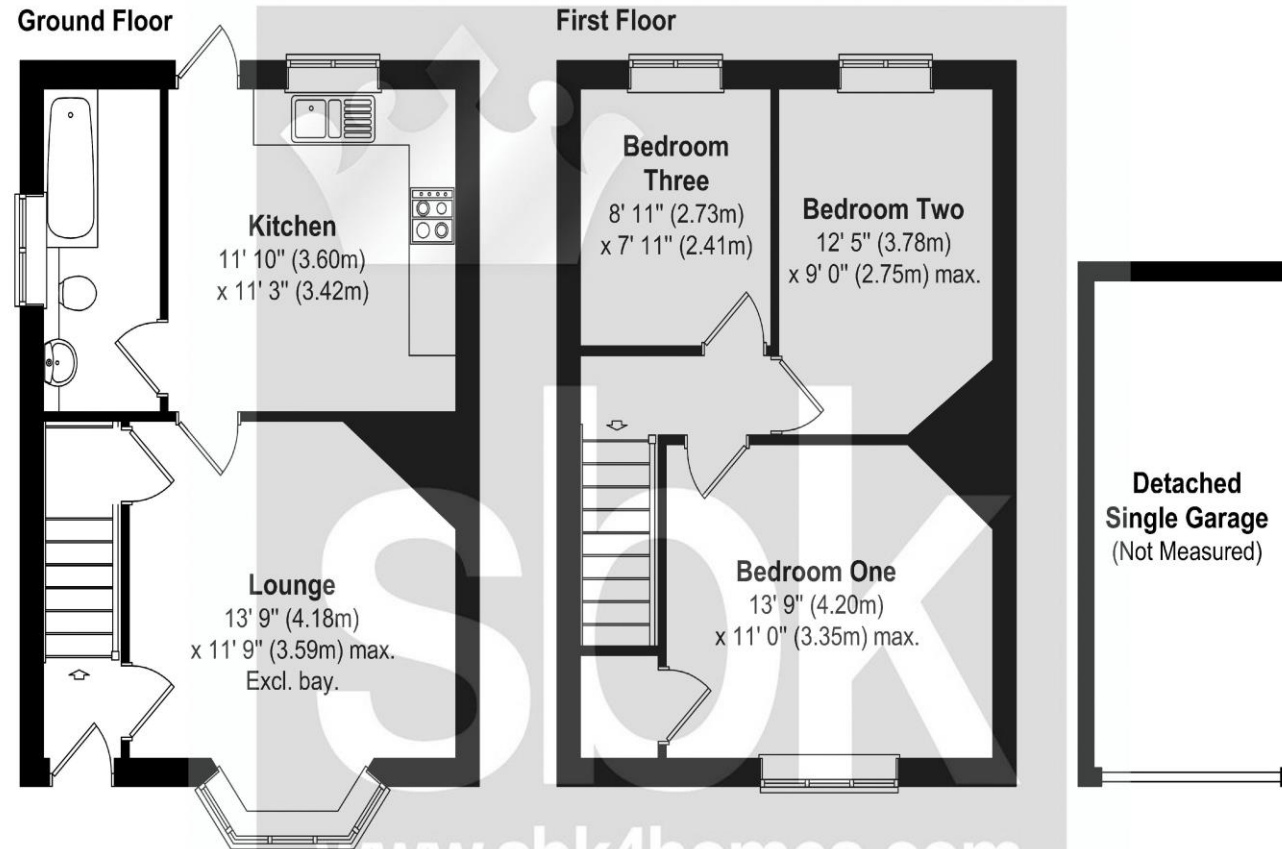

Approx. Gross Internal Floor Area 816 SQ FT 76 SQ Metres (Excluding Garage)

Whilst every attempt has been made to ensure the accuracy of the floor plans, measurements of doors, windows and rooms are approximate and no responsibility is taken for any error, omission or mis-statement. These plans are for representation purposes only and should be used as such. The services, systems and appliances listed in this specification have not been tested by SBK Property Consultants and no guarantee as to their operating efficiency can be given.

Supplementary information

Council Tax: Band - B
Payable £1,635.27
April 2024 - March 2025
Eastleigh Borough Council.

EPC: Band - D

Availability Date:
The property is available
from the middle of July

Pets:
No

Parking:
Yes

For more information

01489 570019
www.sbk4homes.com



Available to rent from the middle of July: A superb semi detached house which has previously undergone a program of modernisation and improvement. Although it benefits from the character and size of an older home it is similar to a modern property internally. Its boasts a modern fitted kitchen & bathroom and a replacement gas fired central heating system. Externally there is driveway parking, a detached garage, and a long private enclosed south facing rear garden which has a gate opening out onto a pleasant open green area of park. A viewing of this well presented property can be arranged by contacting SBK Lettings Department.



For more information



01489 570019
www.sbk4homes.com