



Kesteven Way, Bourne
£162,500 **Freehold**

QUENTIN
MARKS



Key Features



- Q type house
- Two bedrooms
- Kitchen/Diner
- Wet room
- Walking distance to town

New to the market and a perfect first time buy or investment property is this two bedroom house in Bourne. There is a large lounge, kitchen with space for a kitchen table, two bedrooms and a wet room. The property has an established front garden and a small side garden and is a 5 minute walk into town. There is allocated parking and street parking. The property is offered with NO UPWARD CHAIN.

PORCH The UPVC double glazed door opens into a porch which has a storage area.

LOUNGE Feature fire place, TV point, radiator, UPVC double glazed window to the front, door to kitchen, stairs to first floor.

KITCHEN/DINER 15' 9" x 9' 10" (4.8m x 3.0m)



Fitted with base and eye level units, stainless steel single sink and drainer, space for electric oven and fridge/freezer space for kitchen table, radiator, UPVC double glazed window to the side and a large storage space under the stairs.

BEDROOM ONE 11' 10" x 8' 6" (3.6m x 2.6m)
Radiator, UPVC double glazed window to the front.

BEDROOM TWO 8' 6" x 6' 11" (2.6m x 2.1m)
Radiator, UPVC double glazed window to the front.

WET ROOM Low level wash hand basin and WC, floor drain with Mira Electric shower above, radiator, light/shaver point, extractor fan, UPVC double glazed window to the side.

LANDING Airing / storage cupboard, radiator, access to the loft which houses the combi boiler.

OUTSIDE The front garden is well established with lots of mature shrubs and flowers. At present the side garden houses the bins. There is allocated parking for one car and street parking if necessary.



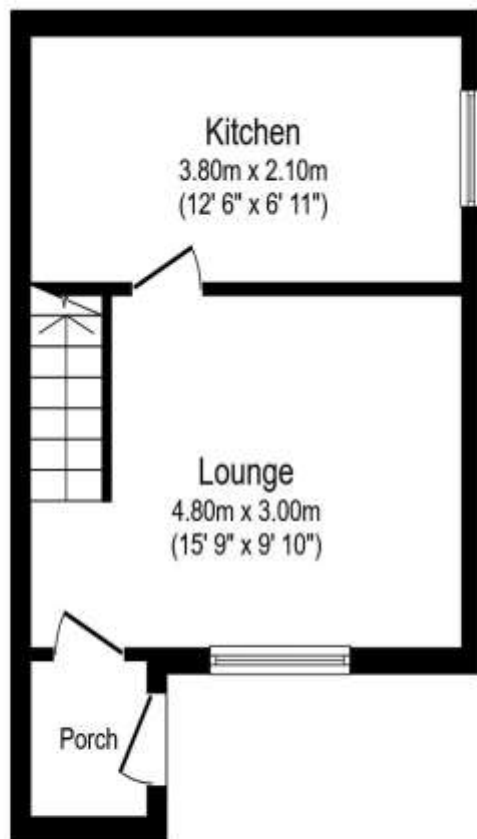

Ground Floor

Floor area 26.8 m² (289 sq.ft.)

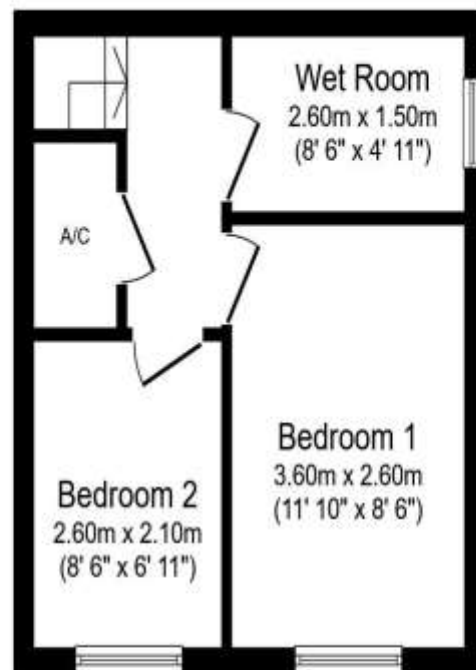

First Floor

Floor area 25.0 m² (269 sq.ft.)

TOTAL: 51.8 m² (557 sq.ft.)

This floor plan is for illustrative purposes only. It is not drawn to scale. Any measurements, floor areas (including any total floor area), openings and orientations are approximate. No details are guaranteed, they cannot be relied upon for any purpose and do not form any part of any agreement. No liability is taken for any error, omission or misstatement. A party must rely upon its own inspection(s). Powered by www.Propertybox.io

To view this property call Quentin Marks on:
01778 391600

Selling your property?

Contact us to arrange a **FREE** home valuation.

 01778 391600

 2 West Street, Bourne, Lincs, PE10 9NE

 sales@quentinmarks.co.uk

 www.quentinmarks.co.uk



SCAN FOR MORE
INFORMATION



Sharman Quinney Holdings Limited is registered in England and Wales under company number 4174227, Registered Office is Cumbria House, 16-20 Hockliffe Street, Leighton Buzzard, Bedfordshire, LU7 1GN. VAT Registration Number is 500 2481 05.

1: These particulars do not constitute part or all of an offer or contract. 2: The measurements indicated are supplied for guidance only and as such must be considered incorrect. 3: Potential buyers are advised to recheck the measurements before committing to any expense. 4: Sharman Quinney has not tested any apparatus, equipment, fixtures, fittings or services and it is the buyers interests to check the working condition of any appliances. 5: Sharman Quinney has not sought to verify the legal title of the property and buyers must obtain verification from their legal representative. 6: Intending purchasers will be asked to produce identification documentation at a later stage and we would ask your co-operation in order that there will be no delay in agreeing the sale. Ref: SQB100081 - 0003

