



HALLWAY

BEDROOM 1

BEDROOM 2

BATHROOM

KITCHEN

LIVING ROOM

Floor Plan

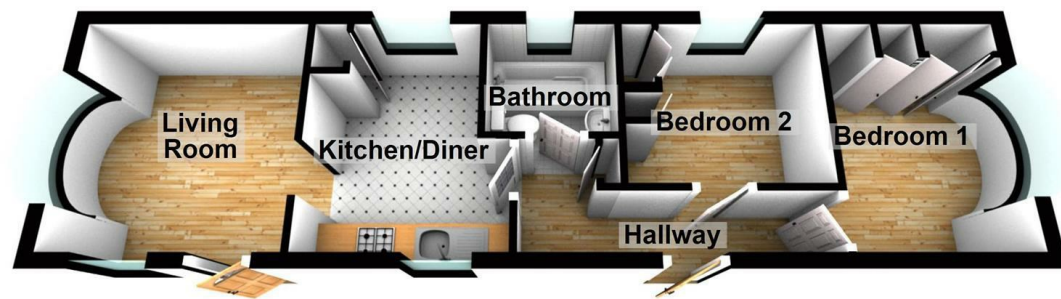

Woodcock Holmes
 First Floor Offices, 4 Office Village
 Hampton, Peterborough PE7 8GX
 01733 303111
 info@woodcockholmes.co.uk

rightmove
 find your happy

The Property Ombudsman

Zoopla

THE GUILD PROPERTY PROFESSIONALS



These particulars do not constitute part or all of an offer of contract. The measurements are supplied for guidance only and as such must be considered incorrect. Potential buyers are advised to re-check measurements before committing to any expense. Woodcock Holmes have not tested any apparatus, equipment, services, fixtures or fittings and it is in the buyer's interest to check the working condition of appliances. Floorplans are for illustration purposes only and are not to scale. Woodcock Holmes has sought not to verify the legal title of the property. Buyers not obtain such verification from their solicitors.

7a Keys Park
 Parnwell, PE1 4SL
 £70,000



**7a Keys Park
Parnwell
PE1 4SL**

This detached Park Home is in the highly respected and well-presented Keys Park over 50's development. Situated on the border of the Park with wrap around garden space, two bedrooms, bathroom, kitchen, living room and No Forward Chain - this is a must view!

- NO FORWARD CHAIN
- OVER 50'S DEVELOPMENT
- POPULAR AND WELL-PRESENTED KEYS PARK DEVELOPMENT
- CLOSE TO LOCAL TRAVEL LINKS AND PUBLIC TRANSPORT
- TWO BEDROOMS
- WRAP AROUND GARDEN AREA
- GAS CENTRAL HEATING
- UPVC DOUBLE GLAZED

Viewings: By appointment
£70,000

HALLWAY

UPVC double glazed door to front, fitted carpet, store cupboard, access to all rooms.

BEDROOM 1

10'0" x 7'3"
UPVC double glazed window to side, fitted carpet, radiator, fitted wardrobes.

BEDROOM 2

7'5" x 8'6"
UPVC double glazed window to rear, fitted carpet, radiator, fitted wardrobes.

BATHROOM

5'4" x 5'6"
Obscure uPVC double glazed window to rear. Three piece suite with low level WC, wash hand basin and bath.

KITCHEN

10'0" x 7'3"
UPVC double glazed window to front and rear, fitted kitchen, fitted worktop, fitted sink drainer, space for washing machine, space for oven, space for fridge freezer, airing cupboard, vinyl flooring.

LIVING ROOM

10'0" x 9'8"
UPVC double glazed window to front, side and single uPVC door to front. Vinyl flooring, radiator.

TENURE

Tenure - Tenure: Virtual Freehold. Virtual Freehold means that when buying a park home, you purchase the physical property outright and lease the land it sits on in perpetuity, for the entirety of the time the home is sited. These properties are not mortgageable. Please consult a solicitor for further information.

SERVICES

Services - Mains water, gas, electricity and drainage are all connected. None of these services or appliances have been tested by the agents.

FIXTURES & FITTINGS

Fixtures & Fittings - Every effort has been made to omit any fixtures belonging to the Vendor in the description of the property and the property is sold subject to the Vendor's right to the removal of, or payment for, as the case may be, any such fittings etc whether mentioned in these particulars or not.