



# SIMMONS & SON



**Hampshire Avenue, Slough, SL1 3AQ**

**Price £540,000 Freehold**

**EXTENDED FAMILY SEMI - OFF FARNHAM ROAD**

Three bedroom extended semi detached house, within walking distance to Herschel Grammar school and offering excellent transport links to Slough town centre and the M4 motorway. The property benefits from two reception rooms, downstairs shower room, upstairs bathroom, off street parking for four vehicles and a private garden with large outbuilding.





Hampshire Avenue, Slough, Berkshire, SL1 3AQ

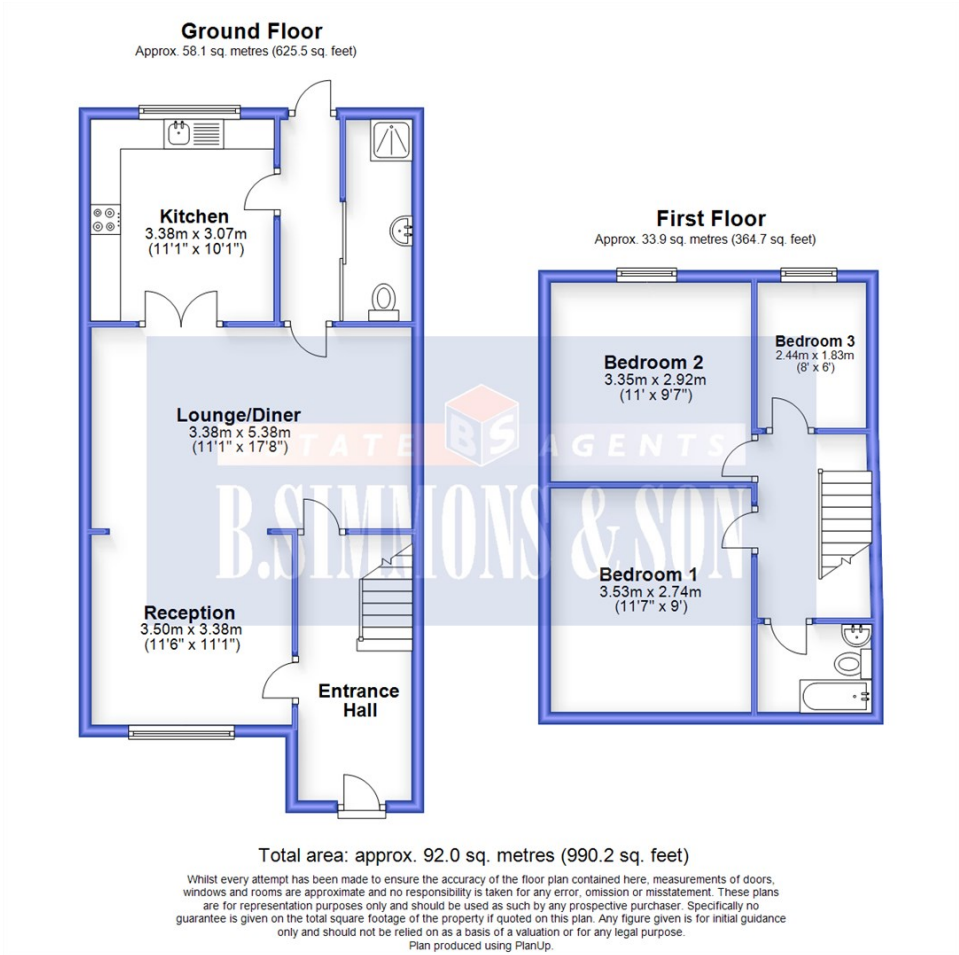

- Extended Semi Detached
- Ample Parking
- Three Bedrooms
- Large Outbuilding
- Two Reception Rooms
- Just Off Farnham Road
- Two Bathrooms
- EPC : D
- GCH & DG
- Council Tax Band : C



Energy Efficiency Rating		
	Current	Potential
Very energy efficient - lower running costs		
(92 plus) A		
(81-91) B		
(69-80) C		
(55-68) D		
(39-54) E		
(21-38) F		
(1-20) G		
Not energy efficient - higher running costs		
		85
	63	
England & Wales		
EU Directive 2002/91/EC		

Environmental Impact (CO <sub>2</sub> ) Rating		
	Current	Potential
Very environmentally friendly - lower CO <sub>2</sub> emissions		
(92 plus) A		
(81-91) B		
(69-80) C		
(55-68) D		
(39-54) E		
(21-38) F		
(1-20) G		
Not environmentally friendly - higher CO <sub>2</sub> emissions		
		84
	60	
England & Wales		
EU Directive 2002/91/EC		

These particulars are intended as a general guide only and do not constitute any part of an offer or contract. All descriptions, dimensions, references to condition and necessary permissions for use and occupation, and other details are given without responsibility. Intending purchasers or tenants should satisfy themselves as to the accuracy of all statements and representations before entering into any agreement. We have not carried out a survey or checked the services, appliances or fixtures and fittings. Room dimensions should not be relied upon for carpets or furnishings. No employee or partner of B Simmons & Son has authority to make or give any representation or warranty in relation to the property. All negotiations for this purchase must be made through B Simmons & Son.