



Custerson Court, Station Street, Saffron Walden

£225,000 Leasehold



Key Features



125 Years remaining as of 01 May 1995

£579.58 Ground Rent pa

Review due: Ask Agent

£3000.00 Service Charge pa

Review due: 04/2025

- Chain free retirement apartment
- Two double bedrooms
- Walking distance to saffron Walden Town Centre
- Well-kept communal gardens
- Lifts to all floors

This two-bedroom apartment benefits from a large lounge/diner, separate kitchen, two double bedrooms and bathroom. This popular retirement development benefits from a communal resident's lounge, communal laundry, communal gardens,



double glazing and lifts to all floors. Saffron Walden is a fine old market town with a good range of shopping, schooling and recreational facilities, including the renowned Saffron Hall, which is situated at the County High School. Audley End mainline station (with fast trains to Liverpool Street and Cambridge) is just two miles distance and the M11 access point at Stump Cross 4 miles.

Communal entrance Secure entrance door to communal hallway providing access to the lift and stairs and spacious residents' lounge. Also providing access to the well-kept communal garden.

Entrance Hall

Lounge/Diner
20'9 (max) x 10'10

Kitchen
7'10 x 6'0

Bedroom One
13'4 x 9'8

Bedroom Two



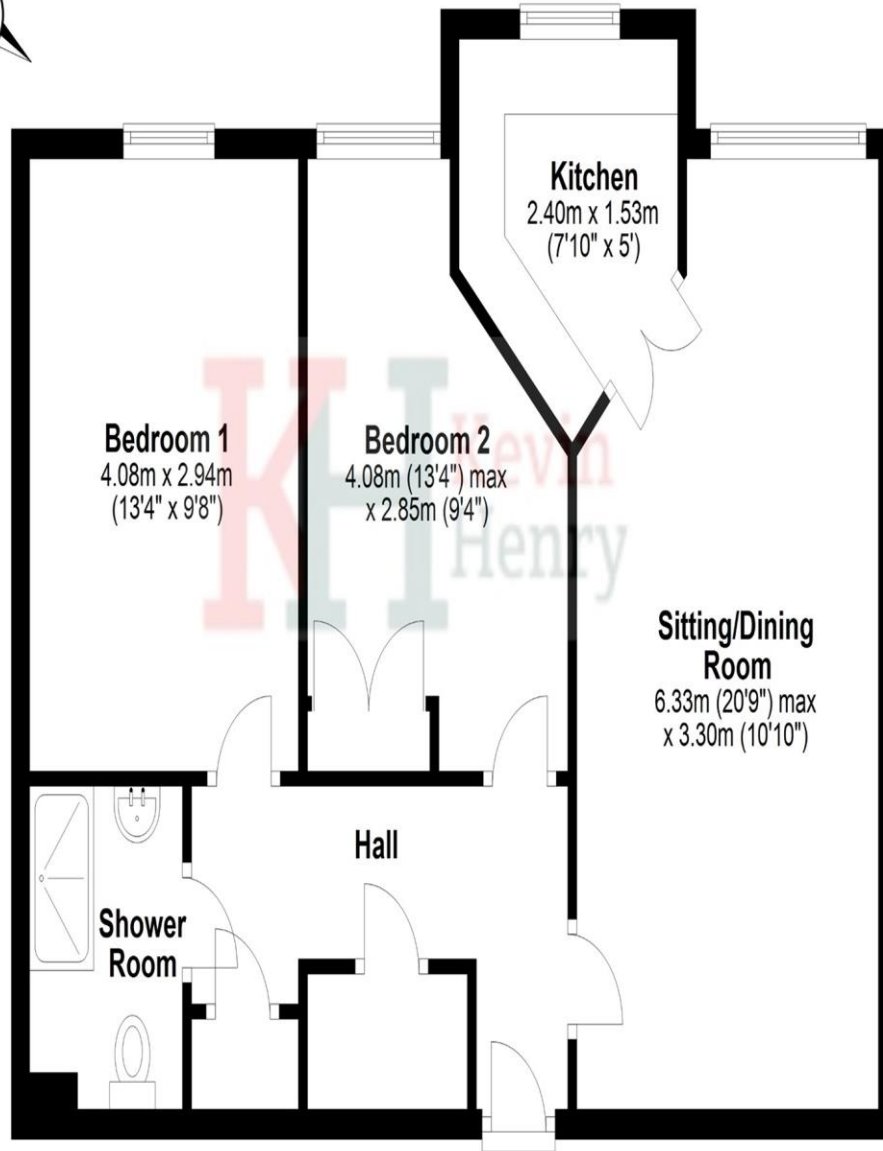

Approx gross internal floor area 60 sqm (650 sqft)

13'4 (max) x 9'4

Bathroom

Outside

Communal gardens and ample parking

To view this property call Kevin Henry on:
01799 513632

Selling your property?

Contact us to arrange a FREE home valuation.

 01799 513632

 1 Market Street, SAFFRON WALDEN, Essex, CB10 1JB

 sales@kevinhenry.co.uk

 www.Kevinhenry.co.uk



 SCAN ME



Kevin Henry is a trading name of Sharman Quinney Holdings Limited which is registered in England and Wales under company number 4174227, Registered Office is Cumbria House, 16-20 Hockliffe Street, Leighton Buzzard, Bedfordshire, LU7 1GN. VAT Registration Number is 500 2481 05.

1: These particulars do not constitute part or all of an offer or contract. 2: The measurements indicated are supplied for guidance only and as such must be considered incorrect. 3: Potential buyers are advised to recheck the measurements before committing to any expense. 4: Kevin Henry has not tested any apparatus, equipment, fixtures, fittings or services and it is the buyers interests to check the working condition of any appliances. 5: Kevin Henry has not sought to verify the legal title of the property and buyers must obtain verification from their legal representative. 6: Intending purchasers will be asked to produce identification documentation at a later stage and we would ask your co-operation in order that there will be no delay in agreeing the sale. Ref: SAF102989 - 0004

