



Skeins Way, Clavering Saffron Walden £350,000 **Freehold**



Key Features



- No Onward Chain
- Two Bedrooms
- Village Location
- Bungalow
- Enclosed Rear Garden

The property has good size living room with large window to the front letting in lots of natural light, there is also a feature fireplace and storage cupboard. Opening leads, you to the kitchen, where you will find ample wall and base units with worktop over, inset sink and drainer, space for cooker, plumbing for washing machine, storage cupboard. Two double bedrooms both benefitting from having built in storage cupboards, bathroom comprises shower cubicle, low level wc, pedestal wash hand basin.

Outside there is an enclosed rear garden that is mainly paved for ease of maintenance with some flower borders, timber built garden shed, gate providing side access. To the front



there is a lawn area with path leading to the front door.

Clavering is a very sought-after village with local amenities including an outstanding Primary School, local convenience store, two pubs and gym. The market towns of Saffron Walden and Bishop's Stortford are easily reachable, and transport-wise there are mainline stations at Audley End and Bishop's Stortford (Liverpool Street) plus access to the M11 at Junction 8. Stansted Airport is within 9 miles.



GROUND FLOOR

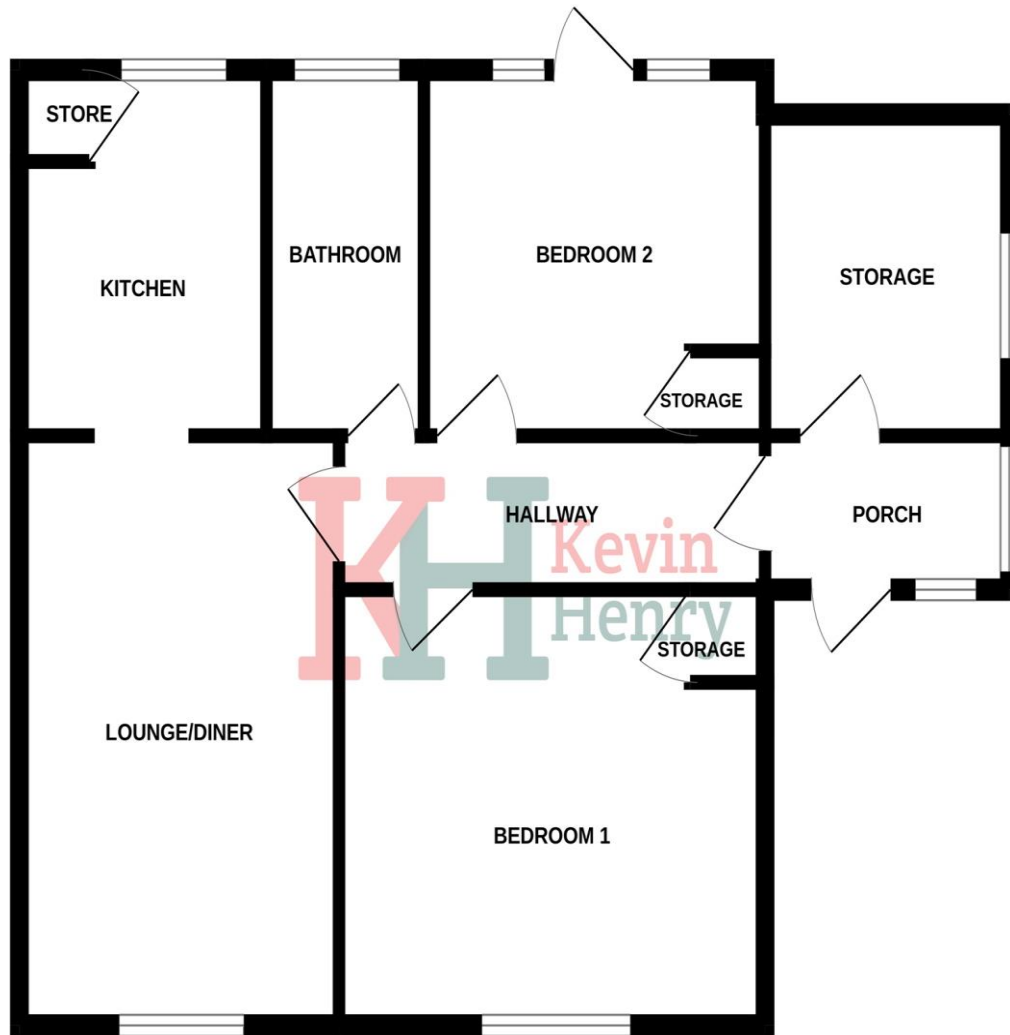

Entrance Porch

Hallway

Living Room 15'7 x 10'1

Kitchen 9'8 x 7'9

Bedroom One 11'9 x 11'2

Bedroom Two 10'9 x 9'8

Shower Room

To view this property call Kevin Henry on:
01799 513632

Selling your property?

Contact us to arrange a FREE home valuation.

 01799 513632

 1 Market Street, SAFFRON WALDEN, Essex, CB10 1JB

 sales@kevinhenry.co.uk

 www.Kevinhenry.co.uk



 SCAN ME



Kevin Henry is a trading name of Sharman Quinney Holdings Limited which is registered in England and Wales under company number 4174227, Registered Office is Cumbria House, 16-20 Hockliffe Street, Leighton Buzzard, Bedfordshire, LU7 1GN. VAT Registration Number is 500 2481 05.

1: These particulars do not constitute part or all of an offer or contract. 2: The measurements indicated are supplied for guidance only and as such must be considered incorrect. 3: Potential buyers are advised to recheck the measurements before committing to any expense. 4: Kevin Henry has not tested any apparatus, equipment, fixtures, fittings or services and it is the buyers interests to check the working condition of any appliances. 5: Kevin Henry has not sought to verify the legal title of the property and buyers must obtain verification from their legal representative. 6: Intending purchasers will be asked to produce identification documentation at a later stage and we would ask your co-operation in order that there will be no delay in agreeing the sale. Ref: SAF102874 - 0003

