



Bartlow Road, Linton Cambridge £425,000 **Freehold**



Key Features



- 3 bedrooms
- Kitchen/diner
- Home office/workshop
- Character cottage
- Renovated and extended

The accommodation comprises an entrance hall, a large lounge with exposed brick fireplace and recessed storage, a recently fitted open-plan kitchen dining area including underfloor heating with attractive base and eye level units which incorporate an integrated electric oven and microwave, gas hob with extractor over, spaces for dishwasher, washing machine and fridge freezer, further storage cupboards and stable door opening onto the rear garden. There is a stylish bathroom with a white three piece suite and a shower over the bath.

Upstairs, the landing provides access to all three good sized bedrooms with the large main bedroom being quite a feature,



providing a stylish en-suite, as well as great storage space and views over the attractive rear garden.

To the front of the property is a small courtyard garden. There is gated side access to the rear garden which is stunning and provides a terrace, a long lawn area with mature trees, hedges and shrubs, a fabulous office / workshop which has double glazed units, and a further garden area perfect for an allotment.

Linton is a thriving village on the south Cambridgeshire/Essex border and has an excellent range of facilities including a well-regarded primary school and secondary school with terrific facilities used by the village, medical centre, pharmacy, inns, restaurants, village store, post office, garage, fine parish church and recreational ground. The university city of Cambridge is to the northwest whilst the fine old market town of Saffron Walden is 6 miles to the south. Mainline railway stations with fast trains to Liverpool Street and the M11 access points are within easy reach.



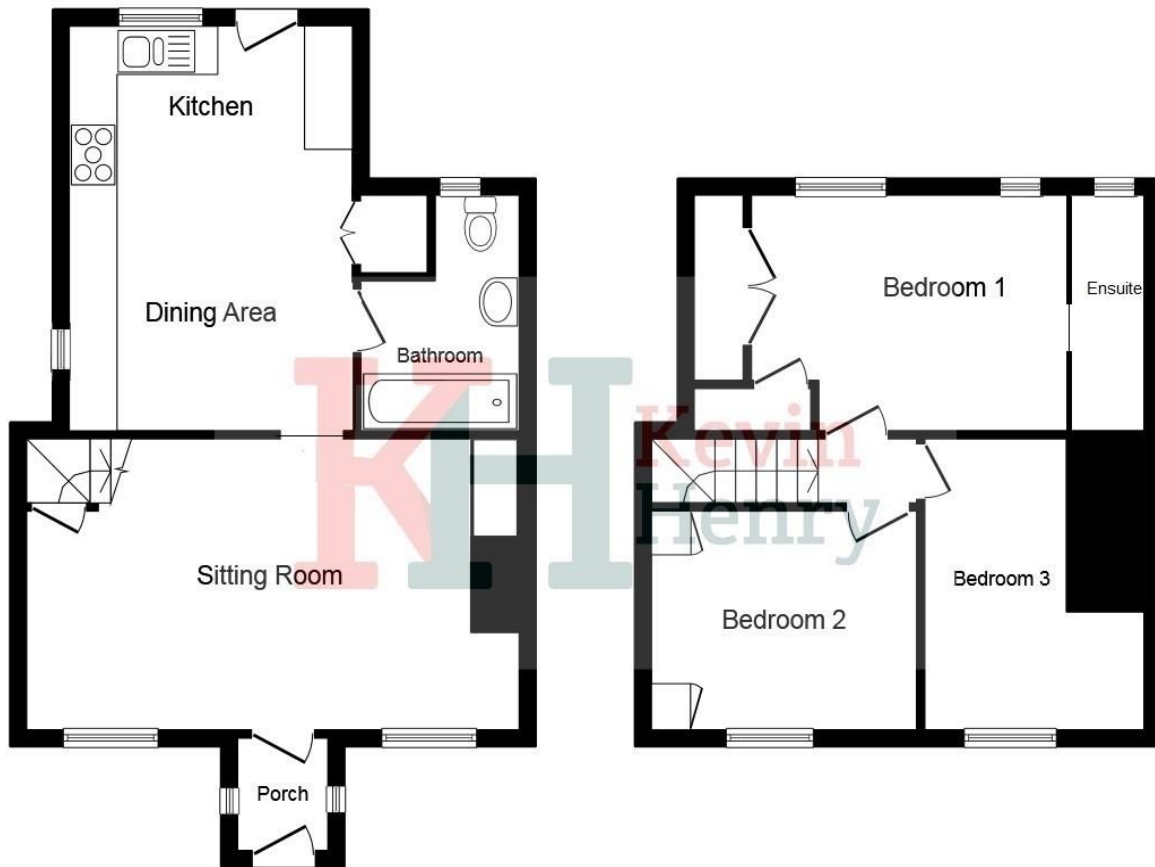

Ground Floor

First Floor

Entrance Hall / Lobby

Lounge

17'2" (max) x 11'9" (max) (5.24m (max) x 3.63m (max))

Kitchen / Diner

16'2" x 11'5" (max) (4.94m x 3.51m (max))

Bathroom

Bedroom 1

13'4" (max) x 9'6" (max) (4.08m (max) x 2.93m (max))

Ensuite Shower Room and WC

Bedroom 2

10'9" (max) x 8'7" (3.32m (max) x 2.65m)

Bedroom 3

11'9" x 9'0" narrowing to 5'9" (3.63m x 2.74m narrowing to 1.8m)

This floor plan is for illustrative purposes only. It is not drawn to scale. Any measurements, floor areas (including any total floor area), openings and orientation are approximate. No details are guaranteed, they cannot be relied upon for any purpose and they do not form part of any agreement. No liability is taken for any error, omission or misstatement. A party must rely upon its own inspection(s). Plan produced for Kevin Henry. Powered by www.focalagent.com

To view this property call Kevin Henry on:
01799 513632

Selling your property?

Contact us to arrange a FREE home valuation.

 01799 513632

 1 Market Street, SAFFRON WALDEN, Essex, CB10 1JB

 sales@kevinhenry.co.uk

 www.Kevinhenry.co.uk



 SCAN ME



Kevin Henry is a trading name of Sharman Quinney Holdings Limited which is registered in England and Wales under company number 4174227, Registered Office is Cumbria House, 16-20 Hockliffe Street, Leighton Buzzard, Bedfordshire, LU7 1GN. VAT Registration Number is 500 2481 05.

1: These particulars do not constitute part or all of an offer or contract. 2: The measurements indicated are supplied for guidance only and as such must be considered incorrect. 3: Potential buyers are advised to recheck the measurements before committing to any expense. 4: Kevin Henry has not tested any apparatus, equipment, fixtures, fittings or services and it is the buyers interests to check the working condition of any appliances. 5: Kevin Henry has not sought to verify the legal title of the property and buyers must obtain verification from their legal representative. 6: Intending purchasers will be asked to produce identification documentation at a later stage and we would ask your co-operation in order that there will be no delay in agreeing the sale. Ref: SAF102676 - 0005

