



Brookhampton Street, Ickleton Saffron Walden £250,000 **Freehold**



Kevin  
Henry

# Key Features



- Cash Buyers Only
- Chain Free
- Two Bedrooms
- Two Reception Rooms
- In Need of Renovation

Located in the sought after village of Ickleton you will find this two bedroom cottage that is offered for sale with no onward chain.

From the front door you enter into the living room, with windows to the front and side and opening to the dining room here you have the stairs that lead to the first floor. Door leads you through to the kitchen. Garden room and family bathroom complete the downstairs accommodation. Up on the first floor you will find two double bedrooms. Outside there is a garden that wraps round from the front to the rear.



Ickleton is a popular and highly sought after Cambridgeshire village close to the Essex border. As well as many fine period properties and an historic Church, the village has a popular Inn and Shop/Post Office. Saffron Walden is around 5 miles and Cambridge is about 11 miles away. The M11 (junction 10) is approximately 3 miles distant and Great Chesterford mainline station with trains to Cambridge and London's Liverpool Street is about 1 1/2 miles away.

Accommodation Includes

Living Room 11'9max x 11'3

Dining Room 11'9 x 9'0

Kitchen 9'0 x 7'0

Garden Room 11'3 x 6'0

Family Bathroom



GROUND FLOOR

1ST FLOOR

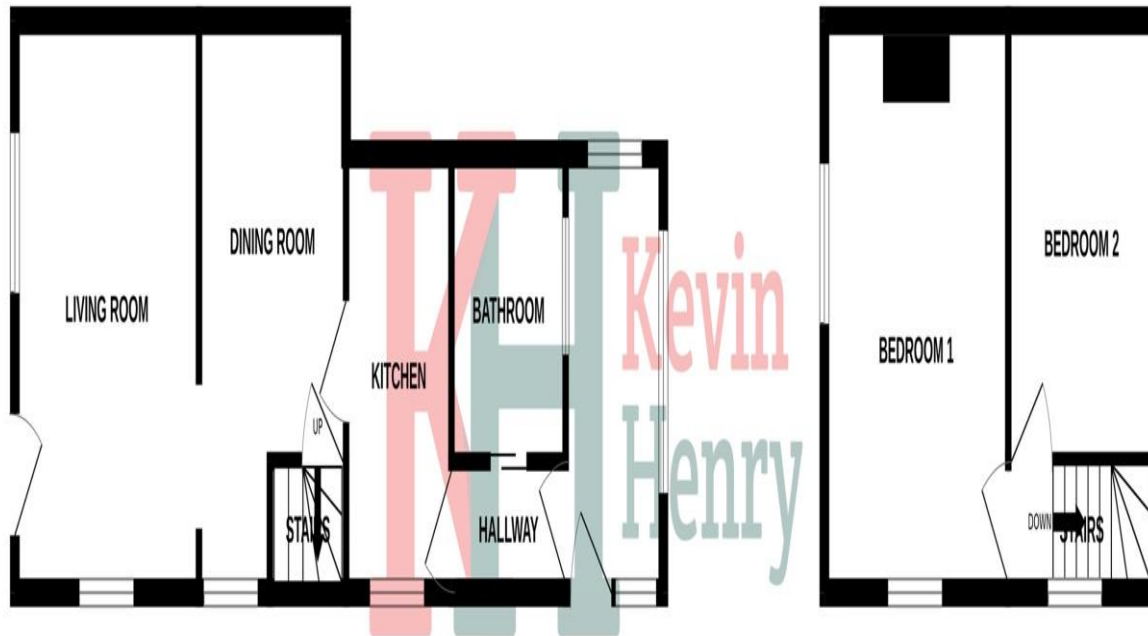

## First Floor

Bedroom One 12'2 x 11'5

Bedroom 9'4 x 9'4

Whilst every attempt has been made to ensure the accuracy of the floorplan contained here, measurements of doors, windows, rooms and any other items are approximate and no responsibility is taken for any error, omission or mis-statement. This plan is for illustrative purposes only and should be used as such by any prospective purchaser. The services, systems and appliances shown have not been tested and no guarantee as to their operability or efficiency can be given.

Made with Metropix ©2023

To view this property call Kevin Henry on:  
01799 513632

# Selling your property?

Contact us to arrange a FREE home valuation.

 01799 513632

 1 Market Street, SAFFRON WALDEN, Essex, CB10 1JB

 [sales@kevinhenry.co.uk](mailto:sales@kevinhenry.co.uk)

 [www.Kevinhenry.co.uk](http://www.Kevinhenry.co.uk)



 SCAN ME



Kevin Henry is a trading name of Sharman Quinney Holdings Limited which is registered in England and Wales under company number 4174227, Registered Office is Cumbria House, 16-20 Hockliffe Street, Leighton Buzzard, Bedfordshire, LU7 1GN. VAT Registration Number is 500 2481 05.

1: These particulars do not constitute part or all of an offer or contract. 2: The measurements indicated are supplied for guidance only and as such must be considered incorrect. 3: Potential buyers are advised to recheck the measurements before committing to any expense. 4: Kevin Henry has not tested any apparatus, equipment, fixtures, fittings or services and it is the buyers interests to check the working condition of any appliances. 5: Kevin Henry has not sought to verify the legal title of the property and buyers must obtain verification from their legal representative. 6: Intending purchasers will be asked to produce identification documentation at a later stage and we would ask your co-operation in order that there will be no delay in agreeing the sale. Ref: SAF102622 - 0001

