



Omega Works, Bow E3

£449,995

2 Bedrooms

Fifth floor two bedroom, two bathroom apartment situated within this popular canal side development with private balcony overlooking the Hertford Union Canal.

Sought After Development Overlooking Hertford Union Canal

Huge Open Plan Living Space Private Balcony

Look Property Services
349 Roman Road
Bow, London, E3 5QR

020 8981 9999
info@lookproperty.co.uk

[lookproperty.com](https://www.lookproperty.com)

Description

Fifth floor two bedroom, two bathroom apartment situated within this popular canal side development with private balcony overlooking the Hertford Union Canal. The property is approximately 1109 square feet and has wooden flooring throughout with under flooring heating system. . Located within 500 metres of Hackney Wick over ground station and approximately 1 mile from Stratford Station and the Westfield shopping centre, also giving access to the A11, A12 and A13, the property is ideal for those looking to maintain an easy commute into Central London.

Tenure

Leasehold

Local Authority

Additional Information

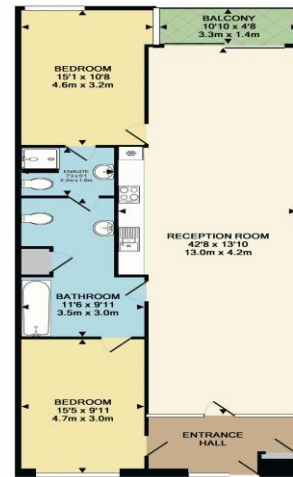

5TH FLOOR

OMEGA WORKS E3
TOTAL APPROX. FLOOR AREA 1109 SQ.FT. (103.0 SQ.M.)

Whilst every attempt has been made to ensure the accuracy of the floor plan contained here, measurements of doors, windows, rooms and any other items are approximate and no responsibility is taken for any error, omission, or mis-statement. This plan is for illustrative purposes only and should be used as such by any prospective purchaser. The services, systems and appliances shown have not been tested and no guarantee as to their operability or efficiency can be given.



IMPORTANT NOTICE

In accordance with the Property Misdescriptions Act (1991) we have prepared these sales particulars as a general guide to give a broad description of the property. They are not intended to constitute part of an offer or contract. We have not carried out a structural survey and the services, appliances and specific fittings have not been tested. All photographs, measurements, floorplans and distances referred to are given as a guide only and should not be relied upon for the purchase of carpets or any other fixtures or fittings. Lease details, service charges and ground rent (where applicable) are given as a guide only and should be checked and confirmed by your Solicitor prior to exchange of contracts. The copyright of all details, photographs and floorplans remain exclusive to Look Property LLP.