



Rivermead Wilford Lane

West Bridgford | NG2 7RB | Guide Price £168,500 - £178,500

ROYSTON
& LUND

- **GUIDE PRICE
£168,500 -
£178,500**
- Balcony Views
- Well Presented
- Off Street Parking
- EPC Rating - E
- **EXCELLENT
LOCATION**
- Two Bedrooms
- Integrated Kitchen Appliances
- Close By To Numerous Amenities
- Council Tax Band - A





****GUIDE PRICE £168,500 - £178,500****

****EXCELLENT LOCATION****

A TWO bedroom top floor apartment in the Harvard House building with amazing views over the River Trent being sold in good condition, Situated close to West Bridgford Town Centre.



The property briefly comprises an entrance hallway, three bedrooms with two having access to the south facing balcony and two double bedrooms having built in storage. There is a bathroom with separate WC, a modern kitchen and the lounge has spanning views over the River Trent.

The following leasehold information has been provided by the vendor:

The lease term is has recently been extended.

Lease Term: Extended lease 185 Years

Lease Commencement Date: 24th June 1975

Ground Rent: £150 Per Annum

Service Charge: £1,978.78



EPC

Energy Efficiency Rating

	Current	Potential
Very energy efficient - lower running costs		
(92 plus) A		
(81-91) B		
(69-80) C		
(55-68) D		
(39-54) E		
(21-38) F		
(1-20) G		
Not energy efficient - higher running costs		
	52	74

England & Wales EU Directive 2002/91/EC

Environmental Impact (CO₂) Rating

	Current	Potential
Very environmentally friendly - lower CO ₂ emissions		
(92 plus) A		
(81-91) B		
(69-80) C		
(55-68) D		
(39-54) E		
(21-38) F		
(1-20) G		
Not environmentally friendly - higher CO ₂ emissions		

England & Wales EU Directive 2002/91/EC

Sixth Floor
Approx. 55.4 sq. metres (595.8 sq. feet)

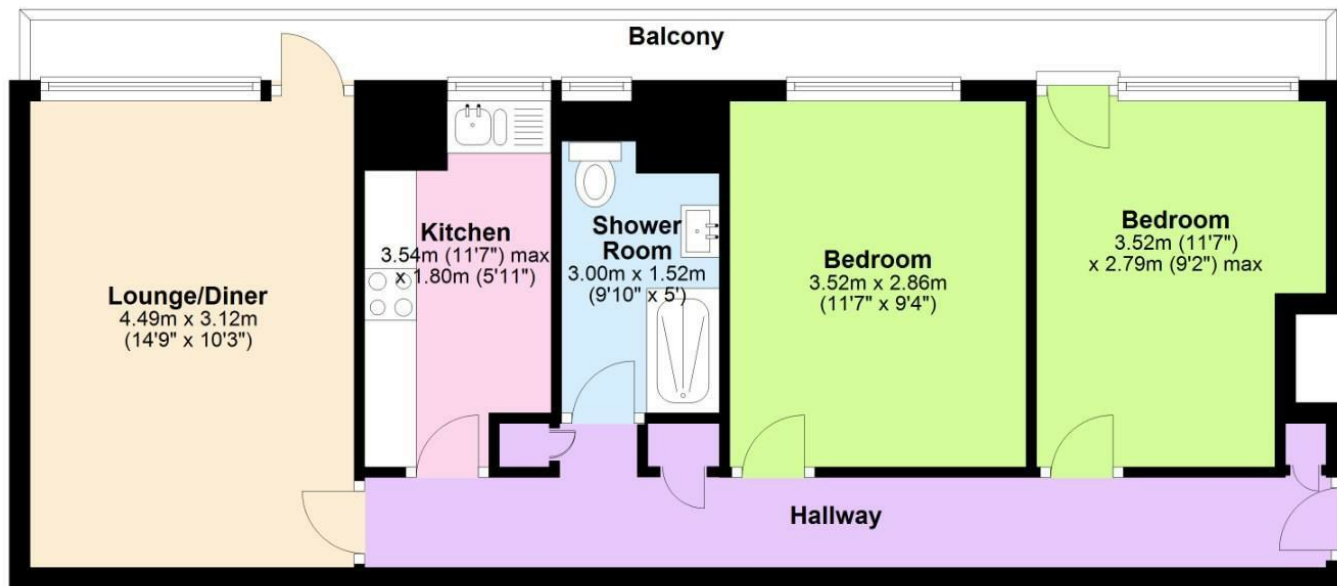

Total area: approx. 55.4 sq. metres (595.8 sq. feet)

Where every attempt has been made to ensure the accuracy of the floor plan contained here, measurements of doors, windows, rooms and any other items are approximate and no responsibility is taken of any error, omission or mis-statement. This plan is for illustrative purposes only and should be used as such by any prospective purchaser.
Plan produced using PlanUp.

These particulars, whilst believed to be accurate are set out as a general outline only for guidance and do not constitute any part of an offer or contract. Intending purchasers should not rely on them as statements of representation of fact, but must satisfy themselves by inspection or otherwise as to their accuracy. No person in this firms employment has the authority to make or give any representation or warranty in respect of the property.

ROYSTON
& LUND