



Lauriston Road, London

£385,000



- **Within "Victoria Park Village"**
- **Fantastic 1st Purchase**
- **Share of FREEhold**
- **1 Bedroom, 2nd Floor Apartment**
- **Moments From Victoria Park**





Forming part of an attractive Victorian property this one bedroom apartment offers you a fabulous opportunity to perhaps purchase your first property within "Victoria Park Village"
Simple but effective by design the property has well proportioned rooms, modern kitchen and bathroom and further benefits by having a share of the freehold with the other residents.



Lauriston Road
 Approx. Gross Internal Area 412 Sq Ft - 38.28 Sq M

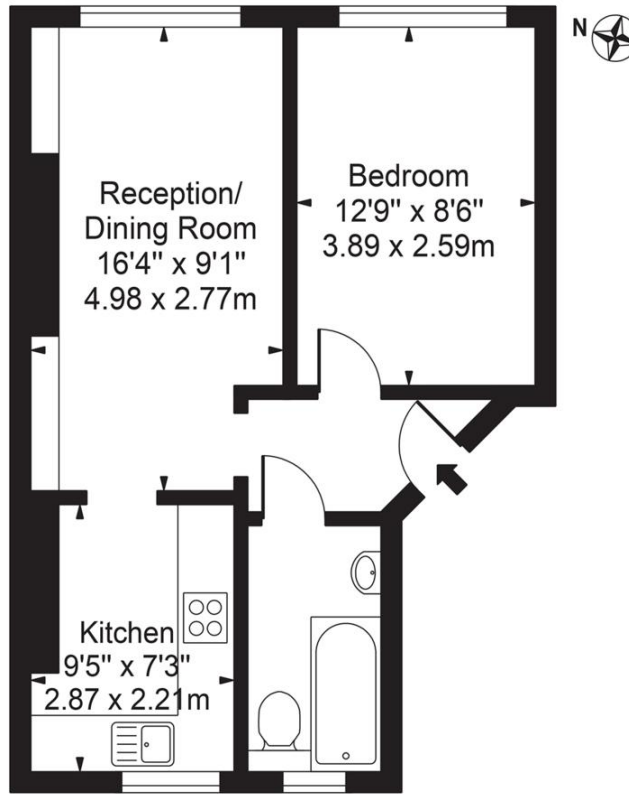

First Floor

For Illustration Purposes Only - Not To Scale

This floor plan should be used as a general outline for guidance only and does not constitute in whole or in part an offer or contract. Any intending purchaser or lessee should satisfy themselves by inspection, searches, enquiries and full survey as to the correctness of each statement. Any areas, measurements or distances quoted are approximate and should not be used to value a property or be the basis of any sale or let.

Share of the Freehold

Score	Energy rating	Current	Potential
92+	A		
81-91	B		
69-80	C		
55-68	D	65 D	78 C
39-54	E		
21-38	F		
1-20	G		

Please contact our office at

176 Longwood Gardens
 Ilford, Essex
 IG5 0EW
 02082201500



DAYS A
WEEK



FREE
VALUATIONS



FLOOR
PLANS



FULL COLOUR
PHOTOGRAPHY



SMS
TEXT ALERTS



MORTGAGE
ADVICE



COLOUR
MAPS

sovereign-house.com
 homes@sovereign-house.com

Victoria Park Sales
 213 Victoria Park Road
 London E9 7HD
 Tel: 020 8985 5800



@sovereignhouse



www.facebook.com/sovereignhousehackney

Clayhall/Redbridge Sales
 176 Longwood Gardens,
 Essex IG5 0EW
 Tel: 020 8220 1500

