

Chiswick Drive

Loughborough, LE11 4TU



A beautifully spacious and light home, situated on a fantastic wrap around garden plot, within a sought-after residential area, with well-presented living space and private parking, being sold with no onward chain.

£190,000



John German

The property information provided by John German Estate Agents Ltd is based on enquiries made of the vendor and from information available in the public domain. If there is any point on which you require further clarification, please contact the office and we will be pleased to check the information for you, particularly if contemplating travelling some distance to view the property. Please note if your enquiry is of a legal or structural nature, we advise you to seek advice from a qualified professional in their relevant field.

We are required by law to comply fully with The Money Laundering Regulations 2017 and as such need to complete AML ID verification and proof / source of funds checks on all buyers and, where relevant, cash donors once an offer is accepted on a property. We use the Checkboard app to complete the necessary checks, this is not a credit check and therefore will have no effect on your credit history. With effect from 1st March 2025 a non-refundable compliance fee of £30.00 inc. VAT per buyer / donor will be required to be paid in advance when an offer is agreed and prior to a sales memorandum being issued.

Externally, the garden is of fantastic size wrapping around the property and offering great potential to extend in to (STPP) or create a spacious outdoor oasis. The property has two dedicated parking spaces a short walk from the front door.

Our Ref: JGA/16122025

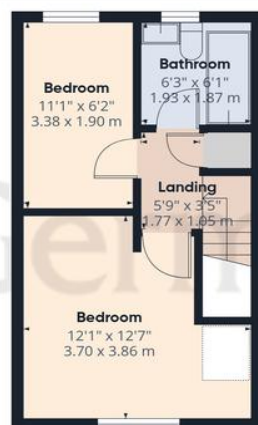
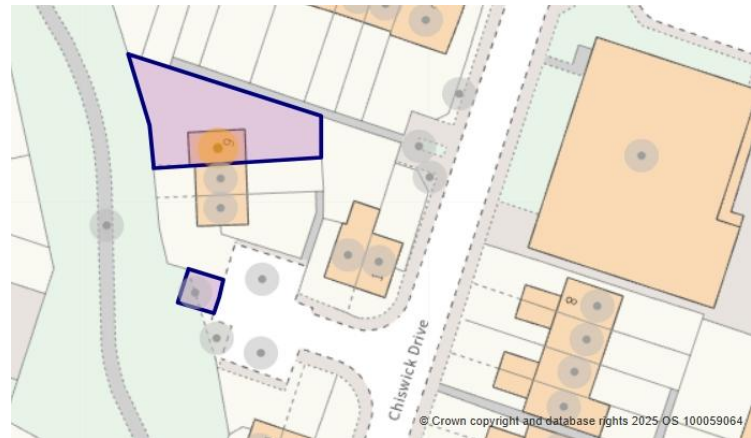
John German 

Approximate total area^(a)

557 ft²51.8 m²

Reduced headroom

 9 ft^2 0.8 m²

(1) Excluding balconies and terraces

Reduced headroom

Below 5 ft/1.5 m

Calculations reference the RICS IPMS 3C standard. Measurements are approximate and not to scale. This floor plan is intended for illustration only.

GIRAFFE360





Score	Energy rating	Current	Potential
92+	A		
81-91	B		
69-80	C		
55-68	D		57 D
39-54	E		
21-38	F	36 F	
1-20	G		

OnTheMarket

rightmove

RICS

aria
propertymark
PROTECTED

naea
propertymark
PROTECTED

The Property
Ombudsman

APPROVED CODE
TRADING STANDARDS UK

John German

3-5 Bedford Square, Loughborough, Leicestershire, LE11 2TP

01509 239121

loughborough@johnngerman.co.uk

Agents' Notes

These particulars do not constitute an offer or a contract neither do they form part of an offer or contract. The vendor does not make or give and Messrs. John German nor any person employed has any authority to make or give any representation or warranty, written or oral, in relation to this property. Whilst we endeavour to make our sales details accurate and reliable, if there is any point which is of particular importance to you, please contact the office and we will be pleased to check the information for you, particularly if contemplating travelling some distance to view the property. None of the services or appliances to the property have been tested and any prospective purchasers should satisfy themselves as to their adequacy prior to committing themselves to purchase.

Referral Fees

Mortgage Services - We routinely refer all clients to APR Money Limited. It is your decision whether you choose to deal with APR Money Limited. In making that decision, you should know that we receive on average £60 per referral from APR Money Limited.

Conveyancing Services - If we refer clients to recommended conveyancers, it is your decision whether you choose to deal with this conveyancer. In making that decision, you should know that we receive on average £150 per referral.

Survey Services - If we refer clients to recommended surveyors, it is your decision whether you choose to deal with this surveyor. In making that decision, you should know that we receive up to £90 per referral.

Ashbourne | Ashby de la Zouch | Barton under Needwood
Burton upon Trent | Derby | East Leake | Lichfield
Loughborough | Stafford | Uttoxeter

JohnGerman.co.uk Sales and Lettings Agent