

Blacksmiths Avenue

Shepshed, Loughborough, LE12 9SF



John German 

A super starter home, located within a sought after residential development, offering attractive green space, allocated parking and brought to market with no onward chain.

£180,000

John German 

This property would make an ideal purchase for first time buyers professional couples or landlords. The property has an excellent rental history and is currently undergoing works prior to being fully marketed for sale, chain free.

The property is located within close proximity to a wide range of local amenities including (but not limited to); schools, supermarkets shops, boutiques, pubs and restaurant. There are also plenty of green spaces for walking and cycling in the nearby parks.

Public transport well catered for by regular bus service; commuter access to the M1 and A6 is excellent.

Accommodation comprises; two bedrooms, bathroom, lounge and kitchen/diner.

Externally, the garden is of excellent size and very private, offering potential to extend (STPP). Allocated parking is located a short distance away.

To view this property, please contact John German Loughborough office.

Tenure: Freehold (purchasers are advised to satisfy themselves as to the tenure via their legal representative).

Please note: It is quite common for some properties to have a Ring doorbell and internal recording devices.

Property construction: Standard

Parking: Allocated

Electricity supply: Mains

Water supply: Mains

Sewerage: Mains

Heating: Gas

(Purchasers are advised to satisfy themselves as to their suitability).

Broadband type: See Ofcom link for speed: <https://checker.ofcom.org.uk/>

Mobile signal/coverage: See Ofcom link <https://checker.ofcom.org.uk/>

Local Authority/Tax Band: Charnwood Borough Council / Tax Band A

Useful Websites: www.gov.uk/government/organisations/environment-agency

Our Ref: JGA/19092024

The property information provided by John German Estate Agents Ltd is based on enquiries made of the vendor and from information available in the public domain. If there is any point on which you require further clarification, please contact the office and we will be pleased to check the information for you, particularly if contemplating travelling some distance to view the property. Please note if your enquiry is of a legal or structural nature, we advise you to seek advice from a qualified professional in their relevant field.

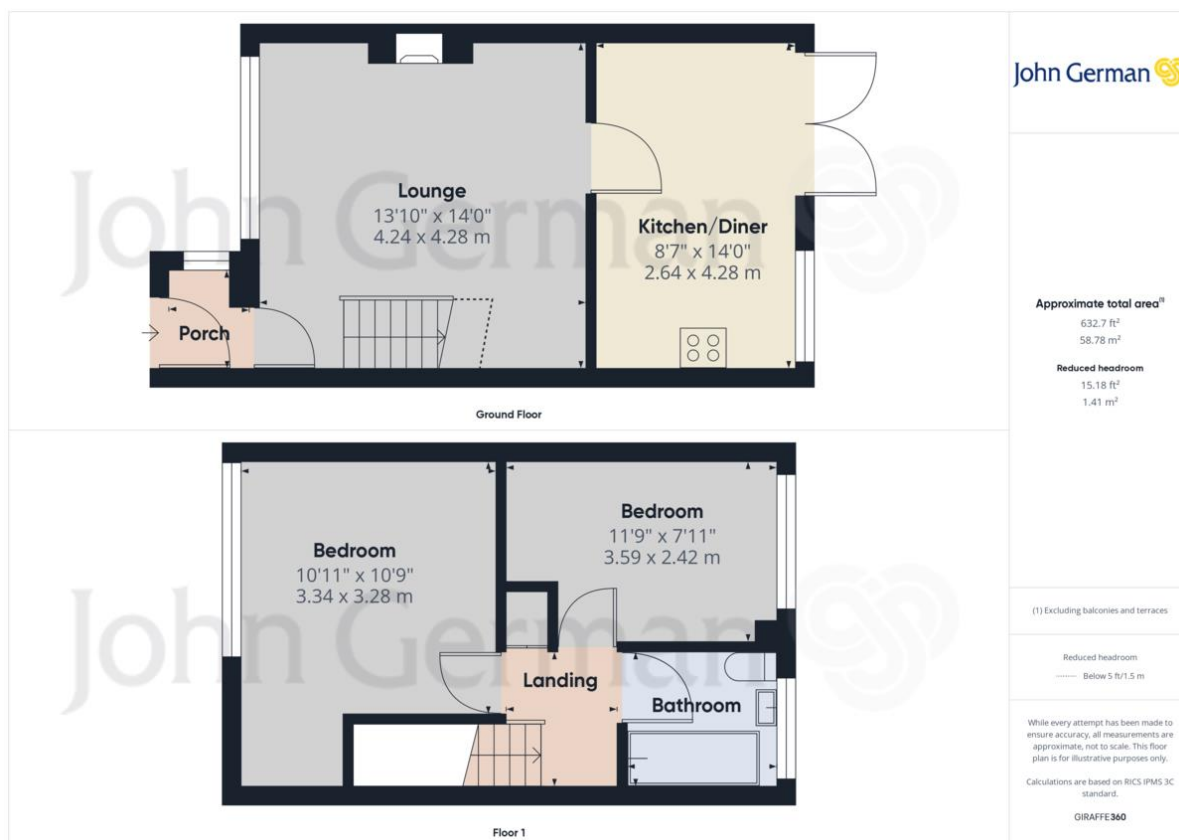





Score	Energy rating	Current	Potential
92+	A		
81-91	B		84 B
69-80	C		
55-68	D	62 D	
39-54	E		
21-38	F		
1-20	G		

John German
 3-5 Bedford Square, Loughborough, Leicestershire, LE11 2TP
 01509 239121
 loughborough@johngerman.co.uk



Agents' Notes

These particulars do not constitute an offer or a contract neither do they form part of an offer or contract. The vendor does not make or give and Messrs. John German nor any person employed has any authority to make or give any representation or warranty, written or oral, in relation to this property. Whilst we endeavour to make our sales details accurate and reliable, if there is any point which is of particular importance to you, please contact the office and we will be pleased to check the information for you, particularly if contemplating travelling some distance to view the property. None of the services or appliances to the property have been tested and any prospective purchasers should satisfy themselves as to their adequacy prior to committing themselves to purchase.

Referral Fees

Mortgage Services - We routinely refer all clients to APR Money Limited. It is your decision whether you choose to deal with APR Money Limited. In making that decision, you should know that we receive on average £60 per referral from APR Money Limited.

Conveyancing Services - If we refer clients to recommended conveyancers, it is your decision whether you choose to deal with this conveyancer. In making that decision, you should know that we receive on average £150 per referral.

Survey Services - If we refer clients to recommended surveyors, it is your decision whether you choose to deal with this surveyor. In making that decision, you should know that we receive up to £90 per referral.

Ashbourne | Ashby de la Zouch | Barton under Needwood
 Burton upon Trent | Derby | East Leake | Lichfield
 Loughborough | Stafford | Uttoxeter

JohnGerman.co.uk Sales and Lettings Agent