

The Callis

Ashby-de-la-Zouch, LE65 2JF



FOR SALE BY AUCTION WEDNESDAY 23RD OCTOBER 2024

A bay fronted, three bedroom semi-detached house situated close to Ashby town centre.

Auction Guide Price £120,000

John German 

Within walking distance of the great range of shops, bars and restaurants in the town centre along with good local schooling.

The property is in need of full modernisation and upgrading and there are signs of some structural movement, however, it offer scope to extend (subject to any required consents) and will make a superb family home.

An ideal potential investment opportunity.

Reception Hallway -

With understairs cupboard and stairs off.

Lounge - 3.65m x 4.19m

With radiator, fireplace and bay window to front.

Dining Room - 3.65m x 3.31m

With radiator and window to rear.

Kitchen - 2.54m x 2.00m

With basic units, sink, radiator and both window and door to side.

Landing -

Bedroom One - 4.17m x 3.36m

With bay window to front aspect.

Bedroom Two - 3.70m x 3.30m

With radiator and window to rear.

Bedroom Three - 2.40m x 2.06m

Having radiator and window to front.

Bathroom -

Comprising low flush WC wash hand basin and panel bath. Part tiled walls and window to rear.

Outside

Driveway to front for small car. Side gated access leads to a large rear garden with brick store and outside WC along with patio and lawns.

Please note:

The property will be sold as seen and not be cleared internally. Prospective buyers are advised to make all necessary independent enquiries prior to placing their bid as this will be binding.

Auction Details:

The sale of this property will take place on the stated date by way of Auction Event and is being sold as Unconditional with Variable Fee (England and Wales).

Binding contracts of sale will be exchanged at the point of sale.

All sales are subject to SDL Property Auctions Buyers Terms. Properties located in Scotland will be subject to applicable Scottish law.

Auction Deposit and Fees:

The following deposits and non-refundable auctioneers fees apply:

- 5% deposit (subject to a minimum of £5,000)

- Buyers Fee of 4.8% of the purchase price for properties sold for up to £250,000, or 3.6% of the purchase price for properties sold for over £250,000 (in all cases, subject to a minimum of £6,000 inc. VAT). For worked examples please refer to the Auction Conduct Guide.

The Buyers Fee does not contribute to the purchase price, however it will be taken into account when calculating the Stamp Duty Land Tax for the property (known as Land and Buildings Transaction Tax for properties located in Scotland), because it forms part of the chargeable consideration for the property.

There may be additional fees listed in the Special Conditions of Sale, which will be available to view within the Legal Pack. You must read the Legal Pack carefully before bidding.

Additional Information:

For full details about all auction methods and sale types please refer to the Auction Conduct Guide which can be viewed on the SDL Property Auctions home page.

This guide includes details on the auction registration process, your payment obligations and how to view the Legal Pack (and any applicable Home Report for residential Scottish properties).

Guide Price & Reserve Price:

Each property sold is subject to a Reserve Price. The Reserve Price will be within + or - 10% of the Guide Price. The Guide Price is issued solely as a guide so that a buyer can consider whether or not to pursue their interest. A full definition can be found within the Buyers Terms.

Note: There are covenants appertaining to this property, a copy of the Land Registry Title is available to view upon request.

Tenure: Freehold (purchasers are advised to satisfy themselves as to the tenure via their legal representative).

Property construction: TBC

Parking: Driveway

Electricity supply: Mains

Water supply: Mains

Sewerage: Mains

Heating: TBC

(Purchasers are advised to satisfy themselves as to their suitability).

Broadband type: O2, EE, Three and Vodafone available

See Ofcom link for speed: <https://checker.ofcom.org.uk/>

Mobile signal/coverage: See Ofcom link <https://checker.ofcom.org.uk/>

Local Authority/Tax Band: North West Leicestershire District Council / Tax Band B

Useful Websites: www.gov.uk/government/organisations/environment-agency

Our Ref: JGA/22072024

The property information provided by John German Estate Agents Ltd is based on enquiries made of the vendor and from information available in the public domain. If there is any point on which you require further clarification, please contact the office and we will be pleased to check the information for you, particularly if contemplating travelling some distance to view the property. Please note if your enquiry is of a legal or structural nature, we advise you to seek advice from a qualified professional in their relevant field.

GROUND FLOOR
622 sq.ft. (57.8 sq.m.) approx.



1ST FLOOR
559 sq.ft. (52.0 sq.m.) approx.

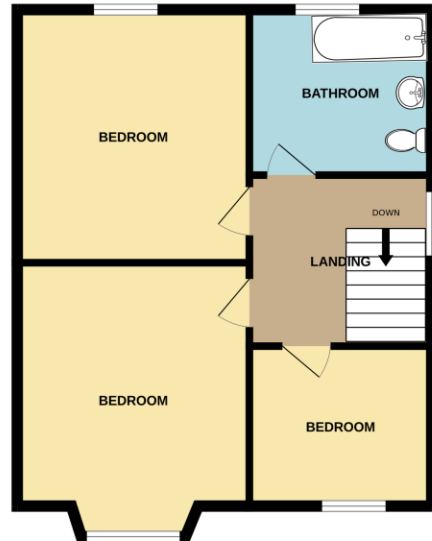

TOTAL FLOOR AREA : 1182 sq.ft. (109.8 sq.m.) approx.

Whilst every attempt has been made to ensure the accuracy of the floorplan contained here, measurements of doors, windows, rooms and any other items are approximate and no responsibility is taken for any error, omission or mis-statement. This plan is for illustrative purposes only and should be used as such by any prospective purchaser. The services, systems and appliances shown have not been tested and no guarantee as to their operability or efficiency can be given.
Made with Metropix 5/2024





AWAITING EPC MEDIA



John German
 63a Market Street, Ashby-De-La-Zouch, Leicestershire,
 LE65 1AH
 01530 412824
 ashbysales@johngerman.co.uk

Agents' Notes

These particulars do not constitute an offer or a contract neither do they form part of an offer or contract. The vendor does not make or give and Messrs. John German nor any person employed has any authority to make or give any representation or warranty, written or oral, in relation to this property. Whilst we endeavour to make our sales details accurate and reliable, if there is any point which is of particular importance to you, please contact the office and we will be pleased to check the information for you, particularly if contemplating travelling some distance to view the property. None of the services or appliances to the property have been tested and any prospective purchasers should satisfy themselves as to their adequacy prior to committing themselves to purchase.

Referral Fees

Mortgage Services - We routinely refer all clients to APR Money Limited. It is your decision whether you choose to deal with APR Money Limited. In making that decision, you should know that we receive on average £60 per referral from APR Money Limited.

Conveyancing Services - If we refer clients to recommended conveyancers, it is your decision whether you choose to deal with this conveyancer. In making that decision, you should know that we receive on average £150 per referral.

Survey Services - If we refer clients to recommended surveyors, it is your decision whether you choose to deal with this surveyor. In making that decision, you should know that we receive up to £90 per referral.

Ashbourne | Ashby de la Zouch | Barton under Needwood
 Burton upon Trent | Derby | East Leake | Lichfield
 Loughborough | Stafford | Uttoxeter

JohnGerman.co.uk Sales and Lettings Agent