

FOR SALE



Torvaine Park, Lower Parkstone
£240,000

MARTIN & CO

Torvaine Park, Lower Parkstone

£240,000

- Attractive Lower Parkstone location
- allocated parking & lift
- service charge £1200 pa
- remaining lease 105 years
- ***SHARE OF FREEHOLD***
- Council tax band C' - £1909 pa

Introducing this charming first floor apartment in Lower Parkstone, now available for sale with no forward chain. Boasting a share of freehold, this well-presented property offers a fantastic opportunity to own a piece of this sought-after area. Situated within walking distance to Ashley Cross and conveniently located on main bus routes, this property is perfect for those looking for a vibrant and convenient lifestyle. You'll also love the proximity to St Peters church and the delightful nearby places to explore.



ENTRANCE HALL Inset spotlights, secure entrance phone, cupboard, radiator.

LIVING ROOM 15' 8" x 13' 3" (4.78m x 4.05m) Inset spotlights, double glazed window to front aspect allowing pleasant views of mature trees & shrubs in private grounds & beyond, radiator.

KITCHEN 9' 8" x 6' 9" (2.97m x 2.08m) Inset spotlights, double glazed window to side aspect, wall & base units with worktop over. Tiled splashbacks, stainless steel cooker hood, gas hob & electric oven. Washer/dryer & slimline dishwasher included, along with fridge/freezer, laminate flooring.

MASTER BEDROOM 9' 7" x 9' 0" (2.94m x 2.75m) Central ceiling light, double glazed window to rear aspect, fitted wardrobes with sliding doors, radiator.

BEDROOM TWO 10' 1" x 9' 1" (3.08m x 2.77m) Central ceiling light, double glazed window to front aspect, radiator.

BATHROOM 9' 6" x 5' 2" (2.92m x 1.60m) inset spotlights, extractor fan, bath with shower attachment over, vanity unit with inset basin, w/c. Large wall mounted mirror over vanity unit, walls mainly tiled, tiled flooring.

PARKING Allocated space, with additional visitor's spaces available on a first come, first served basis.



Score	Energy rating	Current	Potential
92+	A		
81-91	B	82 B	82 B
69-80	C		
55-68	D		
39-54	E		
21-38	F		
1-20	G		



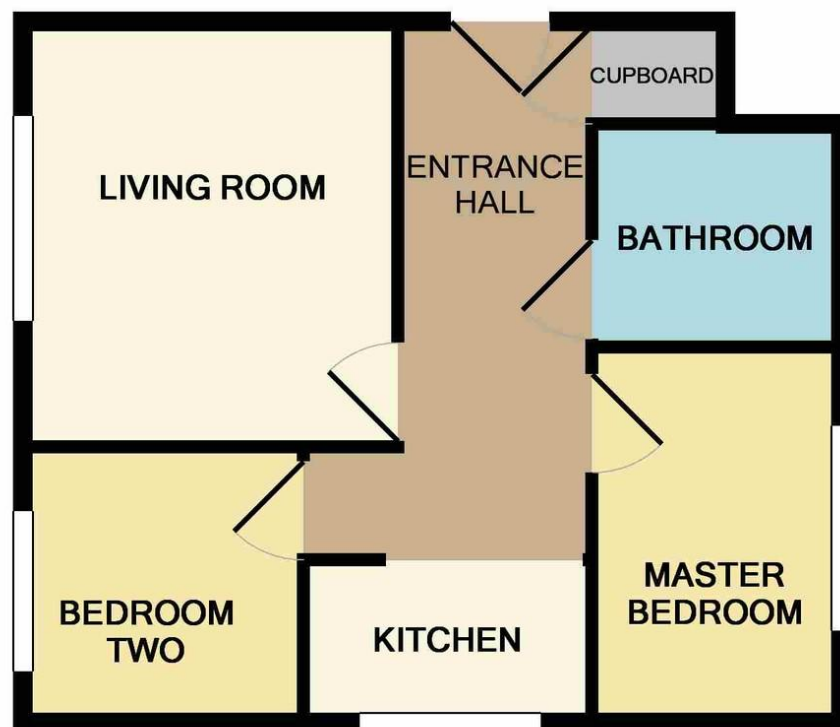

Whilst every attempt has been made to ensure the accuracy of the floor plan contained here, measurements of doors, windows, rooms and any other items are approximate and no responsibility is taken for any error, omission, or mis-statement. This plan is for illustrative purposes only and should be used as such by any prospective purchaser. The services, systems and appliances shown have not been tested and no guarantee as to their operability or efficiency can be given
 Made with Metropix ©2017

Martin & Co Poole

109 Commercial Road • • Poole • BH14 0JD
 T: 01202 710171 • E: poole@martinco.com

01202 710171

<http://www.poole.martinco.com>



Accuracy: References to the Tenure of a Property are based on information supplied by the Seller. The Agent has not had sight of the title documents. A Buyer is advised to obtain verification from their Solicitor. Items shown in photographs including but not limited to carpets, fixtures and fittings are not included unless specifically mentioned within the sales particulars. They may however be available by separate negotiation. Buyers must check the availability of any property and make an appointment to view before embarking on any journey to see a property. No person in the employment of the agent has any authority to make any representation about the property, and accordingly any information given is entirely without responsibility on the part of the agents, sellers(s) or lessors(s). Any property particulars are not an offer or contract, nor form part of one. **Sonic / Laser Tape:** Measurements taken using a sonic / laser tape measure may be subject to a small margin of error. **All Measurements:** All Measurements are Approximate. **Services Not tested:** The Agent has not tested any apparatus, equipment, fixtures and fittings or services and so cannot verify that they are in working order or fit for the purpose. A Buyer is advised to obtain verification from their Solicitor or Surveyor.