

FOR SALE



Middlebrook, 1725 Wimborne Road, Bournemouth
£325,000

MARTIN&CO

Middlebrook, 1725 Wimborne Road, Bournemouth

- council tax band 'D' = £2147
- 60 square metres
- ***NO FORWARD CHAIN***
- cul de sac location
- enclosed rear garden

Introducing this detached modern bungalow nestled in a peaceful cul de sac location in Kinson, Bournemouth. Perfectly positioned for convenience, with main bus routes to Castlepoint and large supermarkets nearby, as well as a variety of local amenities just a stone's throw away. This well-maintained property boasts two bedrooms, (one with an ensuite), providing ample space for comfortable living. The bright and airy conservatory offers a peaceful retreat, overlooking the enclosed rear garden with a covered side patio - ideal for entertaining guests or simply relaxing in the sunshine. With a carport and garage providing ample parking and outside space, this property is designed for modern living with no forward chain.

ENTRANCE HALL Ceiling light, large cupboard with shelving, vinyl flooring.

LOUNGE/DINER Ceiling light, large sliding patio doors opening into the conservatory. Electric fire, with marble hearth & surround. Radiator.

CONSERVATORY UPVC conservatory with brick base, ideal for admiring the garden & enjoying the morning sunshine! Two doors opening into the garden, ceiling light with power points.



KITCHEN Two ceiling lights, two double glazed window to front aspect with UPVC stable door leading to the side patio. Range of wall & base units with worktop over & tiled splashbacks, space & plumbing for washing machine, electric cooker, fridge & freezer. Radiator, wall mounted 'Worcester' boiler.

MASTER BEDROOM Double glazed window to rear aspect overlooking the mature garden, with built in furniture, including wardrobes & cupboards.

ENSUITE Ceiling light, double glazed window to rear aspect. Enclosed shower cubicle with tiled splashbacks, toilet & basin. Extractor fan & radiator.

BEDROOM TWO Double glazed window to front aspect, built in bedroom furniture including wardrobes & cupboards. Radiator.

REAR GARDEN Enclosed rear garden, surround by mature trees, hedging & shrubs, laid to paving stone & gravelled areas. Further covered side patio accessed from the kitchen.

SHOWER ROOM Ceiling light, loft hatch, extractor fan. Large shower cubicle with screen, toilet & basin, radiator.

COVERED & PAVED SIDE PATIO This useful space is accessed via the kitchen through the stable door, or via a path from the garden, ideal for outside dining, storage, or for children to play! Gate to covered car port.

PARKING & GARAGE Garage with up & over door, the car port & two further allocated spaces.



| Energy Efficiency Rating | | Current | Potential |
|---|----------|-------------------------|-----------|
| Very energy efficient - lower running costs | | | |
| (92-100) | A | | |
| (81-91) | B | | 84 |
| (69-80) | C | | |
| (55-68) | D | 66 | |
| (39-54) | E | | |
| (21-38) | F | | |
| (1-20) | G | | |
| Not energy efficient - higher running costs | | | |
| England, Scotland & Wales | | EU Directive 2002/91/EC | |

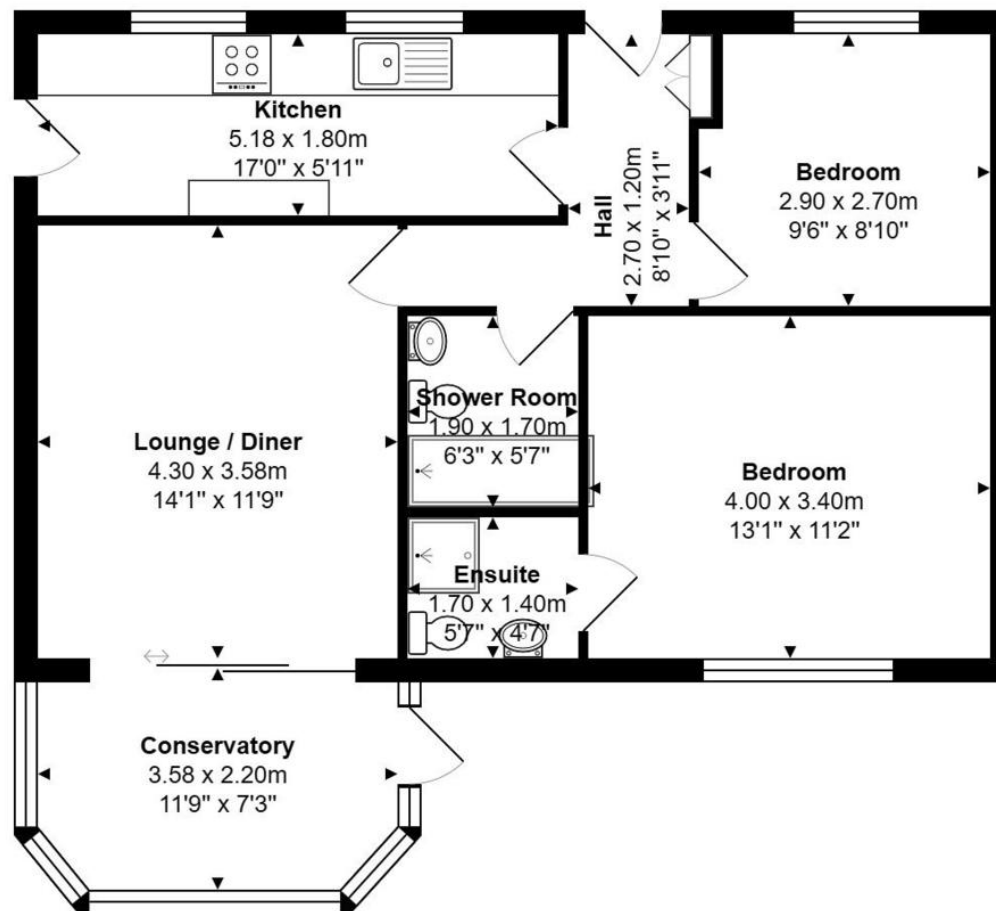

Martin & Co Poole

109 Commercial Road • • Poole • BH14 0JD
 T: 01202 710171 • E: poole@martinco.com

01202 710171

<http://www.poole.martinco.com>



Accuracy: References to the Tenure of a Property are based on information supplied by the Seller. The Agent has not had sight of the title documents. A Buyer is advised to obtain verification from their Solicitor. Items shown in photographs including but not limited to carpets, fixtures and fittings are not included unless specifically mentioned within the sales particulars. They may however be available by separate negotiation. Buyers must check the availability of any property and make an appointment to view before embarking on any journey to see a property. No person in the employment of the agent has any authority to make any representation about the property, and accordingly any information given is entirely without responsibility on the part of the agents, sellers(s) or lessors(s). Any property particulars are not an offer or contract, nor form part of one. **Sonic / Laser Tape:** Measurements taken using a sonic / laser tape measure may be subject to a small margin of error. **All Measurements:** All Measurements are Approximate. **Services Not tested:** The Agent has not tested any apparatus, equipment, fixtures and fittings or services and so cannot verify that they are in working order or fit for the purpose. A Buyer is advised to obtain verification from their Solicitor or Surveyor.

