



2 Sainsbury Close, Andover, SP10 2LE
Guide Price £550,000



2 Sainsbury Close, Andover, Guide Price £550,000

PROPERTY DESCRIPTION BY Mr Wayne Turpin

Tucked away in a sought after location with stunning views and gardens set in a tranquil riverside setting, Graham & Co are delighted to bring to the market this four bedroom detached family home offered for sale with NO CHAIN. The property benefits from a front driveway and garden, an entrance hall with cloaks/shower room, sitting room with views to front, conservatory and an open plan newly fitted kitchen with dining area, utility/store (originally the garage). To the first floor there are four bedrooms and a bathroom, gas central heating and double glazing. The lovely well stocked back garden, leads down to the river, with beautiful views. Very rarely do properties become available in this such sought after location so early viewing is highly recommended





Andover offers a good range of shopping and recreational facilities including a theatre, cinema, new leisure centre, excellent selection of schools and a college for higher education. An abundance of open space and land with a selection of local nature reserve's all within walking distance of the town centre. The town itself boasts a lovely "market town" feel and everything you may need is close at hand. The mainline train station offers a fast service to London Waterloo in just over an hour, and the A303 gives access to London via the M3 and the West Country.





APPROXIMATE GROSS INTERNAL AREA = 1331 SQ FT / 123.6 SQ M
SUMMER HOUSE / SHED = 94 SQ FT / 8.7 SQ M
TOTAL = 1425 SQ FT / 132.3 SQ M

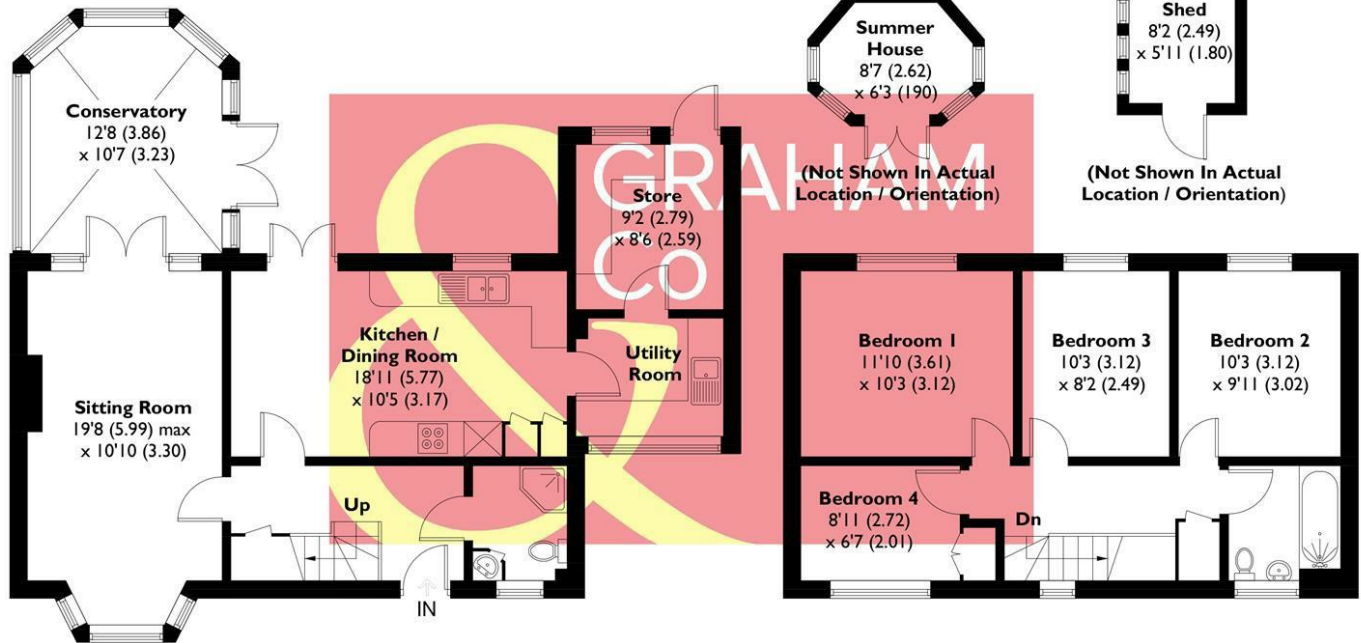

GROUND FLOOR
814 SQ FT / 75.6 SQ M

FIRST FLOOR
517 SQ FT / 48.0 SQ M

This plan is for layout guidance only. Not drawn to scale unless stated. Windows and door openings are approximate. Whilst every care is taken in the preparation of this plan, please check all dimensions, shapes and compass bearings before making any decisions reliant upon them. Created by Emzo Marketing (ID1271212)
Produced for Graham & Co

MORTGAGE ADVICE Across The Market Mortgages

An independent Mortgage brokerage offering expert advice from across the whole market. Whether you are a first-time buyer, home mover, remortgaging or buying a Buy-To-Let investment. Tristan can provide expert & reliable advice, in a clear jargon free language. Book a free consultation today.

E - tristan@atmmortgages.com M - 07545320380

www.atmmortgages.com

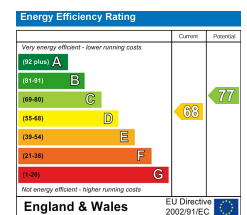

Tax Band: E



OPEN 7 DAYS

If you are considering selling your home
 please contact us today for your free
 no obligation valuation

01264 356500

IMPORTANT: we would like to inform prospective purchasers that these sales particulars have been prepared as a general guide only. A detailed survey has not been carried out, nor the services, appliances and fittings tested. Room sizes should not be relied upon for furnishing purposes and are approximate. If floor plans are included, they are for guidance only and illustration purposes only and may not be to scale. If there are any important matters likely to affect your decision to buy, please contact us before viewing the property.

