



16 Lawrence Houses, Andover, SP11 8JX
Asking Price £185,000

PROPERTY DESCRIPTION BY *Mr Guy Sommerville*

Tucked away in a quiet position within the desirable village of Grateley, this two-bedroom mid-terraced bungalow presents an excellent opportunity for buyers seeking a home to update and personalise. Offered with no onward chain and ready for a swift completion, this property is ideal for down-sizers, investors, or first-time buyers alike. The accommodation comprises an entrance hall leading to two well-proportioned bedrooms – one overlooking the front and the other enjoying views to the rear garden. A comfortable living room provides a cosy space to relax, while the kitchen features a window overlooking the garden and offers potential for modernisation. Outside, the property benefits from a front garden, gated side access, and a rear garden complete with a brick-built storage shed. The tranquil setting adds to the appeal, offering a peaceful lifestyle within this charming village.



APPROXIMATE GROSS INTERNAL AREA = 626 SQ FT / 58.2 SQ M
STORE = 50 SQ FT / 4.7 SQ M
TOTAL = 676 SQ FT / 62.9 SQ M

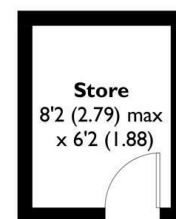
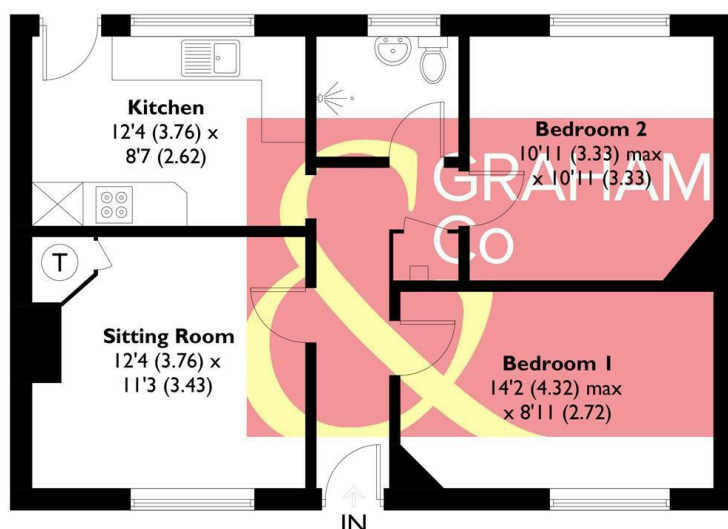

(Not Shown In Actual
Location / Orientation)

GROUND FLOOR
626 SQ FT / 58.2 SQ M

This plan is for layout guidance only. Not drawn to scale unless stated. Windows and door openings are approximate. Whilst every care is taken in the preparation of this plan, please check all dimensions, shapes and compass bearings before making any decisions reliant upon them. Created by Emzo Marketing (ID1246464)

Produced for Graham & Co

DIRECTIONS

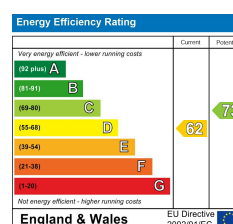

Tax Band: C



OPEN 7 DAYS

If you are considering selling your home
 please contact us today for your free
 no obligation valuation

01264 356500

IMPORTANT: we would like to inform prospective purchasers that these sales particulars have been prepared as a general guide only. A detailed survey has not been carried out, nor the services, appliances and fittings tested. Room sizes should not be relied upon for furnishing purposes and are approximate. If floor plans are included, they are for guidance only and illustration purposes only and may not be to scale. If there are any important matters likely to affect your decision to buy, please contact us before viewing the property.