



19 Flitches Grove, Andover, SP10 3GT
Asking Price £104,025



19 Flitches Grove, Andover, Asking Price £104,025

PROPERTY DESCRIPTION BY Mr Ross Beeden

Graham & Co are delighted to offer to the market a spacious two bedroom ground floor apartment for sale under the shared ownership scheme at a 57% share of the full price under ABRI Housing. The property has plenty of storage with further accommodation comprising of an open plan lounge leading to a modern fitted kitchen, two bedrooms, bathroom, storage/bike shed and an allocated parking space.

Full Price: £182,500

Share Price: 57% £104,025

Estimated Monthly Cost: £845

Rent £147

Service Charge £133

Mortgage £565

Share percentage 57%, full price £182,500, £5,201 Min Deposit. Calculated using a representative rate of 4.78%





Andover offers a good range of shopping and recreational facilities including a theatre, cinema, new leisure centre, excellent selection of schools and a college for higher education. An abundance of open space and land with a selection of local nature reserve's all within walking distance of the town centre. The town itself boast a lovely "market town" feel and everything you may need is close at hand. The mainline train station offers a fast service to London Waterloo in just over an hour, and the A303 gives access to London via the M3 and the West Country.



Flitches Grove, SP10

Approximate Gross Internal Area = 68.8 sq m / 740 sq ft

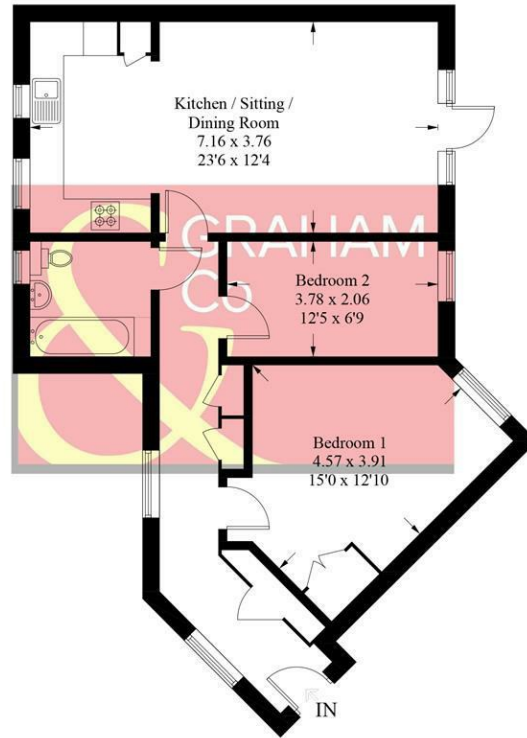

Ground Floor

PRODUCED FOR GRAHAM AND CO

Whilst every attempt has been made to ensure the accuracy of the floorplan, measurements of doors, windows and rooms are approximate. These plans are for representation purposes only as defined by RICS Code of Measuring Practice and used as such by any prospective purchaser. © Emzo Marketing (ID712358)

MORTGAGE ADVICE

Across The Market Mortgages

An independent Mortgage brokerage offering expert advice from across the whole market. Whether you are a first-time buyer, home mover, remortgaging or buying a Buy-To-Let investment. Tristan can provide expert & reliable advice, in a clear jargon free language. Book a free consultation today.

E - tristan@atmmortgages.com M - 07545320380

www.atmmortgages.com

Energy Efficiency Rating		
	Current	Potential
Very energy efficient - lower running costs		
(95 plus) A		
(81-94) B	82	82
(69-80) C		
(55-68) D		
(43-54) E		
(31-42) F		
(1-30) G		
Not energy efficient - higher running costs		
England & Wales EU Directive 2002/91/EC		

Tax Band: B



OPEN 7 DAYS

If you are considering selling your home please contact us today for your free no obligation valuation

01264 356500

IMPORTANT: we would like to inform prospective purchasers that these sales particulars have been prepared as a general guide only. A detailed survey has not been carried out, nor the services, appliances and fittings tested. Room sizes should not be relied upon for furnishing purposes and are approximate. If floor plans are included, they are for guidance only and illustration purposes only and may not be to scale. If there are any important matters likely to affect your decision to buy, please contact us before viewing the property.