



12 Harebell Road, Andover, SP11 6RG  
Guide Price £365,000





12 Harebell Road, Andover,  
Guide Price £365,000

#### PROPERTY DESCRIPTION BY Mr Ross Beeden

Nestled in a peaceful setting close to open green spaces, this well-presented home offers comfortable and practical living across three floors. The property enjoys a lovely position with access to nearby countryside walks, making it ideal for those who appreciate a quieter, more natural environment.

The ground floor features an entrance hall, a fitted kitchen, and a spacious lounge/diner with French doors opening out to the garden, allowing plenty of natural light. On the first floor, there is a landing leading to two bedrooms and a Jack and Jill bathroom. Bedroom two benefits from built-in wardrobes, a Juliet balcony, and direct access to the bathroom.

The top floor is dedicated to the master bedroom, which includes built-in storage and a private en suite shower room.

Outside, the property enjoys a low-maintenance, south-facing garden, perfect for catching the sun throughout the day. Additional benefits include allocated parking and a garage.

This is a lovely home in a desirable location, offering a balance of comfort and convenience with the bonus of nearby green spaces.







Situated in the sought-after Augusta Park development in Andover, this well-presented home offers comfortable living within a vibrant community. Families will appreciate the proximity to Endeavour Primary School and Adventure Pre-School, both located within the development. The area boasts a range of amenities, including a Co-operative Food store on East Anton Farm Road , with plans for a new convenience store on Dairy Road scheduled for completion in December 2025 . Residents can enjoy green open spaces, play areas, and walking routes, making it ideal for outdoor activities. The Augusta Park Community Centre serves as a hub for various events and classes, fostering a strong sense of community. With convenient access to the A303 and Andover town centre, Augusta Park combines peaceful surroundings with excellent connectivity





## Harebell Road, SP11

Approximate Gross Internal Area = 101.2 sq m / 1089 sq ft  
Garage = 18.1 sq m / 195 sq ft  
Total = 119.3 sq m / 1284 sq ft

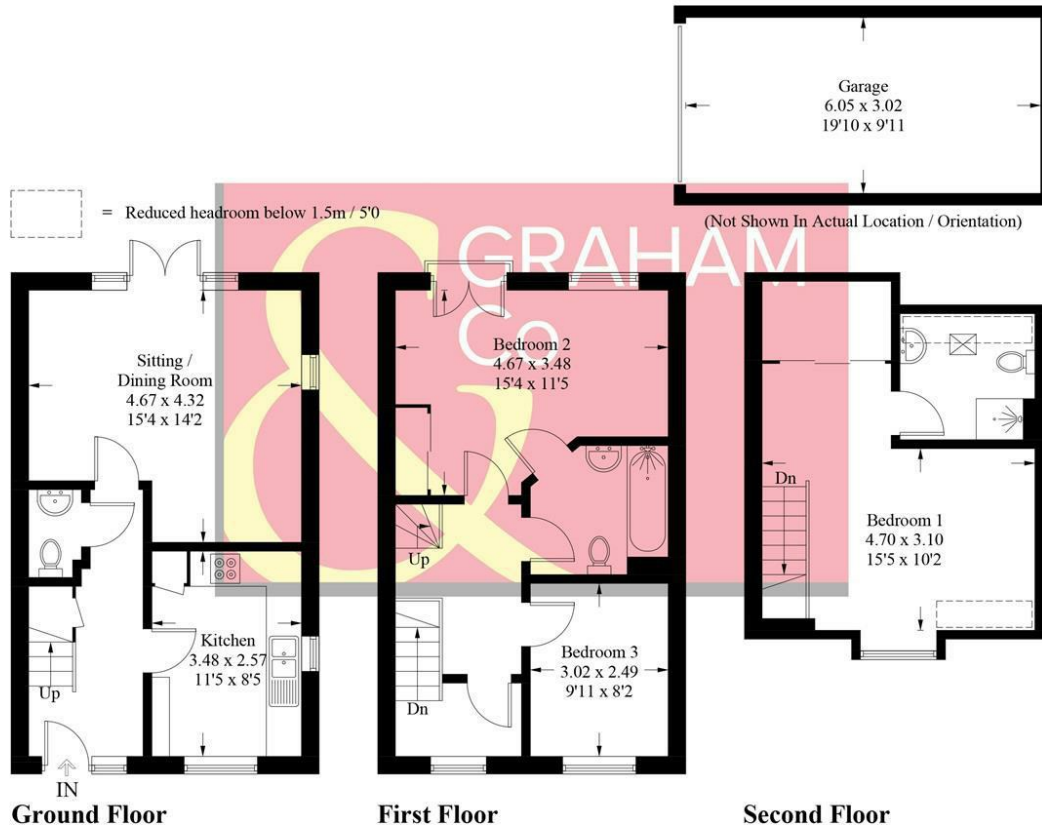

PRODUCED FOR GRAHAM AND CO

Whilst every attempt has been made to ensure the accuracy of the floorplan, measurements of doors, windows and rooms are approximate. These plans are for representation purposes only as defined by RICS Code of Measuring Practice and used as such by any prospective purchaser. © Emzo Marketing (ID1204231)

### MORTGAGE ADVICE

#### Across The Market Mortgages

An independent Mortgage brokerage offering expert advice from across the whole market. Whether you are a first-time buyer, home mover, remortgaging or buying a Buy-To-Let investment. Tristan can provide expert & reliable advice, in a clear jargon free language. Book a free consultation today.

E - [tristan@atmmortgages.com](mailto:tristan@atmmortgages.com) M - 07545320380

[www.atmmortgages.com](http://www.atmmortgages.com)

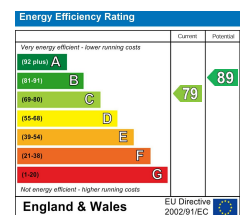

Tax Band: D



OPEN 7 DAYS

If you are considering selling your home  
please contact us today for your free  
no obligation valuation

**01264 356500**

IMPORTANT: we would like to inform prospective purchasers that these sales particulars have been prepared as a general guide only. A detailed survey has not been carried out, nor the services, appliances and fittings tested. Room sizes should not be relied upon for furnishing purposes and are approximate. If floor plans are included, they are for guidance only and illustration purposes only and may not be to scale. If there are any important matters likely to affect your decision to buy, please contact us before viewing the property.