



Hennings Studio, 10A Ox Drove, Picket Piece, Andover, SP11  
6ND  
Guide Price £650,000





## Hennings Studio, 10A Ox Drove, Picket Piece Andover, Guide Price £650,000

### PROPERTY DESCRIPTION BY Mr Wayne Turpin

Graham & Co are delighted to bring to the market this stunning detached family home offered for sale in pristine condition throughout with the added advantage of a double garage/workshop and several out buildings/stables. The property itself offers well planned accommodation over two floors to include an entrance hall with cloakroom, spacious sitting room with views to front and double doors to side, modern fitted kitchen and a family/dining room with double doors leading to the rear garden. To the first floor there are three bedrooms and a modern fitted spacious bathroom, central heating and double glazing. Outside the grounds are L-Shaped and of good size with a sweeping driveway leading to the front and side, gardens with patio and lawn, a double garage with workshop and store further stabling/workshops and stores offering great potential.







The property is situated in the Ox Drove, a quiet residential lane, located on the eastern outskirts of Andover. There is a nearby village hall, public house with restaurant, camping facilities and a golf driving range. The town of Andover offers a comprehensive range of shopping, leisure and educational facilities, as well as a main line railway station providing fast services to London (Waterloo) in just over an hour. The A303 is close at hand allowing convenient road access to London and the West Country. The nearby town of Whitchurch is located within a ten minute drive and also has a mainline railway station.





## Ox Drove, SP11

Approximate Gross Internal Area = 138.9 sq m / 1495 sq ft  
Outbuildings = 75.9 sq m / 817 sq ft  
Total = 214.8 sq m / 2312 sq ft

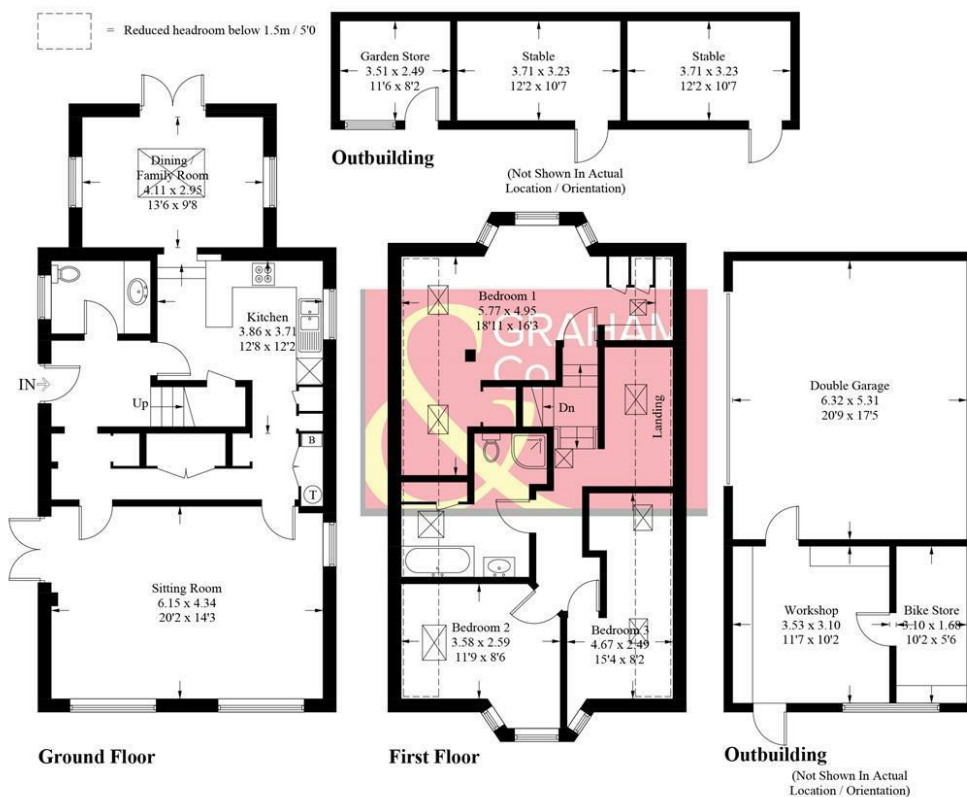

PRODUCED FOR GRAHAM AND CO

Whilst every attempt has been made to ensure the accuracy of the floorplan, measurements of doors, windows and rooms are approximate. These plans are for representation purposes only as defined by RICS Code of Measuring Practice and used as such by any prospective purchaser. © Emzo Marketing (ID1178547)

## MORTGAGE ADVICE

### Across The Market Mortgages

An independent Mortgage brokerage offering expert advice from across the whole market. Whether you are a first-time buyer, home mover, remortgaging or buying a Buy-To-Let investment. Tristan can provide expert & reliable advice, in a clear jargon free language. Book a free consultation today.

E - [tristan@atmmortgages.com](mailto:tristan@atmmortgages.com) M - 07545320380

[www.atmmortgages.com](http://www.atmmortgages.com)

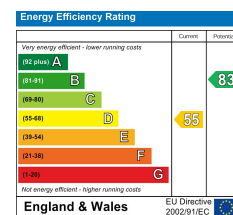

Tax Band: D



OPEN 7 DAYS

If you are considering selling your home  
please contact us today for your free  
no obligation valuation

**01264 356500**

IMPORTANT: we would like to inform prospective purchasers that these sales particulars have been prepared as a general guide only. A detailed survey has not been carried out, nor the services, appliances and fittings tested. Room sizes should not be relied upon for furnishing purposes and are approximate. If floor plans are included, they are for guidance only and illustration purposes only and may not be to scale. If there are any important matters likely to affect your decision to buy, please contact us before viewing the property.