



East Elevation



Plots Western Road, Andover, SP10 2JQ
Asking Price £295,000

PROPERTY DESCRIPTION BY *Mr Guy Sommerville*

Plots offered for sale with planning permission to build two detached dwellings. Located just outside Andover town centre and within easy reach of the main line train station and access to the A303. Full details and documents are available on the Test Valley planning website with ref no: 19/01098/FULLN.

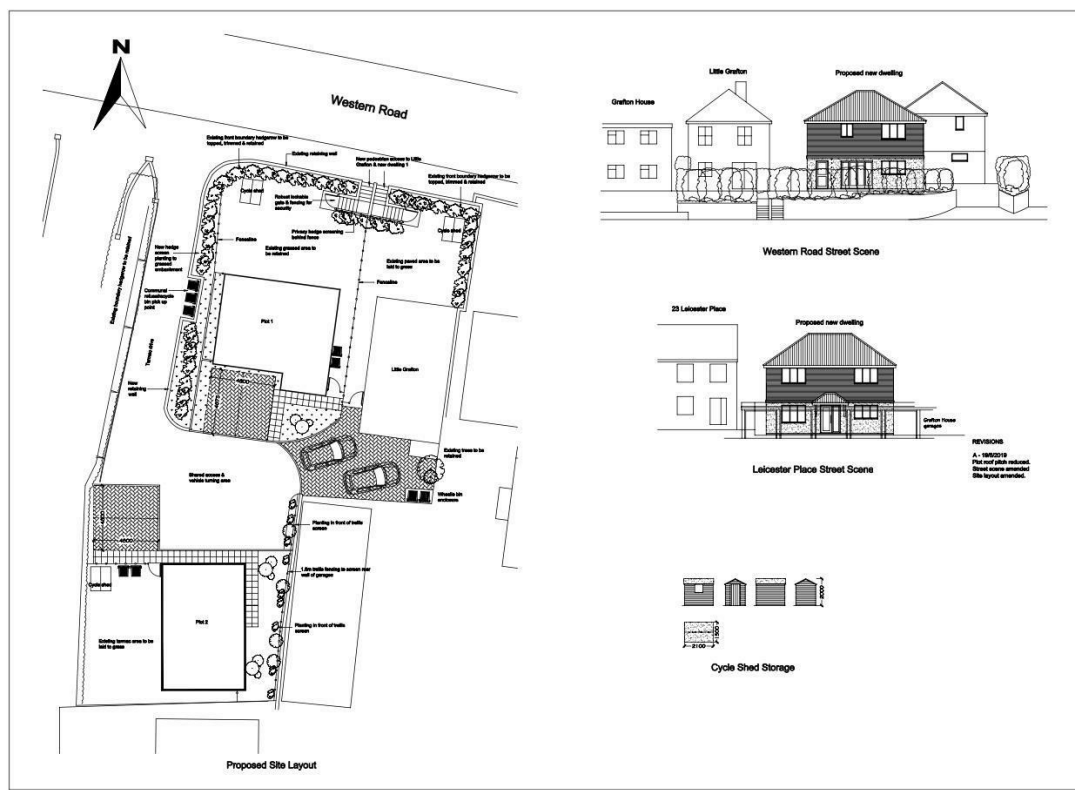

DIRECTIONS

From our office in London Street proceed to the roundabout, take the third exit. At the next roundabout follow the road round in the left hand lane into The Broadway/Western Road. The property can be found on the left hand side just before Blue Hayes Close.

Tax Band:



OPEN 7 DAYS

If you are considering selling your home please contact us today for your free no obligation valuation

01264 356500

IMPORTANT: we would like to inform prospective purchasers that these sales particulars have been prepared as a general guide only. A detailed survey has not been carried out, nor the services, appliances and fittings tested. Room sizes should not be relied upon for furnishing purposes and are approximate. If floor plans are included, they are for guidance only and illustration purposes only and may not be to scale. If there are any important matters likely to affect your decision to buy, please contact us before viewing the property.