



3 Timothys Field, Abbots Ann, Andover, SP11 7AT
80% Shared ownership £284,000



3 Timothys Field, Abbots Ann Andover,
80% Shared ownership £284,000

PROPERTY DESCRIPTION BY Mr Guy Sommerville

Welcome to this charming cottage-style home nestled in the picturesque village of Abbots Ann, built in the early 2000s by a renowned local developer celebrated for their timeless cottage designs. This delightful property exudes character and warmth, offering a perfect blend of modern comfort and classic charm, providing peace of mind without the worries of owning an older property. As you step inside, you're greeted by a cozy living room adorned with a window to the front, inviting in natural light and providing a welcoming ambiance. The heart of the home lies in the kitchen dining room located to the rear, featuring a window and door that open onto the enchanting rear garden. Designed with low maintenance in mind, the garden boasts flowering bedded borders, offering bursts of colour throughout the seasons. A patio seating area provides an idyllic spot to soak up the sun's rays, while a convenient garden shed offers storage for outdoor essentials. Convenience is key with a downstairs toilet, adding practicality to the ground floor. Ascend to the first floor where two well-appointed bedrooms await, offering peaceful retreats for rest and relaxation. A beautifully designed bathroom completes the accommodation, providing a tranquil space to unwind after a long day. Situated in the heart of Abbots Ann, this home enjoys a beautiful village setting just a stone's throw away from the village primary school, the local pub, and the village-run shop. With 80% shared ownership, this property offers an affordable opportunity to own a piece of village life, with English Rural Housing Association owning the remaining 20%. The monthly rent of £159 includes both rent and building insurance. Don't miss the chance to make this charming cottage your own and experience the quintessential village lifestyle in Abbots Ann. Schedule a viewing today and immerse yourself in the allure of this enchanting home.





Abbots Ann is a picturesque village offering primary school, two public houses, church and a thriving village hall community and has many country walks nearby. Andover itself offers an ever improving range of shopping and leisure facilities. Many of the outlying areas and villages are classed as areas of outstanding natural beauty. There are also excellent road and rail links to London and the west country.



Timothys Field, SP11

Approximate Gross Internal Area = 69.8 sq m / 751 sq ft

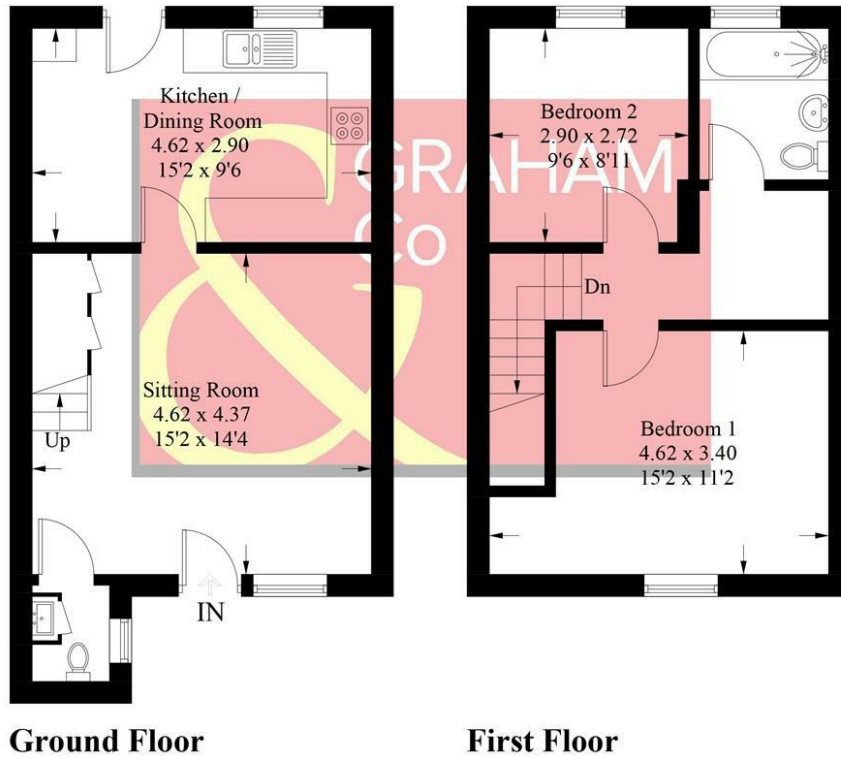

PRODUCED FOR GRAHAM AND CO

Whilst every attempt has been made to ensure the accuracy of the floorplan, measurements of doors, windows and rooms are approximate. These plans are for representation purposes only as defined by RICS Code of Measuring Practice and used as such by any prospective purchaser. © Emzo Marketing (ID1070407)

MORTGAGE ADVICE Across The Market Mortgages

An independent Mortgage brokerage offering expert advice from across the whole market. Whether you are a first-time buyer, home mover, remortgaging or buying a Buy-To-Let investment. Tristan can provide expert & reliable advice, in a clear jargon free language. Book a free consultation today.

E - tristan@atmmortgages.com M - 07545320380

www.atmmortgages.com

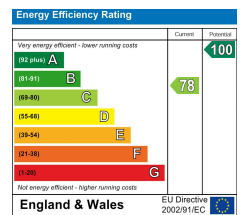

Tax Band: D



OPEN 7 DAYS

If you are considering selling your home please contact us today for your free no obligation valuation

01264 356500

IMPORTANT: we would like to inform prospective purchasers that these sales particulars have been prepared as a general guide only. A detailed survey has not been carried out, nor the services, appliances and fittings tested. Room sizes should not be relied upon for furnishing purposes and are approximate. If floor plans are included, they are for guidance only and illustration purposes only and may not be to scale. If there are any important matters likely to affect your decision to buy, please contact us before viewing the property.