



Flat 1, Waverley Buildings Waterloo Court, Andover, SP10  
1QJ  
Guide Price £127,500



## Flat 1, Waverley Buildings Waterloo Court, Andover, Guide Price £127,500

### PROPERTY DESCRIPTION BY Mr Wayne Turpin

Graham & Co are delighted to bring to the market this spacious and well presented first floor apartment positioned in the heart of Andover town centre with its array of shops, restaurants and bars. The property itself benefits from an entrance leading to the first floor, open living room leading to a well equipped fully fitted kitchen, double bedroom with fitted double bedroom and separate bathroom, gas central heating and double glazing. NO CHAIN.





Andover offers a good range of shopping and recreational facilities including a theatre, cinema, new leisure centre, excellent selection of schools and a college for higher education. An abundance of open space and land with a selection of local nature reserve's all within walking distance of the town centre. The town itself boast a lovely "market town" feel and everything you may need is close at hand. The mainline train station offers a fast service to London Waterloo in just over an hour, and the A303 gives access to London via the M3 and the West Country.



# Waterloo Court, SP10

Approximate Gross Internal Area = 42.7 sq m / 460 sq ft

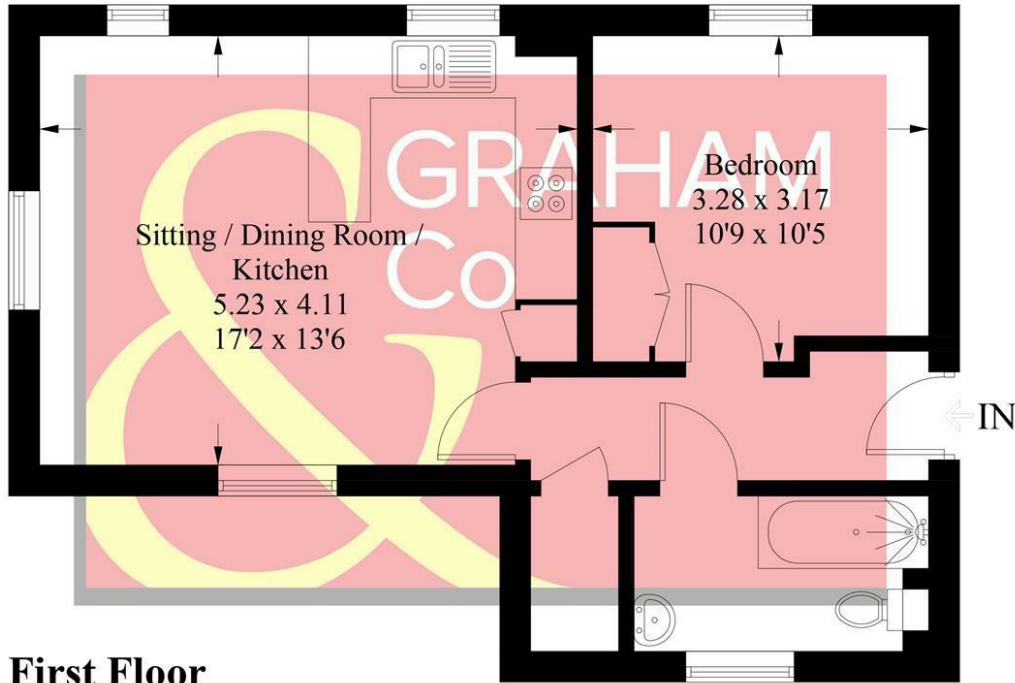

**First Floor**

PRODUCED FOR GRAHAM AND CO

Whilst every attempt has been made to ensure the accuracy of the floorplan, measurements of doors, windows and rooms are approximate. These plans are for representation purposes only as defined by RICS Code of Measuring Practice and used as such by any prospective purchaser. © Emzo Marketing (ID1045656)

## MORTGAGE ADVICE Across The Market Mortgages

An independent Mortgage brokerage offering expert advice from across the whole market. Whether you are a first-time buyer, home mover, remortgaging or buying a Buy-To-Let investment. Tristan can provide expert & reliable advice, in a clear jargon free language. Book a free consultation today.

E - [tristan@atmmortgages.com](mailto:tristan@atmmortgages.com) M - 07545320380

[www.atmmortgages.com](http://www.atmmortgages.com)

Energy Efficiency Rating		Current	Potential
Very energy efficient - lower running costs			
(95 plus)	A		
(81-91)	B		
(69-80)	C	74	74
(55-68)	D		
(39-54)	E		
(21-38)	F		
(1-20)	G		
Not energy efficient - higher running costs			
England & Wales		EU Directive 2002/91/EC	

Tax Band: A



**OPEN 7 DAYS**

If you are considering selling your home please contact us today for your free no obligation valuation

**01264 356500**

IMPORTANT: we would like to inform prospective purchasers that these sales particulars have been prepared as a general guide only. A detailed survey has not been carried out, nor the services, appliances and fittings tested. Room sizes should not be relied upon for furnishing purposes and are approximate. If floor plans are included, they are for guidance only and illustration purposes only and may not be to scale. If there are any important matters likely to affect your decision to buy, please contact us before viewing the property.