



Wydene, Peelings Lane, Westham, Pevensey, BN24 5HG

Guide Price £595,000 - £610,000 | Freehold

LS Leaper
Stanbrook

TOWN CENTRE OFFICE
01323 416716

MEADS STREET OFFICE
01323 737962

An outstanding three bedroom detached house located on a quiet lane in a semi-rural position in the historic village of Westham, although secluded the property is within close proximity to Westham village high street, train station and boasts countryside views and large gardens. This delightful property has many features and benefits and enjoys accommodation comprising entrance hall, sitting room, kitchen with a range of floor and base units, breakfast bar opening into the large conservatory/family room overlooking the rear garden. There is a ground floor bathroom, ground floor bedroom and there are two further bedrooms to the first floor. The property is set well back from the road and has a large garden to the front mainly laid to lawn with shrubs, plants and a large drive providing off road parking for several vehicles leading to a detached pitched roof garage. A particular feature of this wonderful property is the secluded and well stocked rear garden with fish pond, summer house, greenhouse, spacious lawned area, patio and a variety of well established plants, shrubs and trees. Further benefits include double glazing and gas central heating.

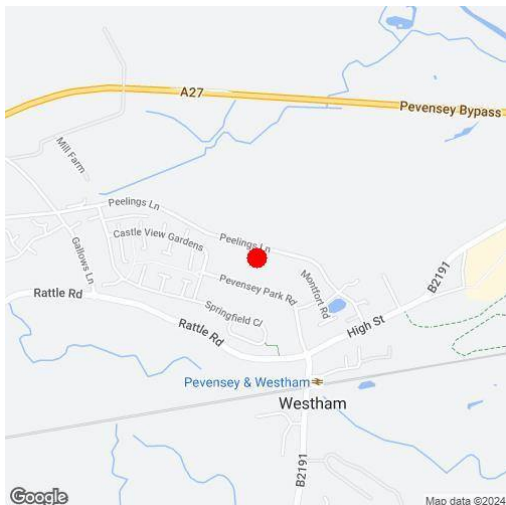



At a Glance:

- Three bedroom detached house
- Historic Westham village location
- Sitting room
- Large conservatory/family room
- Modern kitchen
- Large driveway and detached garage
- Modern ground floor bathroom
- Secluded well established gardens
- Countryside views
- Double glazing and gas central heating

Accommodation:

KITCHEN
10'4" (3.15m) x 6'8" (2.03m)

SITTING ROOM
13'3" (4.04m) x 10'2" (3.1m)

DINING ROOM
12'6" (3.81m) x 10'7" (3.23m)

CONSERVATORY
19'4" (5.89m) x 14'8" (4.47m)

DOWNSTAIRS BEDROOM 2
12'4" (3.76m) x 9'3" (2.82m)

BATHROOM

**STAIRS TO FIRST FLOOR
LANDING**

BEDROOM 1
14'7" (4.45m) x 10'0" (3.05m)

BEDROOM 3
11'5" (3.48m) x 9'5" (2.87m)

OUTSIDE:

FRONT & REAR GARDENS

**DRIVEWAY PARKING FOR
SEVERAL VEHICLES**

GARAGE

COUNCIL TAX:
Band "E"

EPC:
"D"



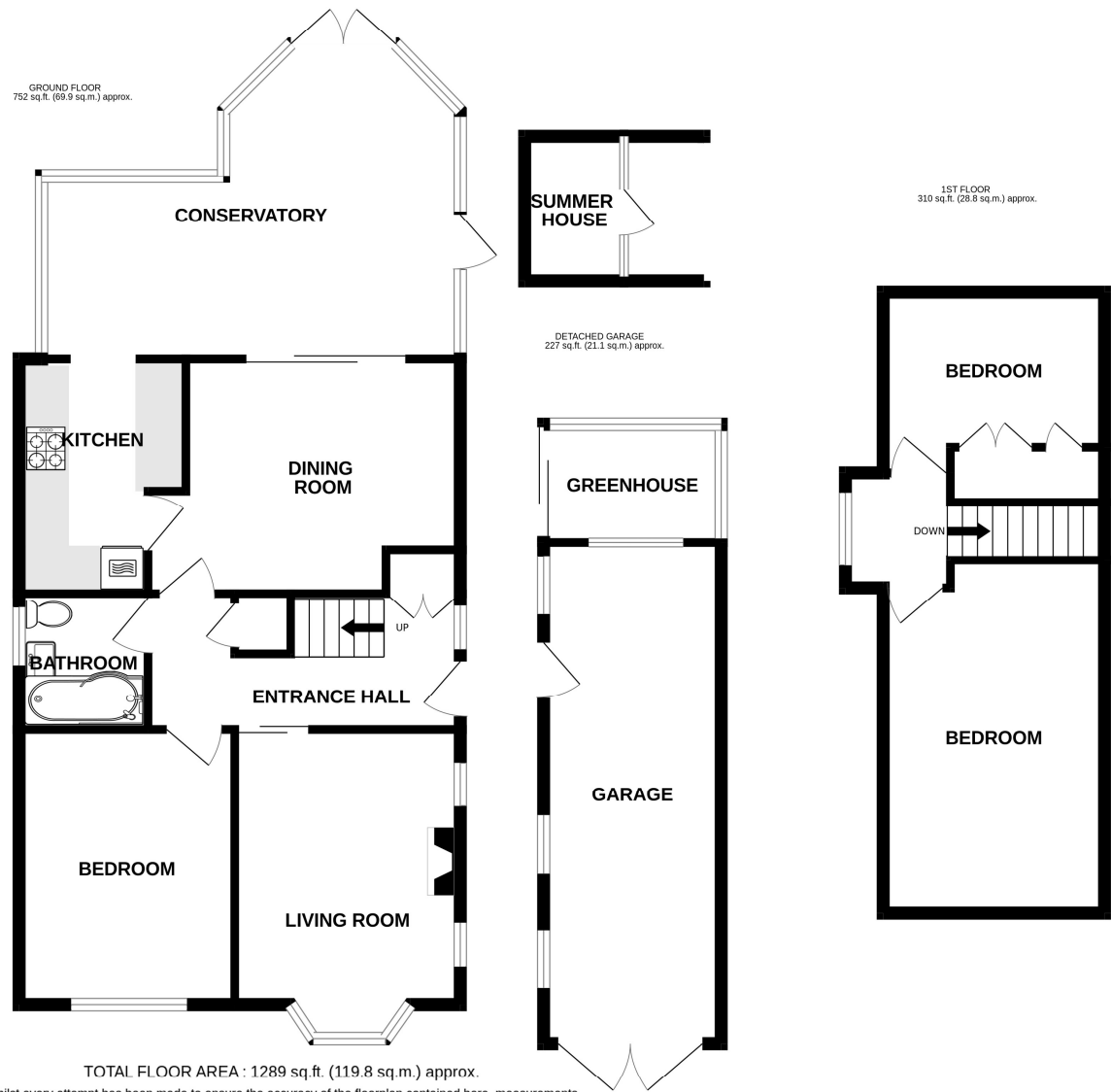

Whilst every attempt has been made to ensure the accuracy of the floorplan contained here, measurements of doors, windows, rooms and any other items are approximate and no responsibility is taken for any error, omission or mis-statement. This plan is for illustrative purposes only and should be used as such by any prospective purchaser. The services, systems and appliances shown have not been tested and no guarantee as to their operability or efficiency can be given.
Made with Metropix ©2024

Ref: 1

Whilst every care has been taken in the preparation of these particulars, neither the agents nor the vendor accept any responsibility for error or omission, nor do they constitute an offer or contract. Please note we have not tested any apparatus, fixtures, fittings, or services. Interested parties must undertake their own investigation into the working order of these items. All measurements are approximate whilst photographs and floorplans are provided for guidance only.



5 Gildredge Road, Eastbourne BN21 4RB
01323 416716

28 Meads Street, Eastbourne BN20 7QY
01323 737962

website
www.leaperstanbrook.co.uk

email
sales@leaperstanbrook.co.uk