



**T<sub>2</sub>m**

# 33 Shepley Court Aldrington Road £2,350 PCM



## Contact

02086400146

admin@time2move.com

www.time2move.com

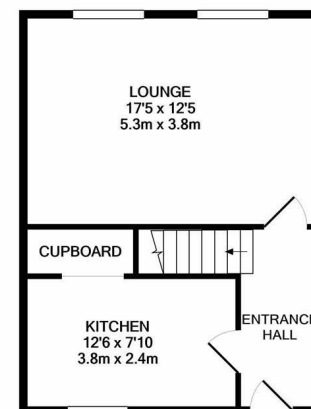

GROUND FLOOR  
APPROX. FLOOR  
AREA 404 SQ.FT.  
(37.5 SQ.M.)

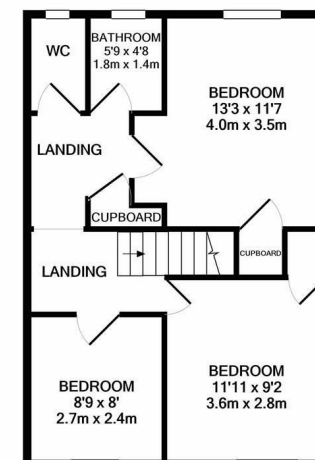

1ST FLOOR  
APPROX. FLOOR  
AREA 463 SQ.FT.  
(43.0 SQ.M.)

SHEPLEY COURT  
TOTAL APPROX. FLOOR AREA 867 SQ.FT. (80.5 SQ.M.)

Whilst every attempt has been made to ensure the accuracy of the floor plan contained here, measurements of doors, windows, rooms and any other items are approximate and no responsibility is taken for any error, omission, or mis-statement. This plan is for illustrative purposes only and should be used as such by any prospective purchaser. The services, systems and appliances shown have not been tested and no guarantee as to their operability or efficiency can be given.

Made with Metropix ©2021

Local Authority  
Wandsworth Borough Council

Council Tax Band C

EPC Rating C