



Wistow Lordship

Wistow, YO8 3RS

Offers In The Region Of £400,000

NO UPWARD CHAIN!

Unique opportunity to purchase a FOUR bedroom bungalow (plus an adjoining TWO bedroom bungalow is available by separate negotiation.)

This property is set in a beautiful rural location with superb gardens and orchard.

The property has UPVC double glazing throughout and oil central heating.

Viewing

Please contact us on 01757 709457 if you wish to arrange a viewing appointment for this property or require further information.

- Rare and Unique Property
- Link detached bungalow
- Adj. 2 bed bungalow also available by separate negotiation.
- No Upward Chain
- Open Farmland all Around
- Semi- Rural Location
- Oil Central Heating
- Double Garage
- Orchard and Generous garden
- VERY Spacious Internally



Floor Plan

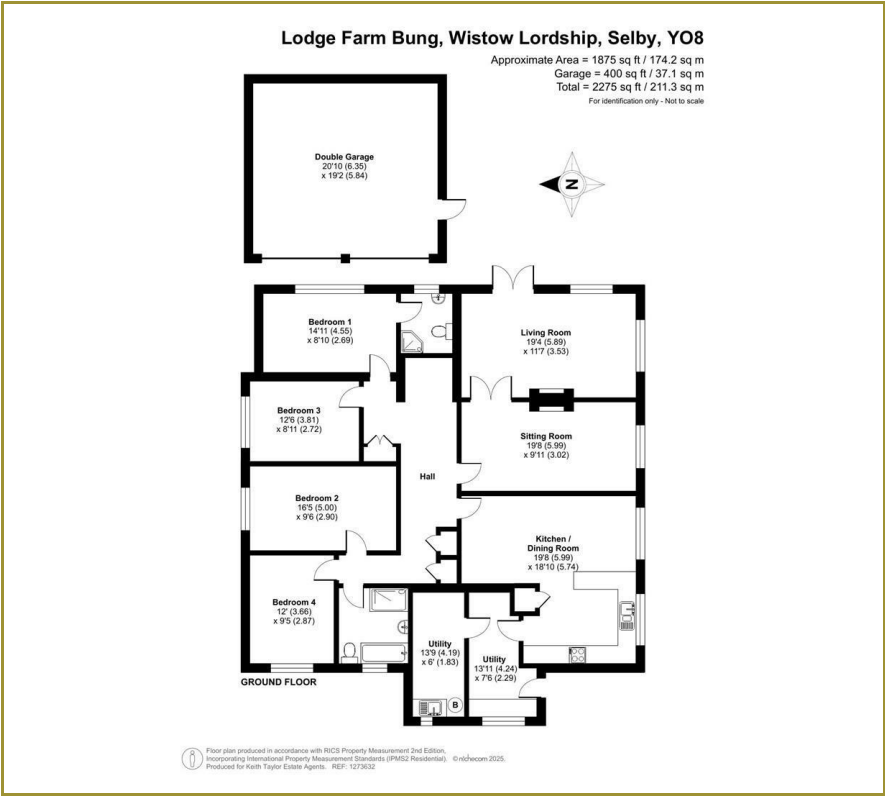

Area Map



Energy Efficiency Graph

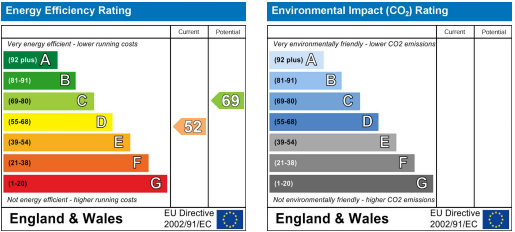

These particulars, whilst believed to be accurate are set out as a general outline only for guidance and do not constitute any part of an offer or contract. Intending purchasers should not rely on them as statements of representation of fact, but must satisfy themselves by inspection or otherwise as to their accuracy. No person in this firms employment has the authority to make or give any representation or warranty in respect of the property.

Keith Taylor

56 Gowthorpe, Selby, North Yorkshire, YO8 4ET
Tel: 01757 709457 Email: sales@keithtaylorproperty.co.uk
www.keithtaylorproperties.co.uk