



Stuart Grove

, Thorpe Willoughby, YO8 9NR

£350,000

Executive detached 4 bedroom family home in a peaceful cul-de-sac within this sought after village with garage and driveway parking for two cars.

- Executive Detached Family Home
- 4 Bedrooms
- Lounge with Dual Aspect - So Lovely and Light!
- Modern Kitchen with Fitted Appliances
- Separate Dining Room
- Modern Bathroom
- Ground Floor Cloaks/W.C
- Garden Room
- Garage
- Gas CH & Double Glazed

Viewing

Please contact us on 01757 709457 if you wish to arrange a viewing appointment for this property or require further information.



Floor Plan

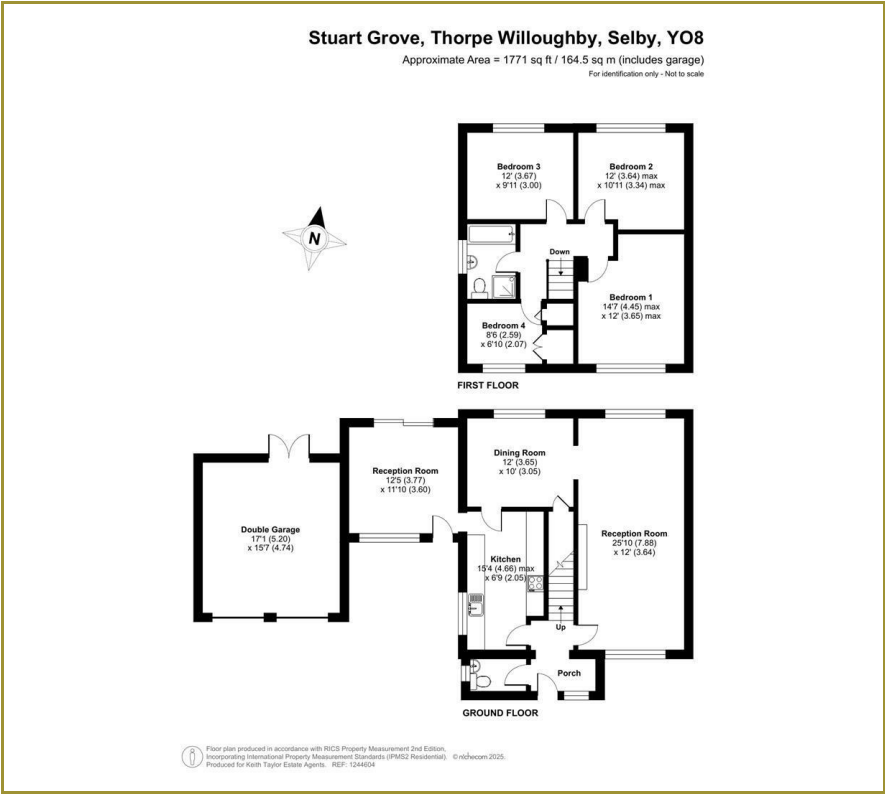

Area Map



Energy Efficiency Graph

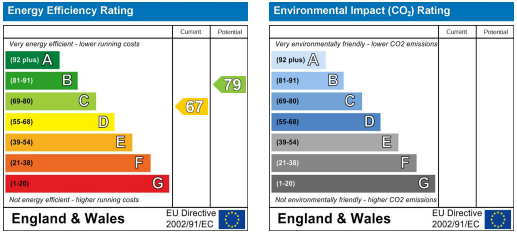

These particulars, whilst believed to be accurate are set out as a general outline only for guidance and do not constitute any part of an offer or contract. Intending purchasers should not rely on them as statements of representation of fact, but must satisfy themselves by inspection or otherwise as to their accuracy. No person in this firm's employment has the authority to make or give any representation or warranty in respect of the property.

Keith Taylor

56 Gowthorpe, Selby, North Yorkshire, YO8 4ET
Tel: 01757 709457 Email: sales@keithtaylorproperty.co.uk
www.keithtaylorproperties.co.uk