



St. George Close

Gateforth Park, YO8 9UG

£220,000

Two bed 'Majestic' Park home on a very generous plot with off road parking for 2 Vehicles.

Gateforth Park is an exclusive Park Home development located just outside Selby, next to Selby Golf Course for the over 50's with gated access to the community.

Lodge features include - log burner in the lounge, ensuite for bedroom 1, office, loft, shed with power and light, decking to one side, and fully re-carpeted throughout.

- Two bed 'Majestic' Park home
- Very generous plot
- Off road parking for 2 Vehicles
- Gateforth Park is an exclusive Park Home development
- Located just outside Selby, next to Selby Golf Course
- For the over 50's
- Gated access to the community
- Log burner in the lounge
- Ensuite to bedroom 1
- Office, loft, shed

Viewing

Please contact us on 01757 709457 if you wish to arrange a viewing appointment for this property or require further information.

Floor Plan

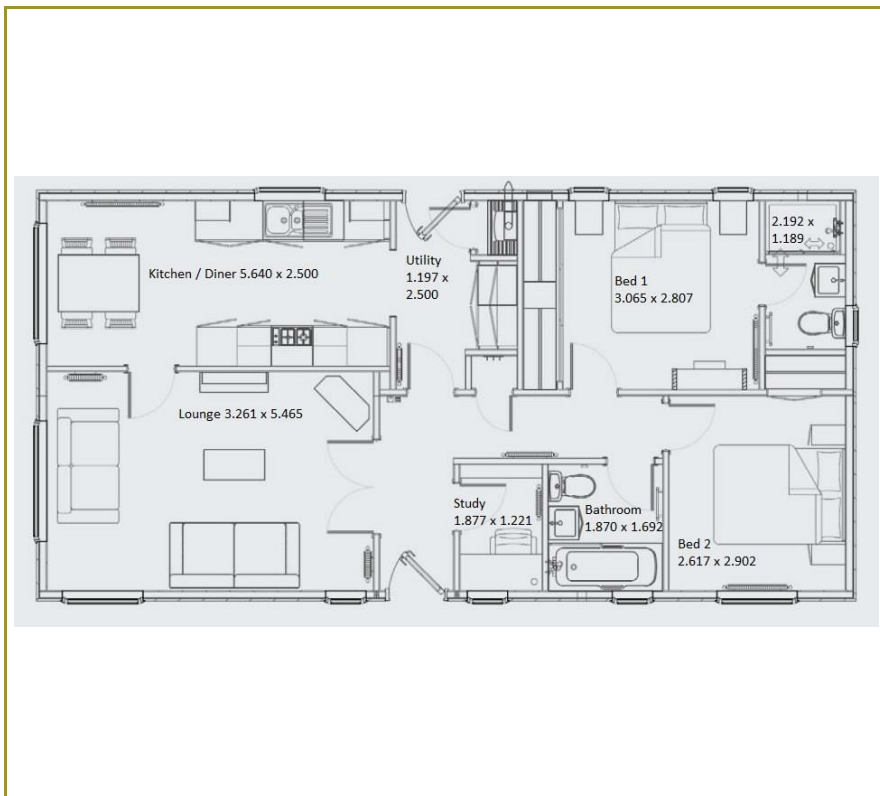

Area Map



These particulars, whilst believed to be accurate are set out as a general outline only for guidance and do not constitute any part of an offer or contract. Intending purchasers should not rely on them as statements of representation of fact, but must satisfy themselves by inspection or otherwise as to their accuracy. No person in this firm's employment has the authority to make or give any representation or warranty in respect of the property.

Keith Taylor

56 Gowthorpe, Selby, North Yorkshire, YO8 4ET
Tel: 01757 709457 Email: sales@keithtaylorproperty.co.uk
www.keithtaylorproperties.co.uk