



Somerset Road, Pensby, Wirral CH61 8ST

- Traditional Three Bedroom Semi Detached Property
- Good Sized Plot in the Prime Location of Pensby
- Hall, W.C, Lounge, Dining Room, Kitchen and Utility
- Ample Off Road Parking and an Oversized Garage
- Offered to the Sales Market with No Onward Chain
- Well Appointed Spanning Over 1300 Square Foot
- Two Double Bedrooms, Third Bedroom and Shower Room
- Generous Private Enclosed Rear Garden - Viewing Essential



Offers Over £240,000













Description

Offered to the sales market with no onward chain, Move Residential are delighted to showcase this impressive three bedroom semi detached property. Occupying a generous sized, south facing plot in the prime location of Pensby within easy reach of amenities, transport links and excellent schools for all age groups.

Spanning over 1,300 square foot of living space appointed with a fresh and tasteful décor which must be viewed to be appreciated in full. In brief you have a porch, W.C and entrance hallway. Front dining room with double doors opening to a rear lounge with feature fireplace, completing the ground floor you have a modern fitted kitchen and a useful utility room. To the first floor you have two double bedrooms, third bedroom and modern shower room with steam cabin shower. Further benefiting from ample off road parking, oversized garage and large enclosed south facing rear garden, beautifully manicured with patio and lawned areas.

EPC Summary

Score	Energy rating	Current	Potential
92+	A		
81-91	B		83 B
69-80	C	71 C	
55-68	D		
39-54	E		
21-38	F		
1-20	G		

Additional Information

These particulars are thought to be materially correct though their accuracy is not guaranteed and they do not form part of any contract. All measurements are approximate and we have not tested any fitted appliances, electrical or plumbing installation or central heating systems. Floor plans are for illustration purposes only and their accuracy is not guaranteed.

Floor Plan

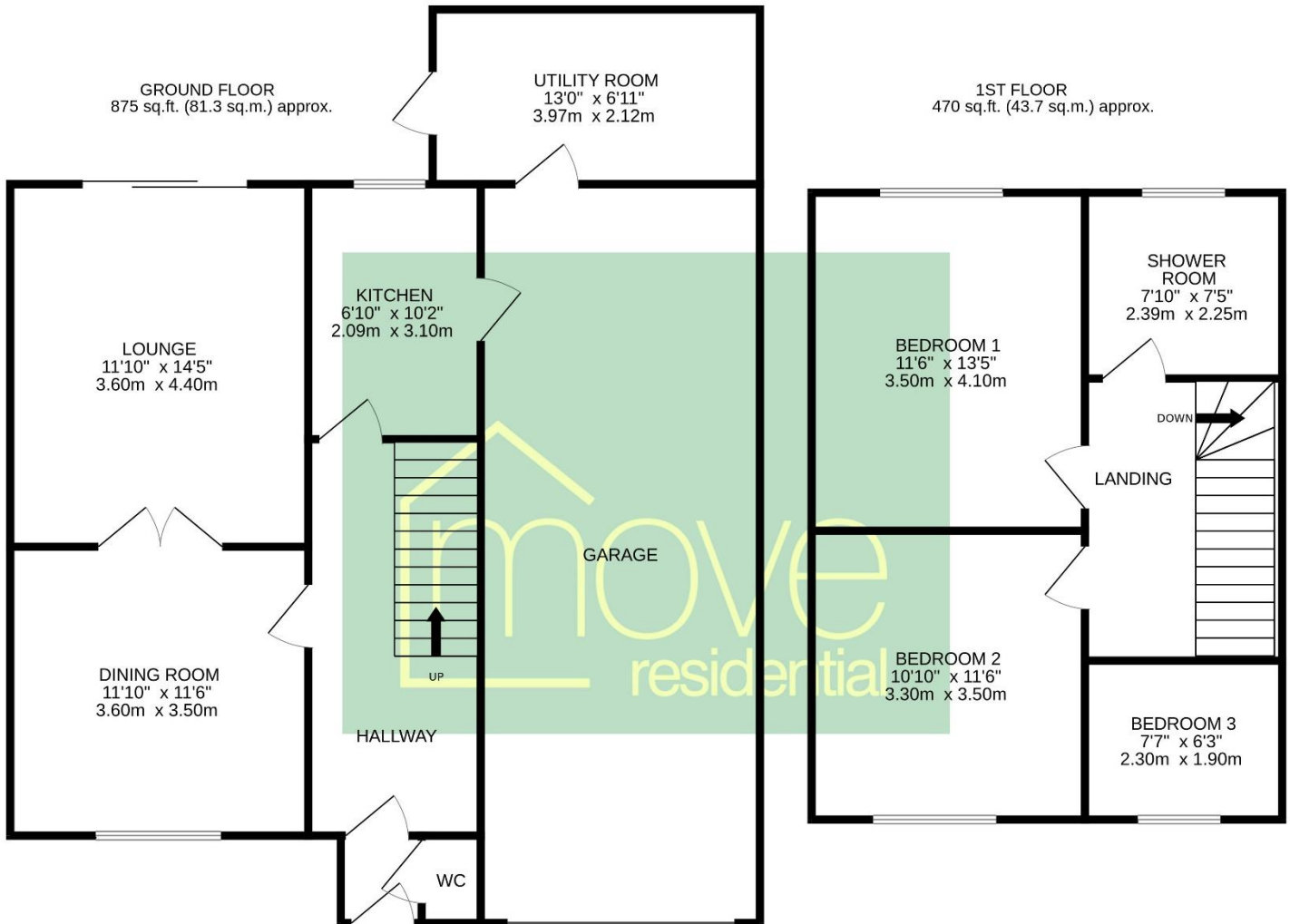

TOTAL FLOOR AREA : 1345 sq.ft. (125.0 sq.m.) approx.

Whilst every attempt has been made to ensure the accuracy of the floorplan contained here, measurements of doors, windows, rooms and any other items are approximate and no responsibility is taken for any error, omission or mis-statement. This plan is for illustrative purposes only and should be used as such by any prospective purchaser. The services, systems and appliances shown have not been tested and no guarantee as to their operability or efficiency can be given.

Made with Metropix ©2025