



Thingwall Road East, Irby, Wirral CH61 3UY

- Traditional Two Double Bedroom Detached Bungalow
- Porch, Hallway, Spacious Lounge Diner and Fitted Kitchen
- Two Double Bedrooms and a Newly Installed Shower Room
- Large Enclosed Rear Garden Paved for Ease of Maintenance
- Impressive Accommodation Appointed with a Neutral Decor
- Good Sized Conservatory with a New Solid Roof Fitted
- In Out Driveway Providing Parking and a Garage/Store
- Prime Location of Irby Close to Amenities and Transport Links



£359,995



















Floor Plan

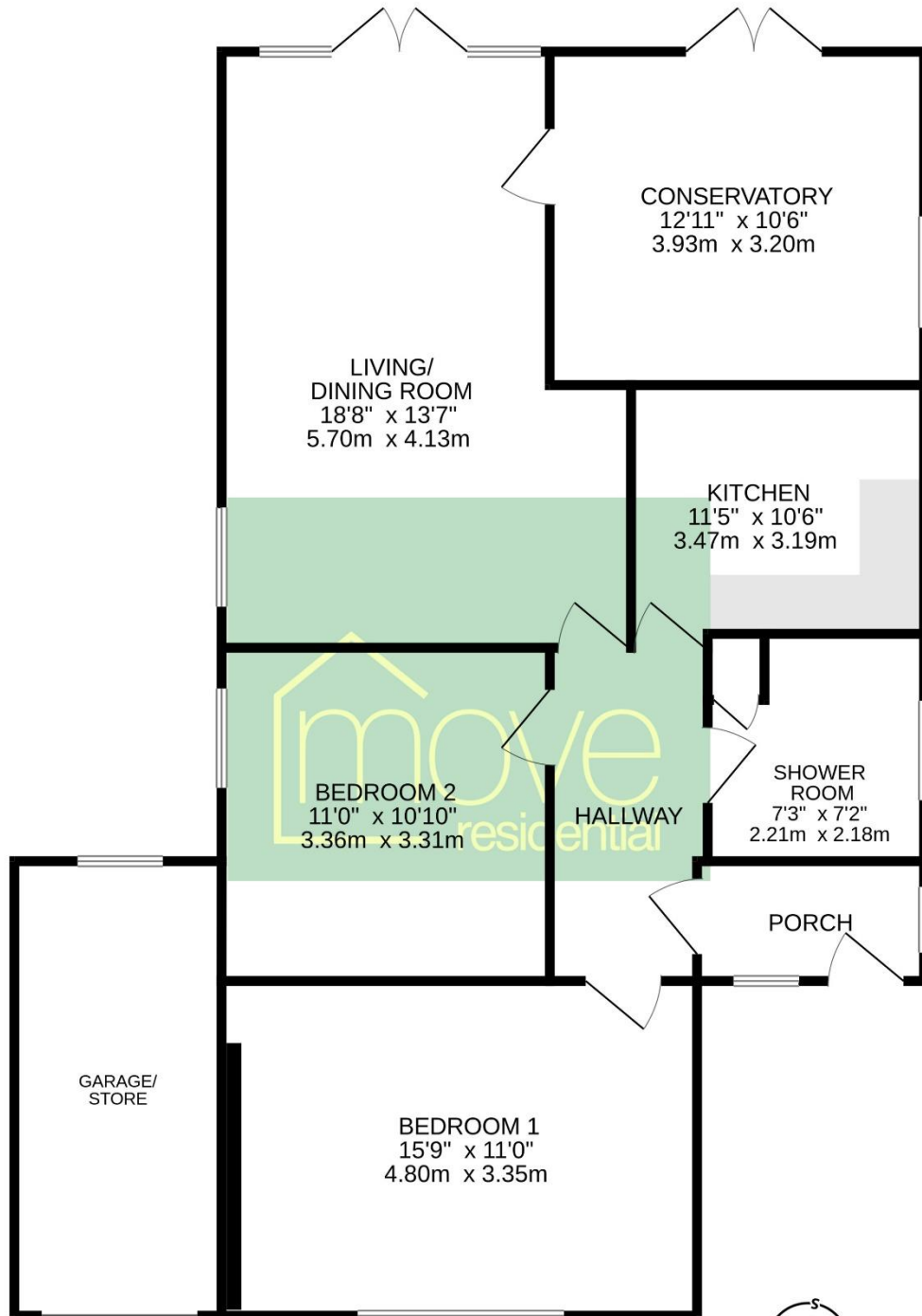

TOTAL FLOOR AREA : 987 sq.ft. (91.7 sq.m.) approx.

Whilst every attempt has been made to ensure the accuracy of the floorplan contained here, measurements of doors, windows, rooms and any other items are approximate and no responsibility is taken for any error, omission or mis-statement. This plan is for illustrative purposes only and should be used as such by any prospective purchaser. The services, systems and appliances shown have not been tested and no guarantee as to their operability or efficiency can be given.

Made with Metropix ©2024

Description

New to the sales market, Move Residential are delighted to present this impressive two double bedroom detached bungalow located in the highly sought after area of Irby. Well maintained and appointed with a neutral décor, in brief you have a hallway, spacious lounge diner, conservatory with new solid roof and a well fitted kitchen. Two double bedrooms and a newly fitted shower room. Further benefiting from off road parking with two entrances, garage and a private enclosed rear garden which has been paved for ease of maintenance.

EPC Summary

Score	Energy rating	Current	Potential
92+	A		
81-91	B		86 B
69-80	C	72 C	
55-68	D		
39-54	E		
21-38	F		
1-20	G		

Additional Information

These particulars are thought to be materially correct though their accuracy is not guaranteed and they do not form part of any contract. All measurements are approximate and we have not tested any fitted appliances, electrical or plumbing installation or central heating systems. Floor plans are for illustration purposes only and their accuracy is not guaranteed.