



Grove Road, Wirral, Merseyside, CH47 2DS

- Recently Updated Four Bedroom Mid Terrace Property
- Neutrally Decorated and Appointed Throughout
- Three Double Bedrooms, Bedroom Four and New Bathroom
- Within Walking Distance to Amenities & Transport Links
- Located In Popular Residential Area of Hoylake
- Hallway, Two Reception Rooms and Kitchen Diner
- South Facing and Enclosed Low Maintenance Rear Yard
- Early Viewing is Essential to Avoid Missing Out



£285,000

















Description

Move Residential are delighted to be the agent of choice to offer for sale this recently updated four bedroom mid terrace. Located in the popular residential area of Hoylake, within walking distance of amenities, transport links and highly regarded schools. Neutrally appointed throughout the current owners have modernised the property tastefully keeping many original features. Internally the accommodation comprises an entrance hallway, two generously proportioned reception rooms and a kitchen diner. To the first floor are three double bedrooms, bedroom four and a brand new bathroom. Externally offering a low maintenance south facing rear yard. As appointed agents we strongly recommend a viewing, as this one is not to be missed!

EPC Summary

| Score | Energy rating | Current | Potential |
|-------|---------------|---------|-----------|
| 92+ | A | | |
| 81-91 | B | | 83 B |
| 69-80 | C | | |
| 55-68 | D | 66 D | |
| 39-54 | E | | |
| 21-38 | F | | |
| 1-20 | G | | |

Additional Information

These particulars are thought to be materially correct though their accuracy is not guaranteed and they do not form part of any contract. All measurements are approximate and we have not tested any fitted appliances, electrical or plumbing installation or central heating systems. Floor plans are for illustration purposes only and their accuracy is not guaranteed.

GROUND FLOOR

1ST FLOOR

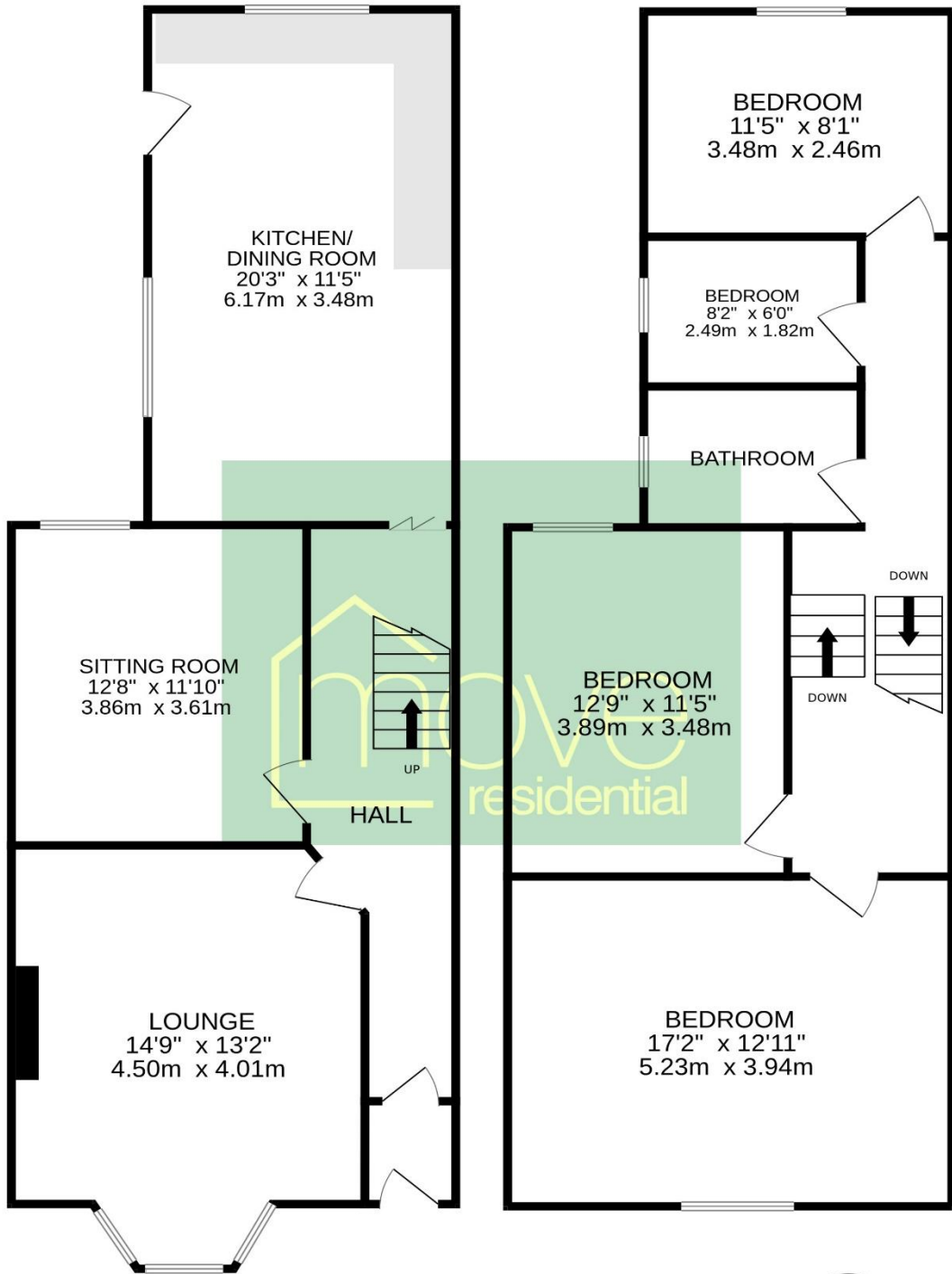

TOTAL FLOOR AREA : 1394sq.ft. (129.5 sq.m.) approx.

Whilst every attempt has been made to ensure the accuracy of the floorplan contained here, measurements of doors, windows, rooms and any other items are approximate and no responsibility is taken for any error, omission or mis-statement. This plan is for illustrative purposes only and should be used as such by any prospective purchaser. The services, systems and appliances shown have not been tested and no guarantee as to their operability or efficiency can be given.

Made with Metropix ©2024

