



Walsingham Road, Wallasey, Wirral CH44 9DX

- Traditional Three Bedroom Mid Terraced Property
- Vestibule, Hallway and Good Sized Bay Fronted Lounge
- Three Good Sized Bedrooms and Three Piece Bathroom
- Walking Distance to Amenities and Transport Links
- Offered to the Sales Market with No Onward Chain
- Modern Kitchen Diner with Patio Doors to Courtyard
- Situated in the Popular Residential Area of Wallasey
- Closer Inspection Strongly Recommended



Offers Over £125,000 – No Onward Chain









Description

Offered for sale with no onward chain, Move Residential are delighted to present this traditional three bedroom mid terraced property. In need of some modernising, the property briefly comprises a hallway, bay fronted lounge and rear kitchen diner with modern fitted kitchen and patio doors leading to the rear garden. To the first floor you have three good sized bedrooms and a three piece bathroom. Further benefiting from a large enclosed courtyard garden with access gate. Wallasey is a ever popular area with excellent shops and amenities within easy reach along with commuting links throughout Wirral and Liverpool. A closer inspection is strongly recommended.

Floor Plan

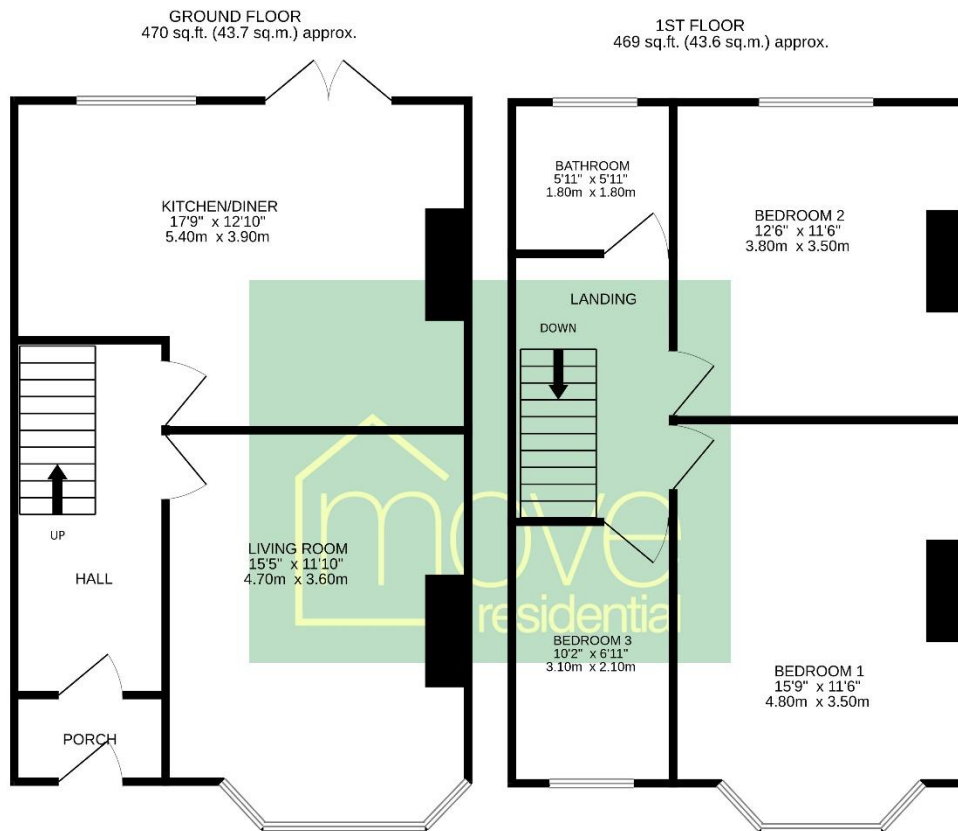

TOTAL FLOOR AREA : 939 sq.ft. (87.3 sq.m.) approx.

Whilst every attempt has been made to ensure the accuracy of the floorplan contained here, measurements of doors, windows, rooms and any other items are approximate and no responsibility is taken for any error, omission or mis-statement. This plan is for illustrative purposes only and should be used as such by any prospective purchaser. The services, systems and appliances shown have not been tested and no guarantee as to their operability or efficiency can be given.

Made with Metroplan ©2024

EPC Summary

Score	Energy rating	Current	Potential
92+	A		
81-91	B		88 B
69-80	C		
55-68	D	68 D	
39-54	E		
21-38	F		
1-20	G		

Additional Information

These particulars are thought to be materially correct though their accuracy is not guaranteed and they do not form part of any contract. All measurements are approximate and we have not tested any fitted appliances, electrical or plumbing installation or central heating systems. Floor plans are for illustration purposes only and their accuracy is not guaranteed.