



Downham Road South, Heswall, Wirral CH60 5RG

- Spacious Three Double Bedroom First Floor Apartment
- Recently Updated Throughout to a High Standard
- Dining Area, Kitchen, Hallway and Lounge Diner
- Benefitting from Double Glazing and Gas Central Heating
- Benefiting from Being Sold with No Onward Chain
- Presented with a Fresh and Neutral Decor
- Three Double Bedrooms and a Modern Bathroom
- Set in the Heart of Heswall Village - Viewing Essential



£140,000







Description

Situated in the heart of Heswall Village, Move Residential are delighted to present to the sales market with no onward chain this impressive three double bedroom first floor apartment. Recently renovated throughout to a high standard, presented with a fresh and neutral decor this spacious accommodation briefly comprises a dining area and modern fitted kitchen. Inner hallway leading to a generous sized lounge diner, three double bedrooms and a newly fitted three piece bathroom. A closer inspection is strongly recommended to appreciate this home in full.

Hallway - 8' 6" x 5' 11" (2.6m x 1.8m)

Dining Area - 6' 3" x 11' 6" (1.9m x 3.5m)

Lounge Diner - 11' 10" x 22' 4" (3.6m x 6.8m)

Kitchen - 5' 11" x 8' 10" (1.8m x 2.7m)

Bedroom One - 11' 10" x 11' 10" (3.6m x 3.6m)

Bedroom Two - 12' 2" x 9' 10" (3.7m x 3.0m)

Bedroom Three - 8' 6" x 15' 5" (2.6m x 4.7m)

Bathroom - 4' 7" x 9' 2" (1.4m x 2.8m)

Floor Plan

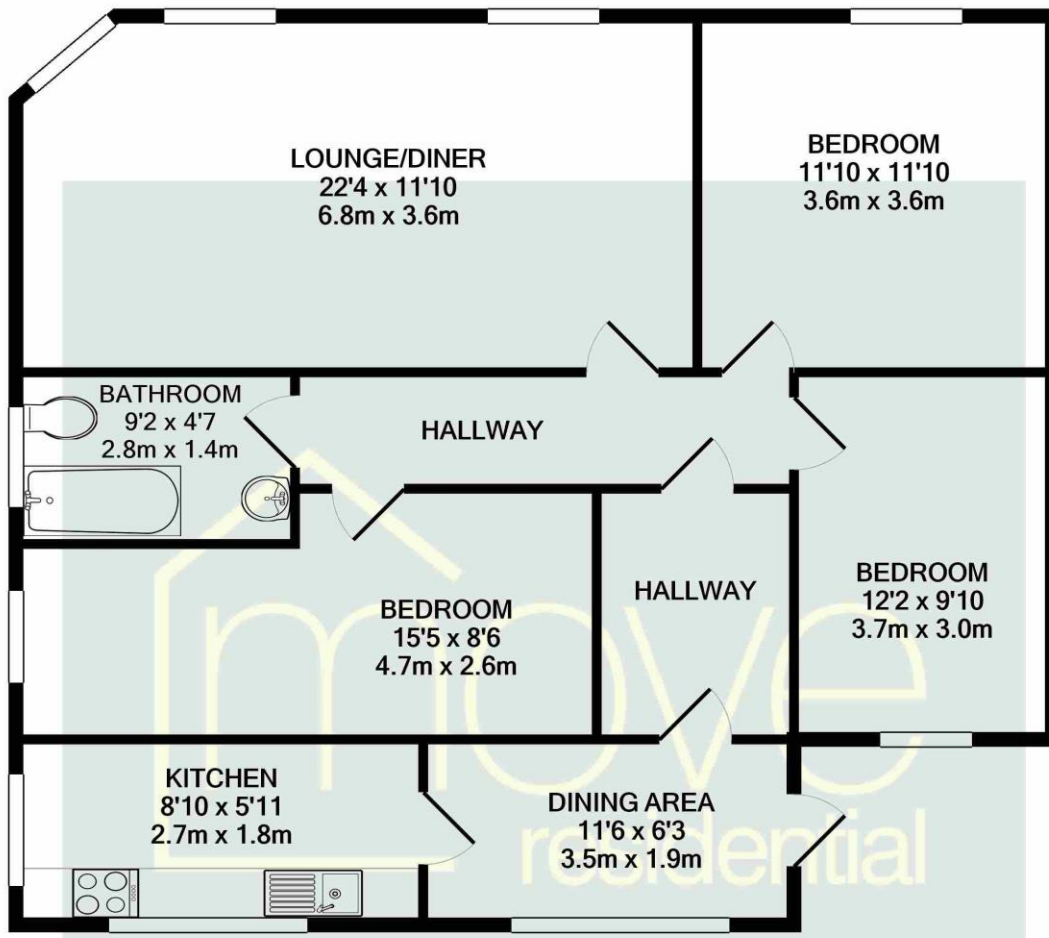

TOTAL APPROX. FLOOR AREA 984 SQ.FT. (91.4 SQ.M.)

Whilst every attempt has been made to ensure the accuracy of the floor plan contained here, measurements of doors, windows, rooms and any other items are approximate and no responsibility is taken for any error, omission, or mis-statement. This plan is for illustrative purposes only and should be used as such by any prospective purchaser. The services, systems and appliances shown have not been tested and no guarantee as to their operability or efficiency can be given
Made with Metropix ©2021

Additional Information

These particulars are thought to be materially correct though their accuracy is not guaranteed and they do not form part of any contract. All measurements are approximate and we have not tested any fitted appliances, electrical or plumbing installation or central heating systems. Floor plans are for illustration purposes only and their accuracy is not guaranteed.