



## Ridgefield Road, Pensby, Wirral CH61 8RT

- Attractive Two Bedroom Semi Detached Bungalow
- Well Appointed and Maintained Living Accommodation
- Two Good Sized Double Bedrooms and a Wet Room
- Generous Enclosed Rear Garden with Patio and Lawn
- Offered to the Sales Market with No Onward Chain
- Hallway, Lounge, Conservatory and Fitted Kitchen
- Ample Off Road Parking and a Detached Garage
- Situated Close to Amenities and Transport Links



£190,000















GROUND FLOOR  
688 sq.ft. (64.0 sq.m.) approx.

Floor Plan

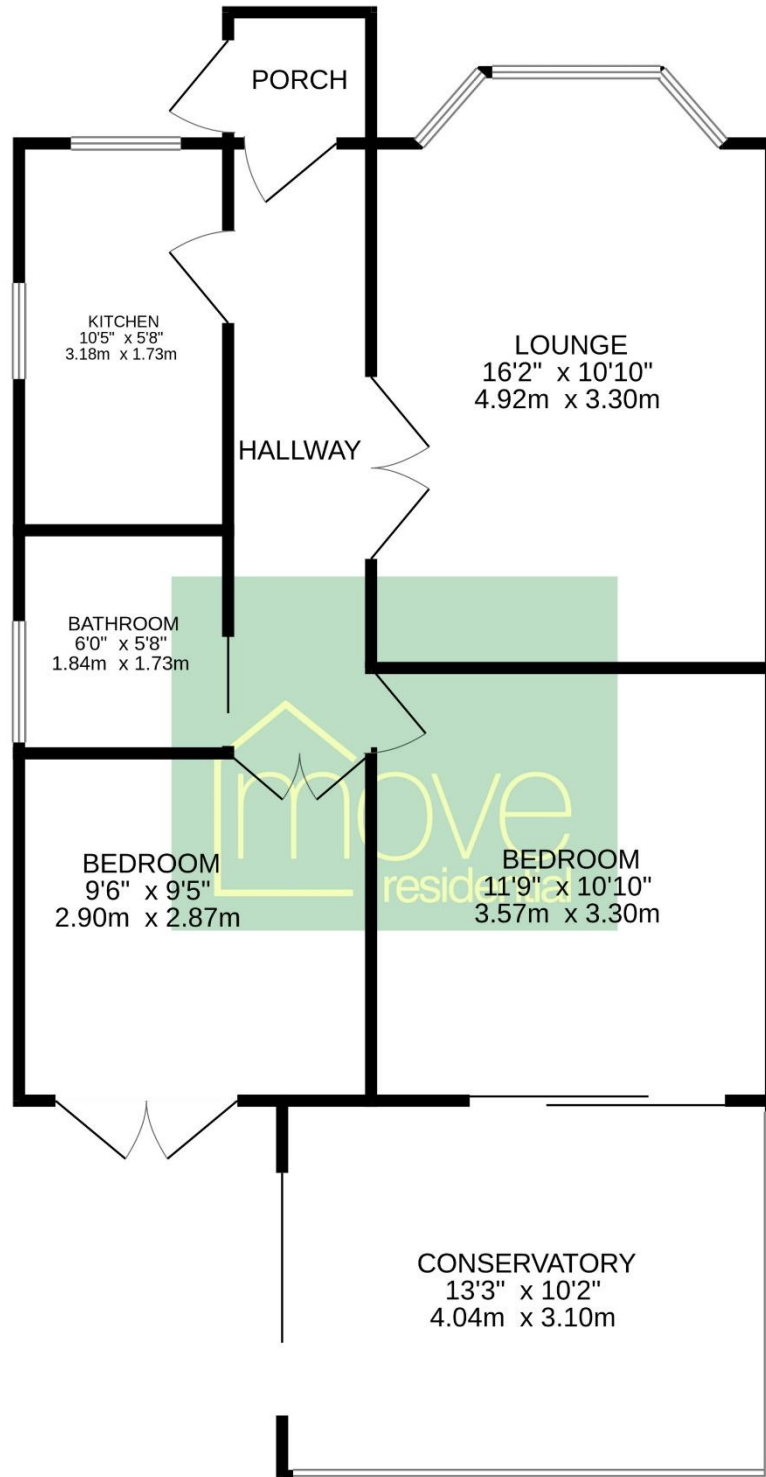

TOTAL FLOOR AREA : 688 sq.ft. (64.0 sq.m.) approx.

Whilst every attempt has been made to ensure the accuracy of the floorplan contained here, measurements of doors, windows, rooms and any other items are approximate and no responsibility is taken for any error, omission or mis-statement. This plan is for illustrative purposes only and should be used as such by any prospective purchaser. The services, systems and appliances shown have not been tested and no guarantee as to their operability or efficiency can be given.

Made with Metropix ©2023

## Description

Offered to the sales market with no onward chain, Move Residential are delighted to showcase this attractive two double bedroom semi detached bungalow. Occupying a generous sized plot in the prime location of Pensby set within easy reach of amenities and transport links. Well appointed and maintained this superb accommodation briefly comprises a porch, hallway and a bay fronted lounge with feature fireplace. Well fitted kitchen, two sizeable double bedrooms one with a conservatory off and a wet room. Further benefiting from ample off road parking, detached garage and a generous enclosed rear garden beautifully manicured with lawned and patio areas. A closer inspection is strongly recommended to appreciate this home in full.

## EPC Summary

Score	Energy rating	Current	Potential
92+	A		
81-91	B		89 B
69-80	C	72 C	
55-68	D		
39-54	E		
21-38	F		
1-20	G		

## Additional Information

These particulars are thought to be materially correct though their accuracy is not guaranteed and they do not form part of any contract. All measurements are approximate and we have not tested any fitted appliances, electrical or plumbing installation or central heating systems. Floor plans are for illustration purposes only and their accuracy is not guaranteed.