



Thorburn Road, New Ferry, Wirral CH62 1EW

- Spacious Two Double Bedroom First Floor Apartment
- Hallway, Open Plan Lounge Diner and Fitted Kitchen
- Allocated Parking and Lovely Communal Lawned Gardens
- Situated within Easy Reach of Amenities and Transport Links
- Modern Accommodation Offered for Sale with No Chain
- Two Double Bedrooms, En Suite Shower Room and Bathroom
- Located in the Popular Residential Area of New Ferry
- Closer Inspection Strongly Recommended



£100,000 – No Onward Chain





Description

Modern and spacious two double bedroom first floor apartment is offered for sale with no onward chain. Situated in the popular residential area of New Ferry within easy reach of amenities and transport links. In brief you have a hallway, open plan lounge diner with archway into a well fitted kitchen. Master Bedroom with en suite shower room, second double bedroom and a bathroom. Further benefiting from allocated parking, communal lawned gardens, double glazing and heating. A closer inspection is strongly recommended.

Additional Information:

Service Charge: £150 Per Month

Ground Rent: £100 Per Annum

Floor Plan

FIRST FLOOR
824 sq.ft. (76.5 sq.m.) approx.

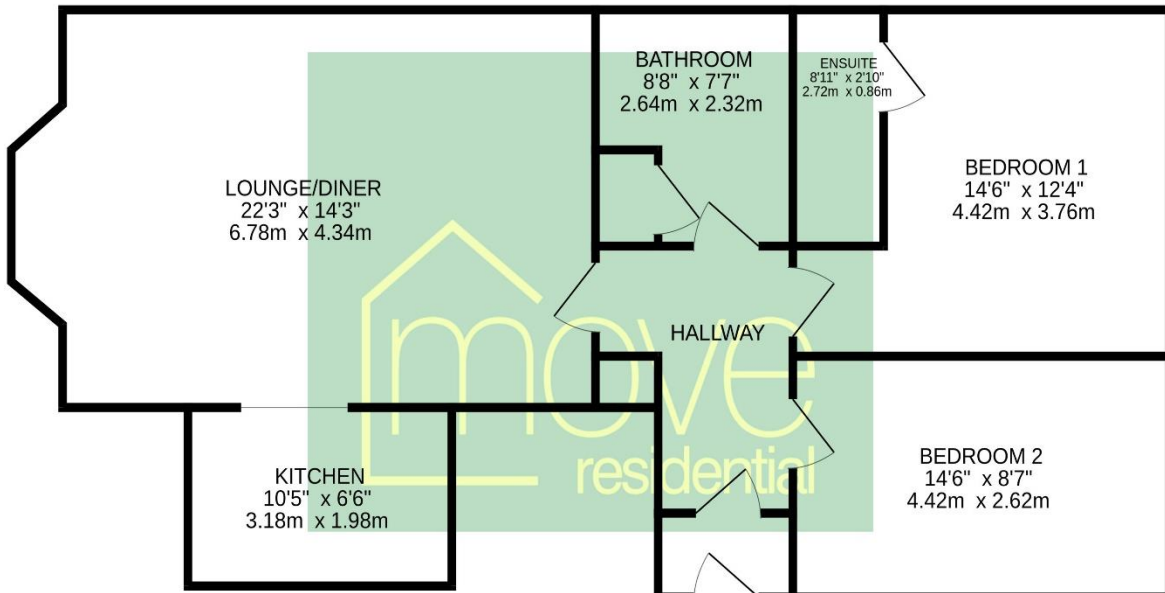

TOTAL FLOOR AREA : 824 sq.ft. (76.5 sq.m.) approx.

Whilst every attempt has been made to ensure the accuracy of the floorplan contained here, measurements of doors, windows, rooms and any other items are approximate and no responsibility is taken for any error, omission or mis-statement. This plan is for illustrative purposes only and should be used as such by any prospective purchaser. The services, systems and appliances shown have not been tested and no guarantee as to their operability or efficiency can be given.

Made with Metropix ©2023

EPC Summary

Score	Energy rating	Current	Potential
92+	A		
81-91	B		83 B
69-80	C	80 C	
55-68	D		
39-54	E		
21-38	F		
1-20	G		

Additional Information

These particulars are thought to be materially correct though their accuracy is not guaranteed and they do not form part of any contract. All measurements are approximate and we have not tested any fitted appliances, electrical or plumbing installation or central heating systems. Floor plans are for illustration purposes only and their accuracy is not guaranteed.