



Portsmouth Road, , Leicester, LE2 3RB

- Executive style family Residence
- Five Bedroom Detached Home
- Dining room and separate Sitting room
- fitted Kitchen
- Generous garden and patio terrace
- Sought after location
- Lounge
- Open to Consider realistic offers
- Family bathroom, en-suite shower room and downstairs wc
- Offered to market with No Upward Chain

Offers In The Region Of £660,000



Portsdown Road, , Leicester, LE2 3RB

DESCRIPTION

Nestled on the charming cul-de-sac within the leafy suburbs of Leicester, this exquisite detached house offers a perfect blend of space, comfort, and elegance. With five generously sized bedrooms, this property is ideal for families seeking a spacious home. The three reception rooms provide ample space for relaxation and entertainment, making it easy to host gatherings or enjoy quiet evenings with loved ones.

The two well-appointed bathrooms and a downstairs wc ensuring convenience for all residents, while the stunning southerly facing garden is a true highlight of the property. This outdoor oasis features a delightful patio seating area, perfect for enjoying sunny afternoons or hosting al fresco dining experiences. The garden is not only a beautiful space but also offers a sense of tranquillity, making it an ideal retreat from the hustle and bustle of daily life.

Additionally, the property features a single garage with block paved driveway adding to the convenience of this stunning home. This property is situated in a desirable location, offering a friendly community feel while being close to local amenities, schools, and parks, making it a perfect choice for families and professionals alike.

In summary, this remarkable detached house on Portsdown Road is a superb find, combining spacious living areas, a stunning garden, and practical parking solutions. It presents an excellent opportunity for anyone looking to settle in a welcoming community in Leicester.

The vendors are open to genuine offers being made on the property and will consider the figure and position of a potential buyer. Being offered to market with no upward chain, don't miss the chance to make this beautiful property your new home.

To find out more, contact your local Hunters estate agents Wigston to arrange your accompanied viewing.





Approx Gross Internal Area
181 sq m / 1949 sq ft

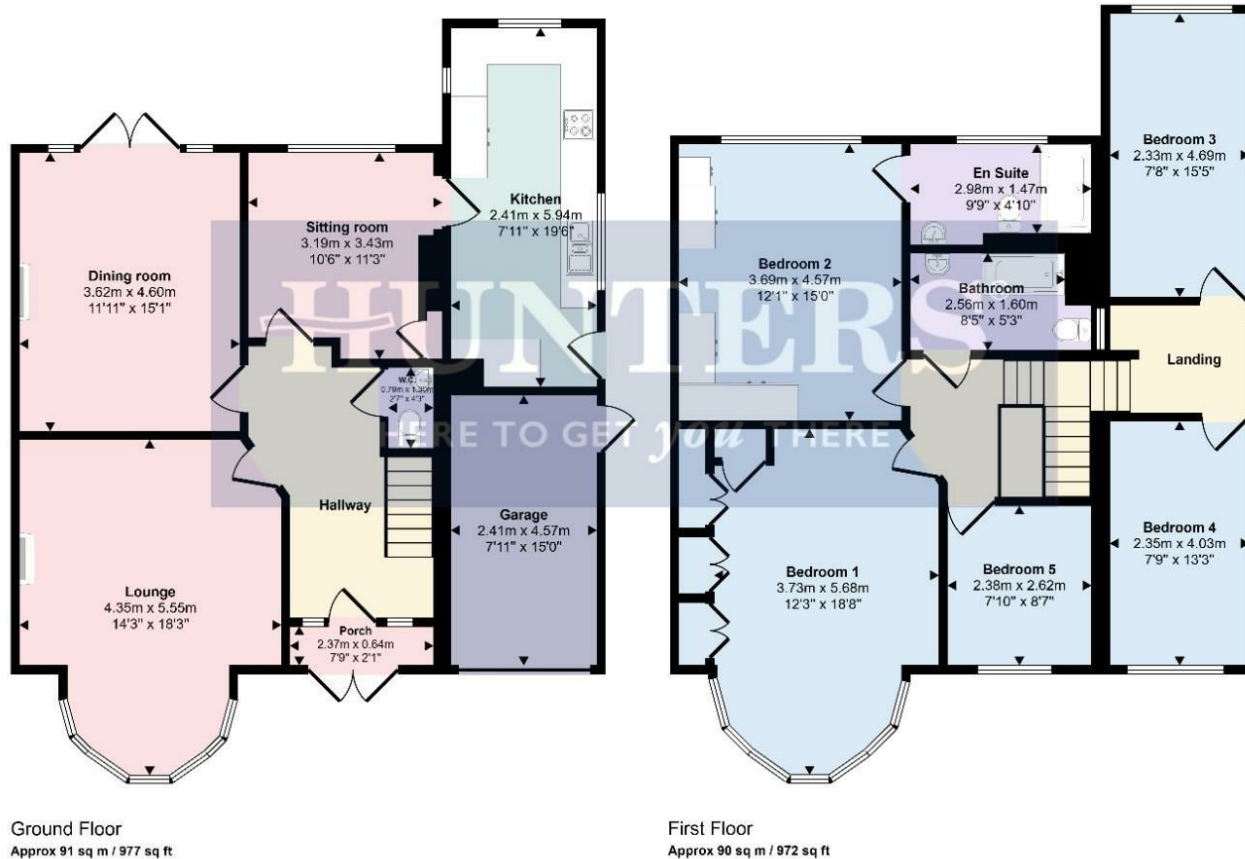

This floorplan is only for illustrative purposes and is not to scale. Measurements of rooms, doors, windows, and any items are approximate and no responsibility is taken for any error, omission or mis-statement. Icons of items such as bathroom suites are representations only and may not look like the real items. Made with Made Snappy 360.

Viewings

Please contact wigston@hunters.com, if you wish to arrange a viewing appointment for this property or require further information.

Valuations

For a valuation of your property, please email the team with your property details, contact information and the times you are available.

ENERGY PERFORMANCE CERTIFICATE

The energy efficiency rating is a measure of the overall efficacy of a home. The higher the rating the more energy efficient the home is and the lower the fuel bills will be.

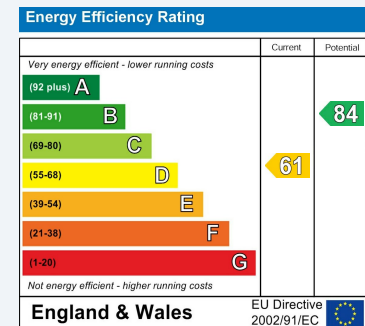

These particulars are intended to give a fair and reliable description of the property but no responsibility for any inaccuracy or error can be accepted and do not constitute an offer or contract. We have not tested any services or appliances (including central heating if fitted) referred to in these particulars and the purchasers are advised to satisfy themselves as to the working order and condition. If a property is unoccupied at any time there may be reconnection charges for any switched off/disconnected or drained services or appliances - All measurements are approximate.

THINKING OF SELLING? If you are thinking of selling your home or just curious to discover the value of your property, Hunters would be pleased to provide free, no obligation sales and marketing advice. Even if your home is outside the area covered by our local offices we can arrange a Market Appraisal through our national network of Hunters estate agents.